

LEGEND

- PROPOSED LAMP STANDARD
- UP PROPOSED UTILITY POLE
- HP PROPOSED HYDRO POLE
- ▲ SIGN PROPOSED SIGN
- PH HYDRO TRANSFORMER PROPOSED HYDRO TRANSFORMER
- CB PROPOSED CATCHBASIN
- DCB PROPOSED DOUBLE CATCHBASIN
- DICB PROPOSED DITCH INLET CATCHBASIN
- DICB(A) PROPOSED DITCH INLET CATCHBASIN (TYPE A)
- DICB(B) PROPOSED DITCH INLET CATCHBASIN (TYPE B)
- CBMH PROPOSED CATCHBASIN MANHOLE
- DCBMH PROPOSED DOUBLE CATCHBASIN MANHOLE
- DICBMH(A) PROPOSED DITCH INLET CATCHBASIN MANHOLE (TYPE A)
- DICBMH(B) PROPOSED DITCH INLET CATCHBASIN MANHOLE (TYPE B)
- MH PROPOSED STORM MANHOLE
- MH1 PROPOSED SANITARY MANHOLE
- HYD PROPOSED FIRE HYDRANT
- WV PROPOSED WATERMAIN VALVE
- CS PROPOSED CURB STOP
- REDUCER PROPOSED REDUCER
- PROPOSED FIRE DEPARTMENT CONNECTION
- [123.45] PROPOSED GRADE
- 2.0% 2.0% PROPOSED DRAINAGE ARROWSLOPE
- PROPOSED SWALE
- PROPOSED SWALE WITH SUBDRAIN
- ← PROPOSED OVERLAND FLOW ROUTE
- ▬ PROPOSED EMBANKMENT (3:1 MAX UNLESS OTHERWISE NOTED)
- ▬ PROPOSED SANITARY SEWER/SERVICE
- ▬ PROPOSED STORM SEWER/SERVICE
- ▬ PROPOSED WATERMAIN/SERVICE
- ▬ PROPOSED GASMAIN
- ▬ PROPOSED UNDERGROUND HYDRO LINE
- ▬ PROPOSED SUBDRAIN
- ▬ PROPOSED PIPE INSULATION
- ▬ PROPOSED GUARDRAIL
- ▬ PROPOSED CHAINLINK FENCE
- ▬ PROPOSED BOARD FENCE
- ▬ PROPOSED (LIGHT DUTY) SILT FENCE
- ▬ PROPOSED CURB
- ▬ PROPOSED CURB AND GUTTER
- ▬ PROPOSED DROP CURB
- ▬ PROPOSED DROP CURB AND GUTTER
- PROPOSED HEAVY DUTY ASPHALT SURFACE REFER TO LANDSCAPE DRAWINGS
- PROPOSED CONCRETE SURFACE REFER TO LANDSCAPE DRAWINGS
- EXISTING CATCHBASIN TO BE PROTECTED
- PROPOSED CATCHBASIN TO BE PROTECTED
- ACCESS ROAD CONSTRUCTION

GENERAL NOTES

1. EXISTING TOPOGRAPHICAL INFORMATION OBTAINED FROM SURVEY BY MATTHEWS, CAMERON, HEYWOOD-KERRY T. HOWE DATED DECEMBER 21, 2018.
2. THIS SET OF PLANS SHALL NOT BE USED FOR CONSTRUCTION UNTIL STAMPED BY THE DESIGN ENGINEER AND APPROVED BY THE LOCAL MUNICIPALITY.
3. NO CHANGES ARE TO BE MADE WITHOUT THE APPROVAL OF THE DESIGN ENGINEER.
4. THIS PLAN NOT TO BE REPRODUCED IN WHOLE OR IN PART WITHOUT THE PERMISSION OF WALTERFEDY.
5. THE POSITION OF POLE LINES, CONDUITS, WATERMANS, SEWERS, AND OTHER UNDERGROUND AND OVERGROUND UTILITIES AND STRUCTURES IS NOT NECESSARILY SHOWN ON THE CONTRACT DRAWINGS AND, WHERE SHOWN, THE ACCURACY OF THE POSITION OF SUCH UTILITIES AND STRUCTURES IS NOT GUARANTEED. BEFORE STARTING WORK, THE CONTRACTOR SHALL INFORM HIMSELF OF THE EXACT LOCATION OF ALL SUCH UTILITIES AND STRUCTURES AND SHALL ASSUME ALL LIABILITY FOR DAMAGE TO THEM AND THOSE NOT LOCATED PRIOR TO CONSTRUCTION.
6. ANY AREA DISTURBED DURING CONSTRUCTION SHALL BE RESTORED TO ITS ORIGINAL CONDITION OR BETTER TO THE SATISFACTION OF THE CONSULTANT AND AUTHORITY HAVING JURISDICTION. THE CONTRACTOR IS RESPONSIBLE FOR RESTORING ALL DAMAGED AND/OR DISTURBED PROPERTY WITHIN THE MUNICIPAL RIGHT-OF-WAY TO MUNICIPAL STANDARDS.
7. ALL HEALTH AND SAFETY RELATED SIGNAGE MUST BE POSTED AT THE SITE AS REQUIRED BY APPLICABLE LAW AND BEST MANAGEMENT PRACTICES.
8. REFER TO LANDSCAPE PLANS FOR REMOVAL AND PROTECTION OF VEGETATION
9. REFER TO STRUCTURAL PLANS FOR REMOVAL OF BUILDING
10. REFER TO MECHANICAL PLANS FOR REMOVAL OF EXISTING UTILITIES
11. REFER TO ELECTRICAL PLANS FOR REMOVAL OF EXISTING ELECTRICAL INFRASTRUCTURE
12. AT THE END OF CONSTRUCTION, THE CONTRACTOR SHALL PROVIDE THE CONSULTANT WITH A DIGITAL FILE OF AS-CONSTRUCTED DRAWINGS. THE DRAWINGS MUST REFLECT THE CONSTRUCTED STATE OF THE WORK. SUBMISSION OF UNALTERED DESIGN DRAWINGS AND CONTRACT CHANGES WILL NOT BE ACCEPTED.
13. THIS PLAN IS TO BE READ IN CONJUNCTION WITH THE EXISTING CONDITIONS AND REMOVALS PLAN, GRADING PLAN, SITE SERVICING PLAN, NOTES AND DETAILS PLAN, AND THE FUNCTIONAL SERVICING REPORT DATED SEPTEMBER 18, 2019.

EROSION CONTROL NOTES

1. ALL EROSION CONTROL FENCING, TEMPORARY FILTRATION, MUD MATS, SILT SACS MUST BE INSTALLED BY THE CONTRACTOR AND INSPECTED BY THE CONSULTANT PRIOR TO COMMENCEMENT OF ANY AREA GRADING, EXCAVATING, OR DEMOLITION. CONTRACTOR TO NOTIFY CONSULTANT FOR INSPECTION.
2. ATTACH EROSION CONTROL FENCE TO EXISTING FENCE WITHIN THE LIMITS OF THE SITE WHERE POSSIBLE.
3. EROSION CONTROL FENCING TO BE PLACED AROUND THE BASE OF ALL STOCKPILES. ALL STOCKPILES TO BE KEPT A MINIMUM OF 2.5m FROM PROPERTY LINES.
2. FILTER FABRIC TO BE TERRAFIX 270R OR APPROVED EQUIVALENT.
3. MUD MATS TO BE PROVIDED ON SITE AT ALL LOCATIONS WHERE CONSTRUCTION VEHICLES EXIT THE SITE. MUD MATS SHALL BE SUPPLIED AS INSTALLED AS PER THE DETAIL ON C5-1. CONTRACTOR TO ENSURE ALL VEHICLES LEAVE THE SITE VIA THE MUD MAT AND THAT THE MAT IS MAINTAINED IN A MANNER TO MAXIMIZE ITS EFFECTIVENESS AT ALL TIMES.
4. ALL DITCH INLET CATCHBASINS, CATCHBASINS AND CATCHBASIN MANHOLES TO HAVE TEMPORARY FILTRATION INSTALLED AND MAINTAINED AS PER THE DETAIL ON C5-1.
5. NO ALTERNATE METHODS OF EROSION CONTROL PROTECTION SHALL BE PERMITTED UNLESS APPROVED BY CONSULTANT AND THE AUTHORITY HAVING JURISDICTION.
6. ALL EROSION CONTROL STRUCTURES TO REMAIN IN PLACE UNTIL ALL DISTURBED GROUND SURFACES HAVE BEEN RE-STABILIZED EITHER BY PAVING OR RESTORATION WITH VEGETATIVE GROUND COVER.
7. THE CONTRACTOR IS RESPONSIBLE FOR REMOVING SEDIMENTS FROM THE PUBLIC ROADWAY AND SIDEWALKS AT THE END OF EACH WORK DAY OR AS DIRECTED BY THE CONSULTANT.
8. ALL EROSION AND SEDIMENT CONTROL MEASURES TO BE INSPECTED BY THE CONTRACTOR AFTER MAJOR RAINFALL EVENTS AND CLEANED OR REPLACED AS REQUIRED TO MEET THEIR INTENDED FUNCTION. SEDIMENTS TO BE REMOVED WHEN ACCUMULATIONS REACH A MAXIMUM OF ONE THIRD (1/3) THE STRUCTURE CAPACITY.
9. THE CONSULTANT SHALL MONITOR SITE DEVELOPMENT TO ENSURE ALL EROSION CONTROLS ARE INSTALLED AND MAINTAINED TO CITY OF NIAGARA FALLS REQUIREMENTS. CONTRACTOR TO COMPLY WITH THE CONSULTANTS INSTRUCTIONS TO INSTALL, MODIFY, OR MAINTAIN EROSION CONTROL WORKS.

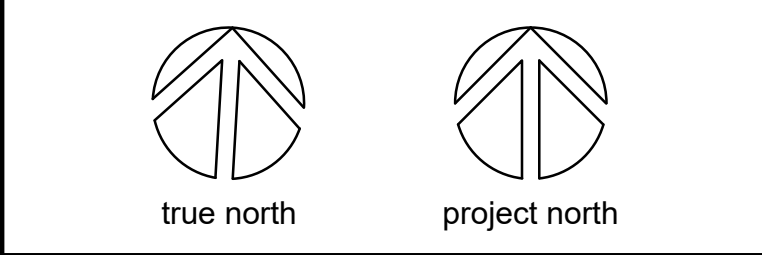
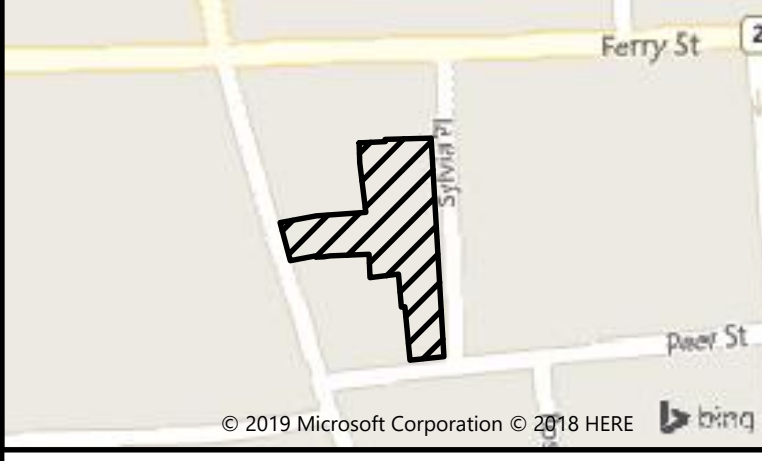
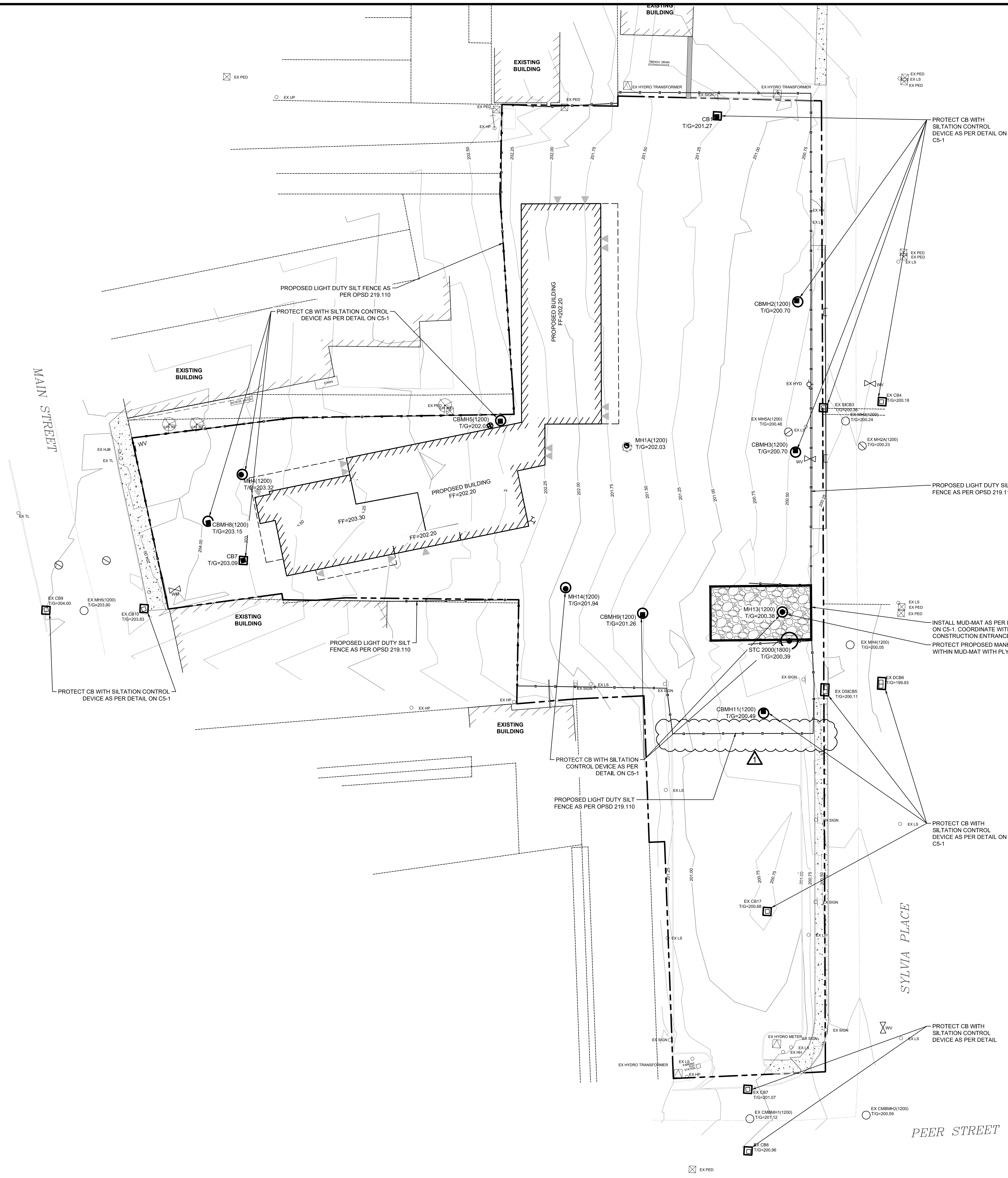

date	ISSUANCE	no.
2019.01.24	ISSUED FOR COSTING PACKAGE	
2019.07.05	ISSUED FOR COORDINATION	
2019.07.18	ISSUED FOR SITE PLAN APPROVAL	
2020.02.06	ISSUED FOR TENDER	
2020.02.24	ADDENDUM 2 - REVISION 1 - EXTENTS OF SILT FENCE	

customer
DTAH ARCHITECTS LIMITED
 50PARK RD. TORONTO, ONT
 M4W 2N5

project
NIAGARA FALLS EXCHANGE
 5943 SYLVIA PLACE, NIAGARA FALLS

title
EROSION AND SILTATION CONTROL PLAN

WALTERFEDY
 675 Queen Street South, Suite 111
 Kitchener, Ontario, Canada N2M 1A1
 T 519.576.2150 F 519.576.5499
 walterfedy.com

Reproduction or distribution for purposes other than authorized by WalterFedy is forbidden. Written dimensions have precedence over stated dimensions. Contractors shall verify and be responsible for all dimensions and conditions on the job and report any variations from the dimensions and conditions shown on drawings to WalterFedy. Shop drawings shall be submitted to WalterFedy for approval before proceeding with fabrication. Do not scale this drawing.
 COPYRIGHT © 2018 WALTERFEDY

scale:	1:300	sheet no.:	
date:	2019.01.18		
job no.:	2018-0010-10		
CAD file:	2018-0010-10_PLOT		
drawn by:	PM		
checked by:	MO		

C4-1