

**September 22, 9 AM**

1" = 100'-0"

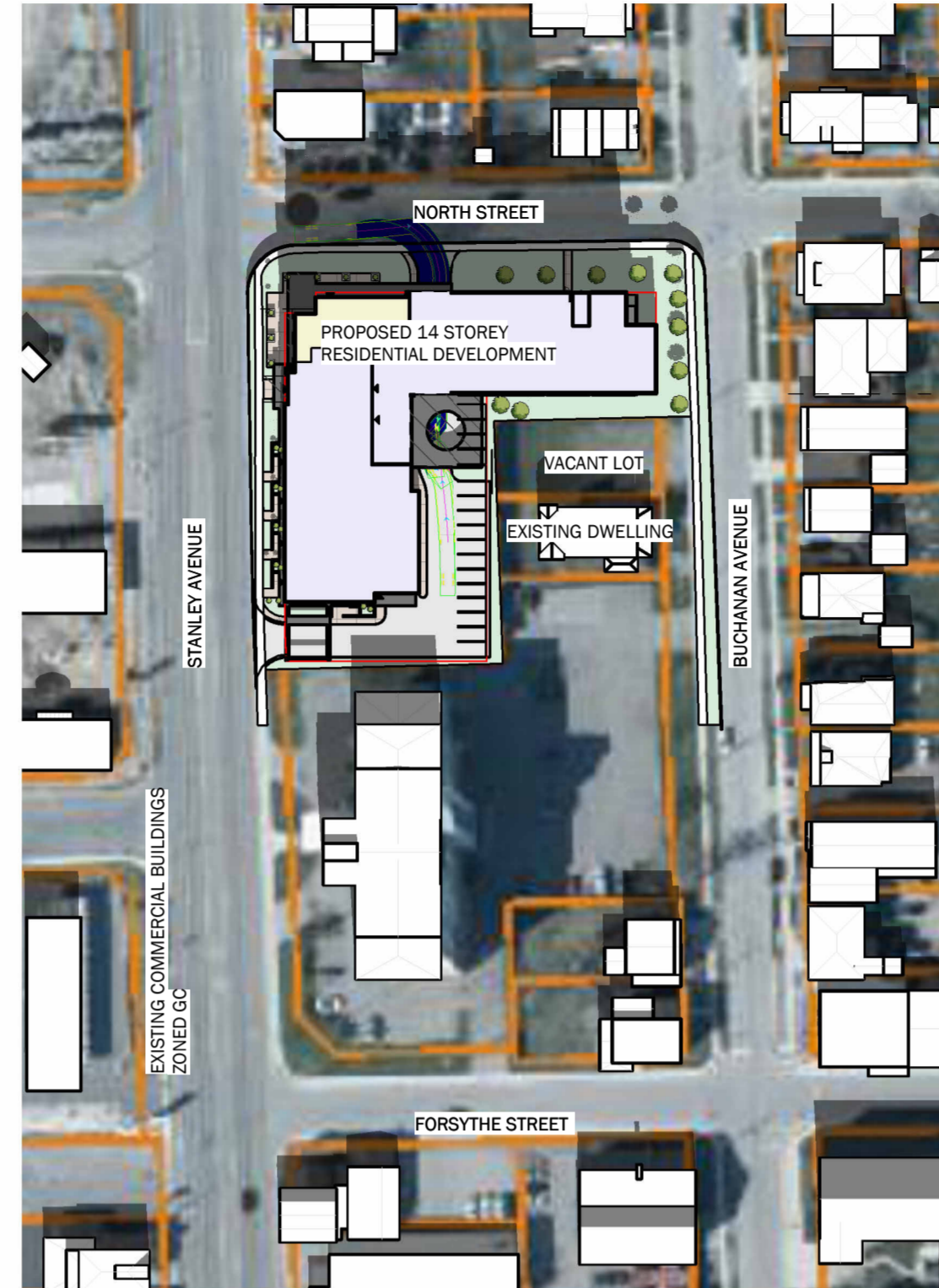

**September 22, 12 PM**

1" = 100'-0"

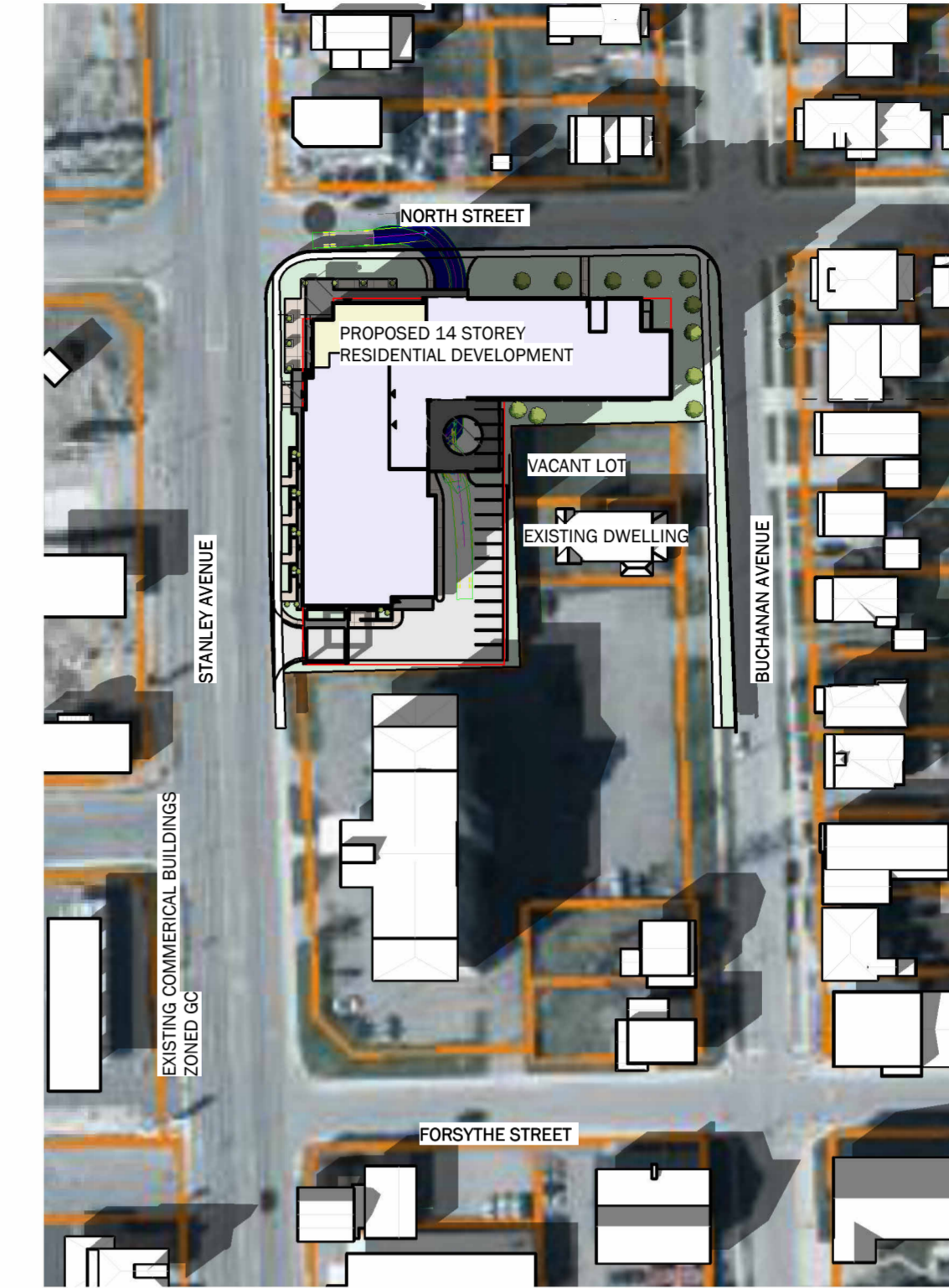

**September 22, 3 PM**

1" = 100'-0"

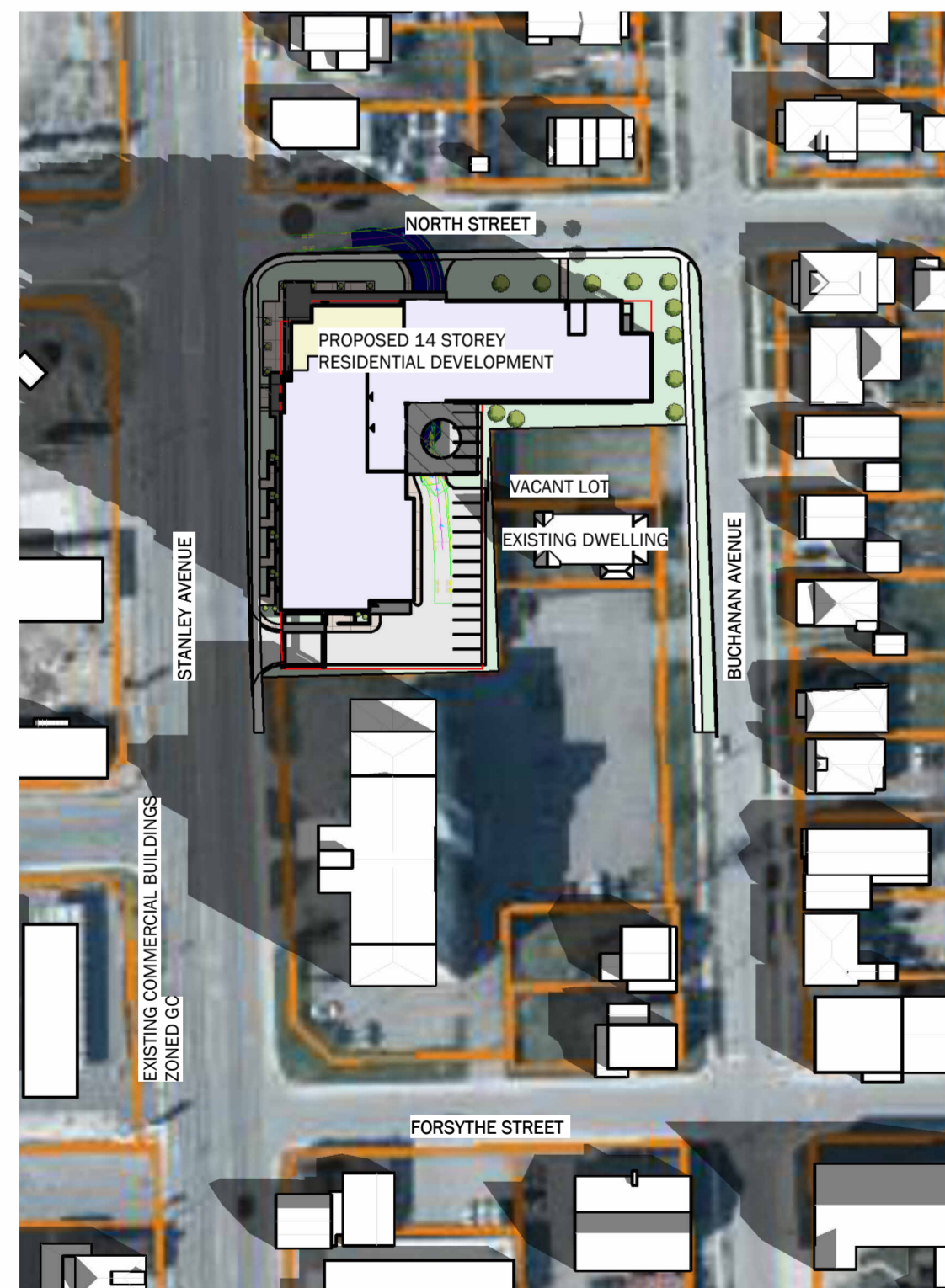

**March 20, 9 AM**

1" = 100'-0"

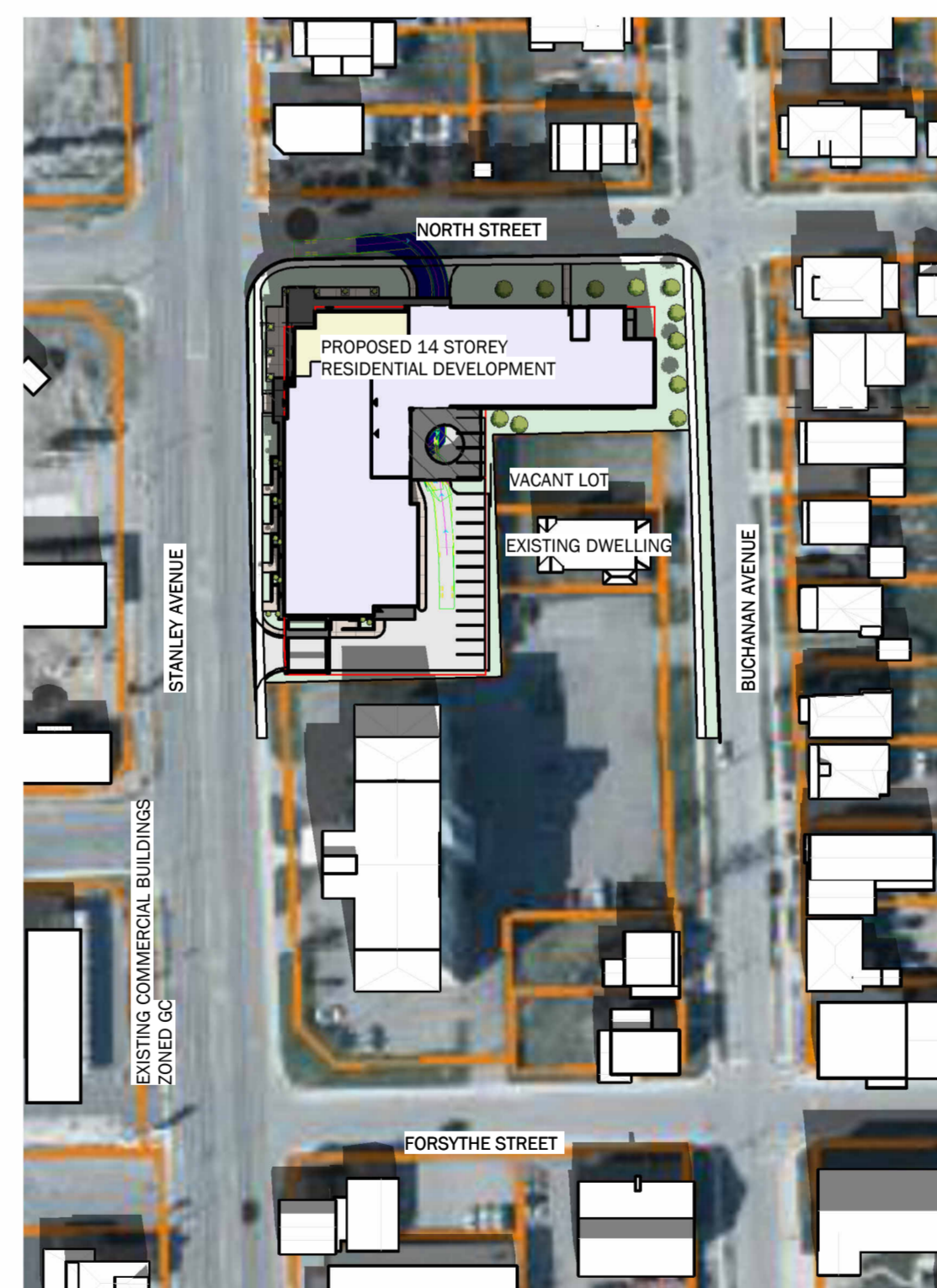

**March 20, 12 PM**

1" = 100'-0"

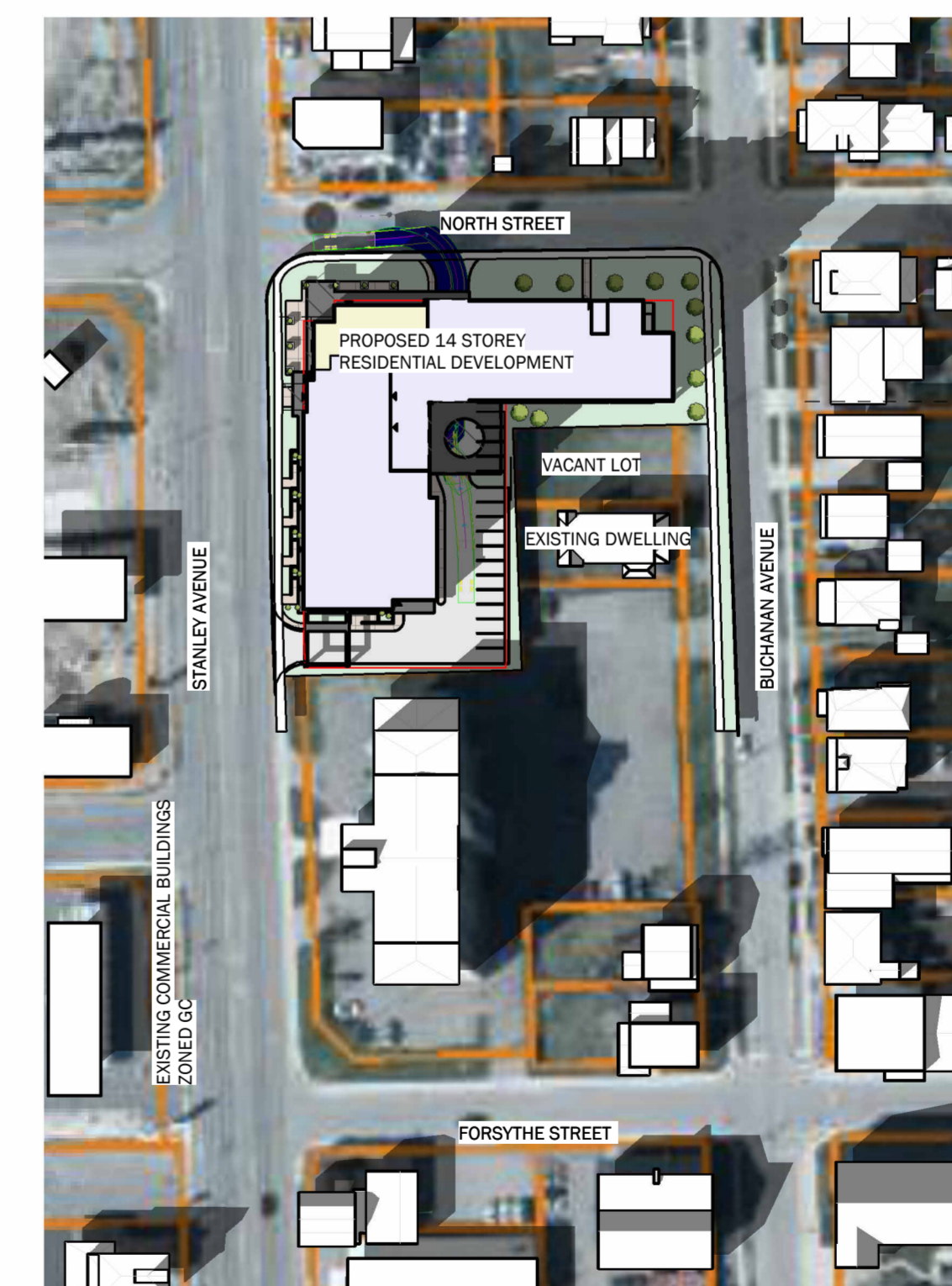

**March 20, 3 PM**

1" = 100'-0"

ALL CONTRACTORS AND/OR TRADES SHALL VERIFY ALL DIMENSIONS, NOTES, SITE AND REPORT ANY DISCREPANCIES PRIOR TO COMMENCEMENT OF THE WORK. THIS DRAWING NOT TO BE SCALED. ALL DRAWINGS, PRINTS AND RELATED DOCUMENTS ARE THE PROPERTY OF THE ARCHITECT AND MUST BE RETURNED UPON REQUEST. REPRODUCTION OF DRAWINGS AND RELATED DOCUMENTS IN PART OR IN WHOLE IS STRICTLY FORBIDDEN WITHOUT WRITTEN CONSENT. DRAWINGS TO BE FOR THE PURPOSE FOR WHICH THEY ARE ISSUED.

No.	DATE	DESCRIPTION	BY:
1	07/11/2022	PRE-CON SUBMISSION	JC
2	06/21/2023	REVISED CONCEPT/ELEVATIONS	JC
3	07/17/2023	ISSUED FOR ZBA	JC

COMMISSION:

**14-STORY  
RESIDENTIAL  
DEVELOPMENT**

5640 STANLEY AVENUE, NIAGARA FALLS, ON.

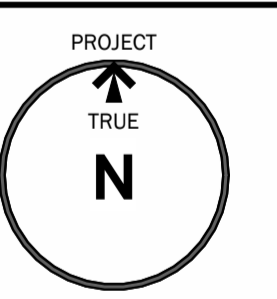

**A · C · K**  
architects  
STUDIO INC.

Architectural Office:  
290 Glendale Ave. St. Catharines, ON, L2T 2L3  
905 984 5545

SHEET TITLE:

**Fall & Spring Equinox**

DRAWN BY:	JC	DRAWING No.:
CHECKED BY:	MA/JR	<b>SS1</b>
DATE ISSUED:		
PROJECT No.:	2022-143	

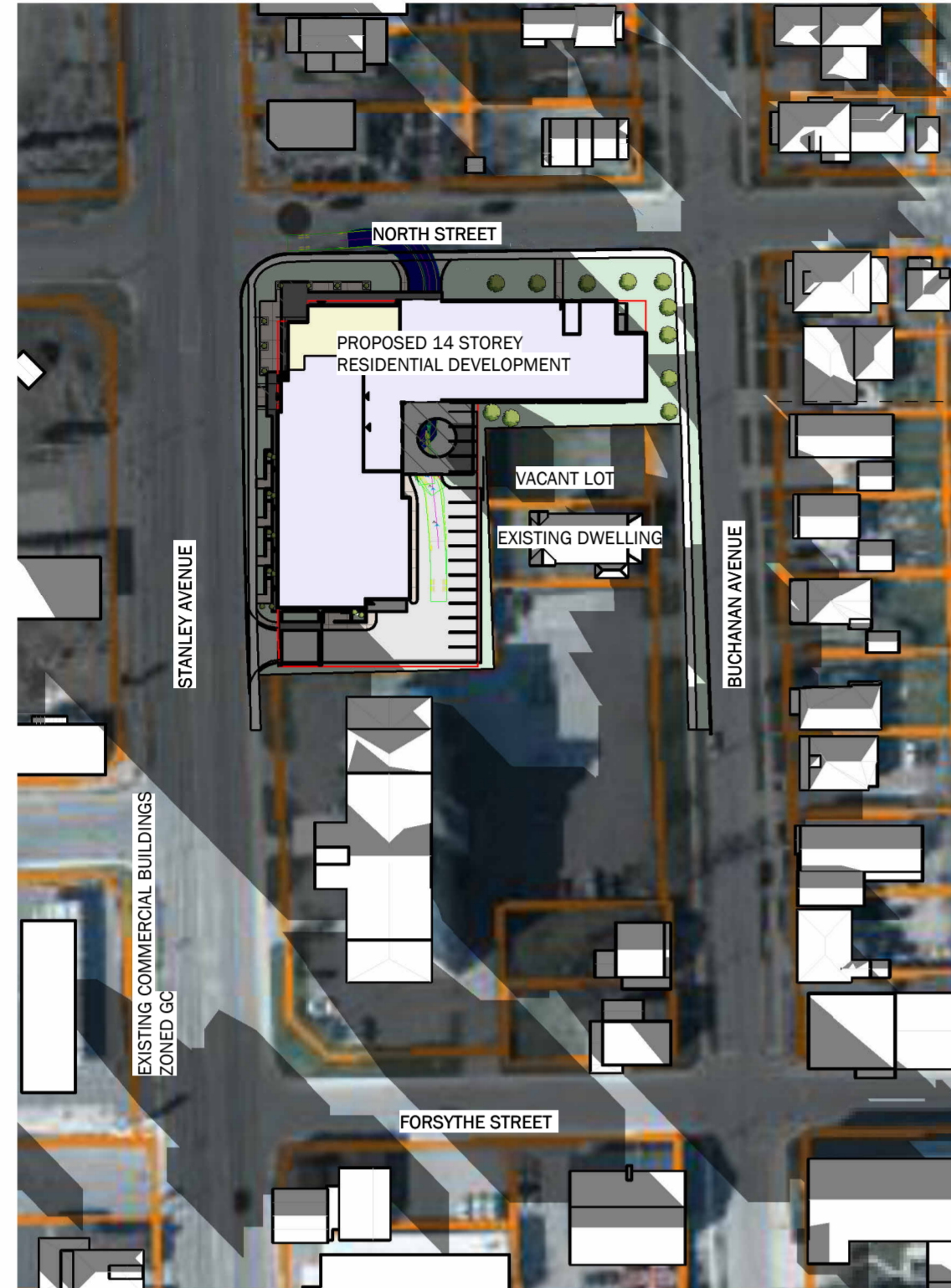

**December 21, 9 AM**

1" = 100'-0"

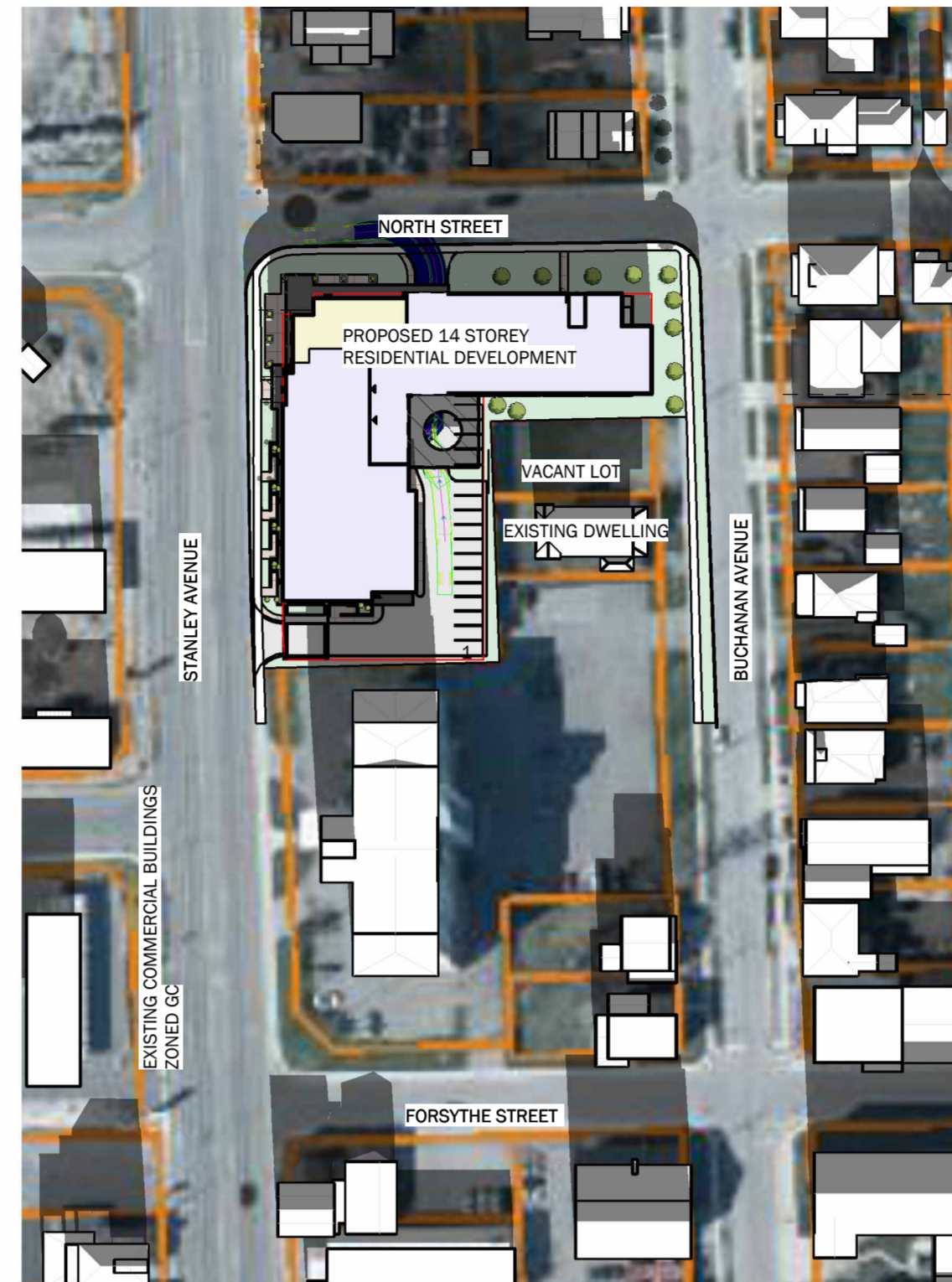

**December 21, 12 PM**

1" = 100'-0"

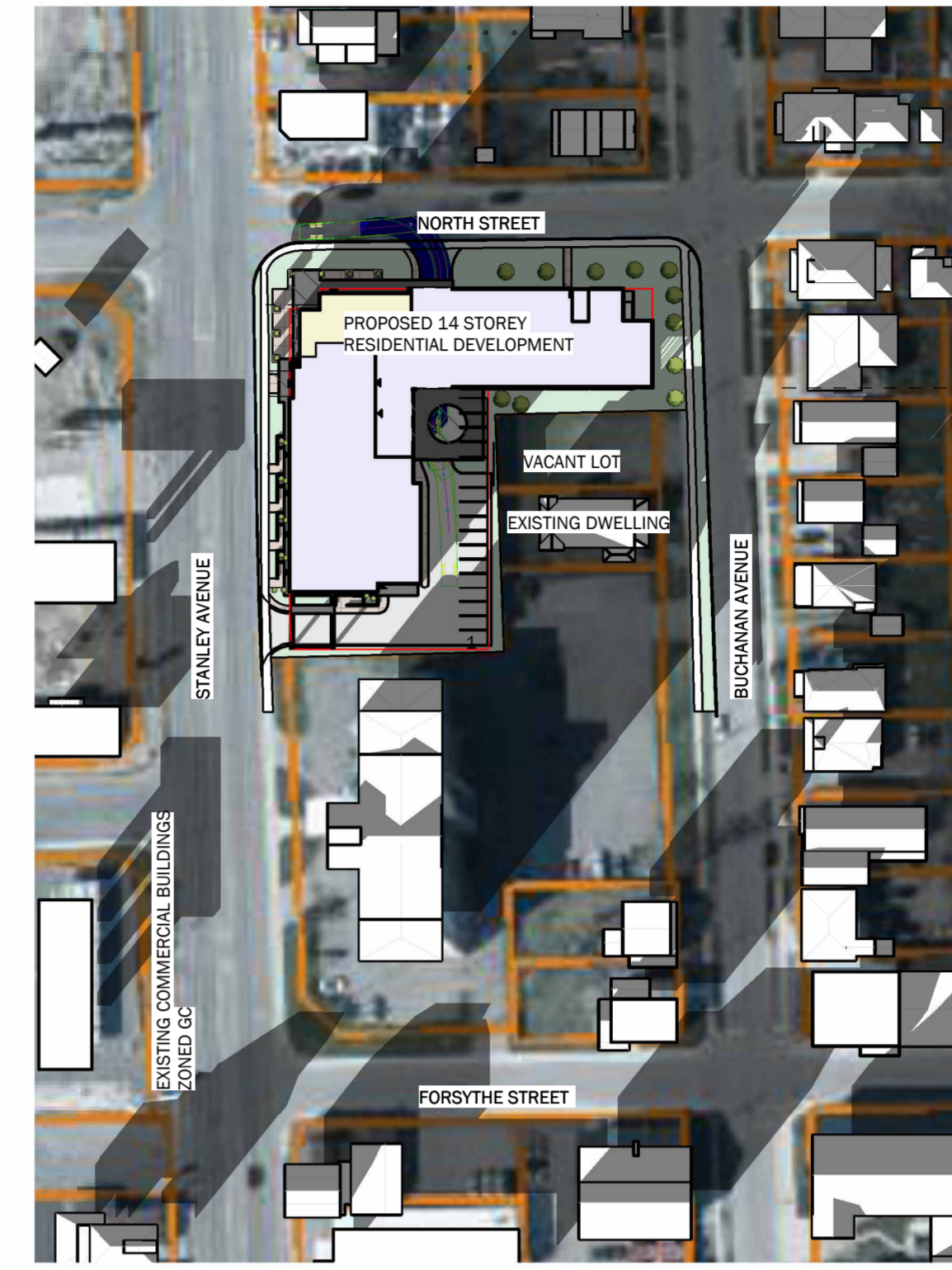

**December 21, 3 PM**

1" = 100'-0"

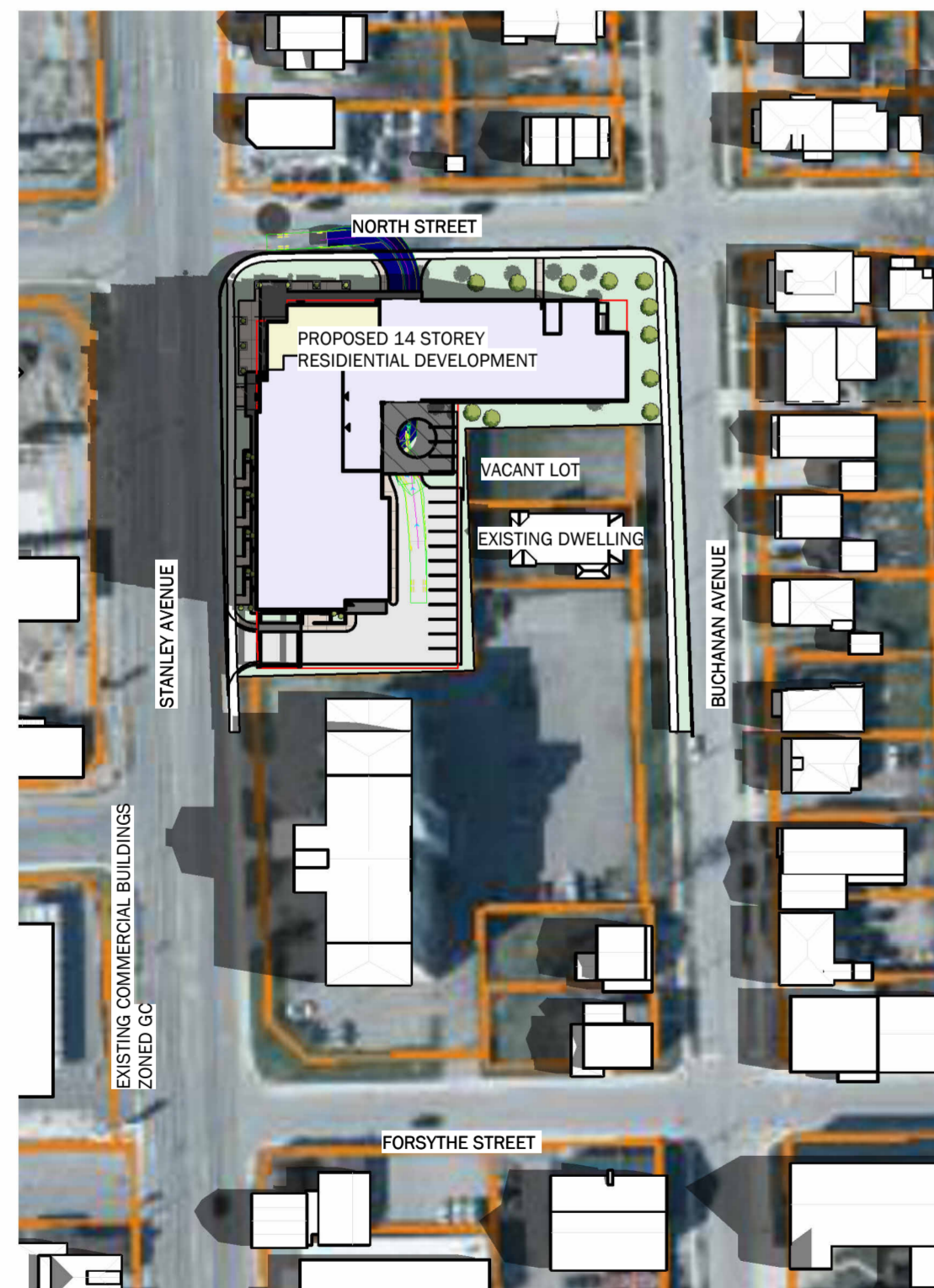

**June 21, 9 AM**

1" = 100'-0"

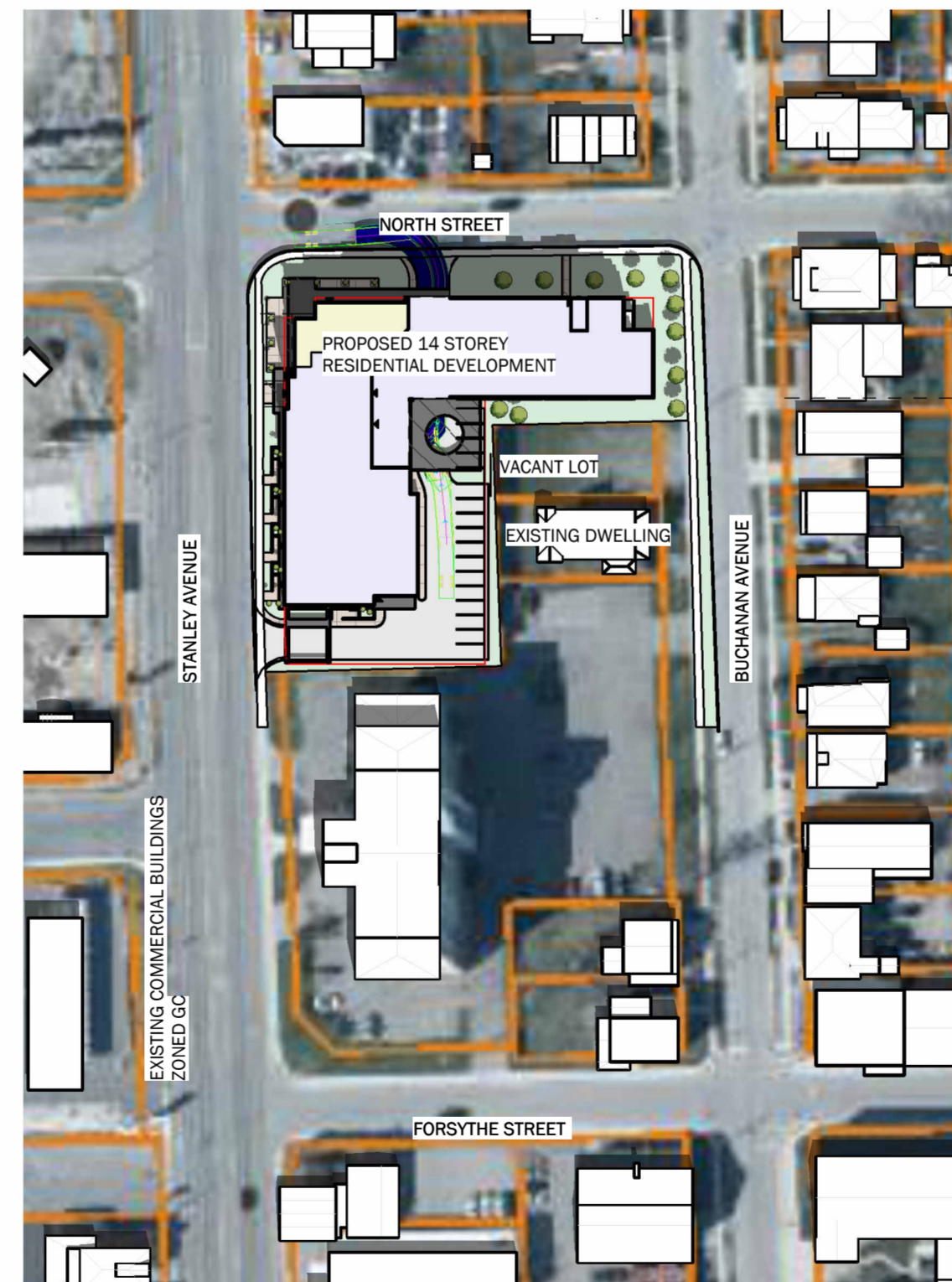

**June 21, 12 PM**

1" = 100'-0"



**June 21, 3 PM**

1" = 100'-0"

ALL CONTRACTORS AND/OR TRADES SHALL VERIFY ALL DIMENSIONS, NOTES, SITE AND REPORT ANY DISCREPANCIES PRIOR TO COMMENCEMENT OF THE WORK. THIS DRAWING NOT TO BE SCALED. ALL DRAWINGS, PRINTS AND RELATED DOCUMENTS ARE THE PROPERTY OF THE ARCHITECT AND MUST BE RETURNED UPON REQUEST. REPRODUCTION OF DRAWINGS AND RELATED DOCUMENTS IN PART OR IN WHOLE IS STRICTLY FORBIDDEN WITHOUT WRITTEN CONSENT. DRAWINGS TO BE FOR THE PURPOSE FOR WHICH THEY ARE ISSUED.

No.	DATE	DESCRIPTION	BY:
1	07/11/2022	PRE-CON SUBMISSION	JC
2	06/21/2023	REVISED CONCEPT/ELEVATIONS	JC
3	07/17/2023	ISSUED FOR ZBA	JC

COMMISSION:

**14-STOREY  
RESIDENTIAL  
DEVELOPMENT**

5640 STANLEY AVENUE, NIAGARA FALLS, ON.

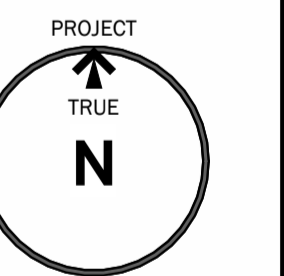

**A · C · K**  
architects  
STUDIO INC.

Architectural Office:  
290 Glendale Ave. St. Catharines, ON, L2T 2L3  
905 984 5545

SHEET TITLE:

**Winter & Summer  
Solstices**

DRAWN BY:	JC	DRAWING No.:
CHECKED BY:	MA/JR	<b>SS2</b>
DATE ISSUED:		
PROJECT No.:	2022-143	