



**P1 PARKING**  
 1 : 200  
**80,663 SQ.FT +/-**

TOWER A: 3 UNITS  
 TOWER B: 2 UNITS

**GENERAL NOTES**

All contractors and/or trades shall verify all dimensions, notes, site and report any discrepancies prior to commencement of the work. This drawing not to be scaled, all drawings, prints and related documents are the property of the architect and must be returned upon request. Reproduction of drawings and related documents in part or in whole is strictly forbidden without written consent. Drawings to be for the purpose for which they are issued.

NO.	DATE:	REVISION:	BY:
0	02/01/2022	MASSING CONCEPT	JKC
1	03/03/2022	ALT. SITE PLAN / MASSING	JKC
2	11/08/2023	REV. CONCEPT	JKC
3	02/08/2024	SHADOW STUDY	DD
4	02/12/2024	REV. ARCH PACKAGE	JKC
5	03/14/2024	ZBA+OPA SUBMISSION 1	JKC

COMMISSION:

**ST PAUL DEVELOPMENT**

2430 ST PAUL AVE, NIAGARA FALLS, ON L2E 6S4

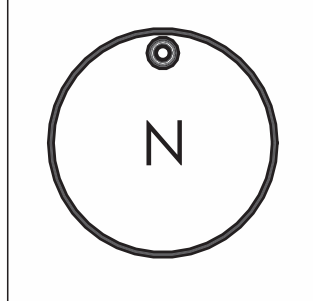

**A · C · K**  
 architects  
 STUDIO INC.

Architectural Office:  
 290 Glendale Ave. St. Catharines, ON, L2T 2L3  
 905 984 5545

SHEET TITLE:

**P1 UNDERGROUND PARKING**

Issued for Re-Zoning	
Issued for Site Plan Agreement	
Issued for Permit	
Issued for Tender	
Issued for Construction	
DRAWN BY:	JC DWG. No.
CHECKED BY:	MAJR
DATE:	NOV 30 2022
SCALE:	AS SHOWN
PROJECT No.:	2022-187

**.UG1**

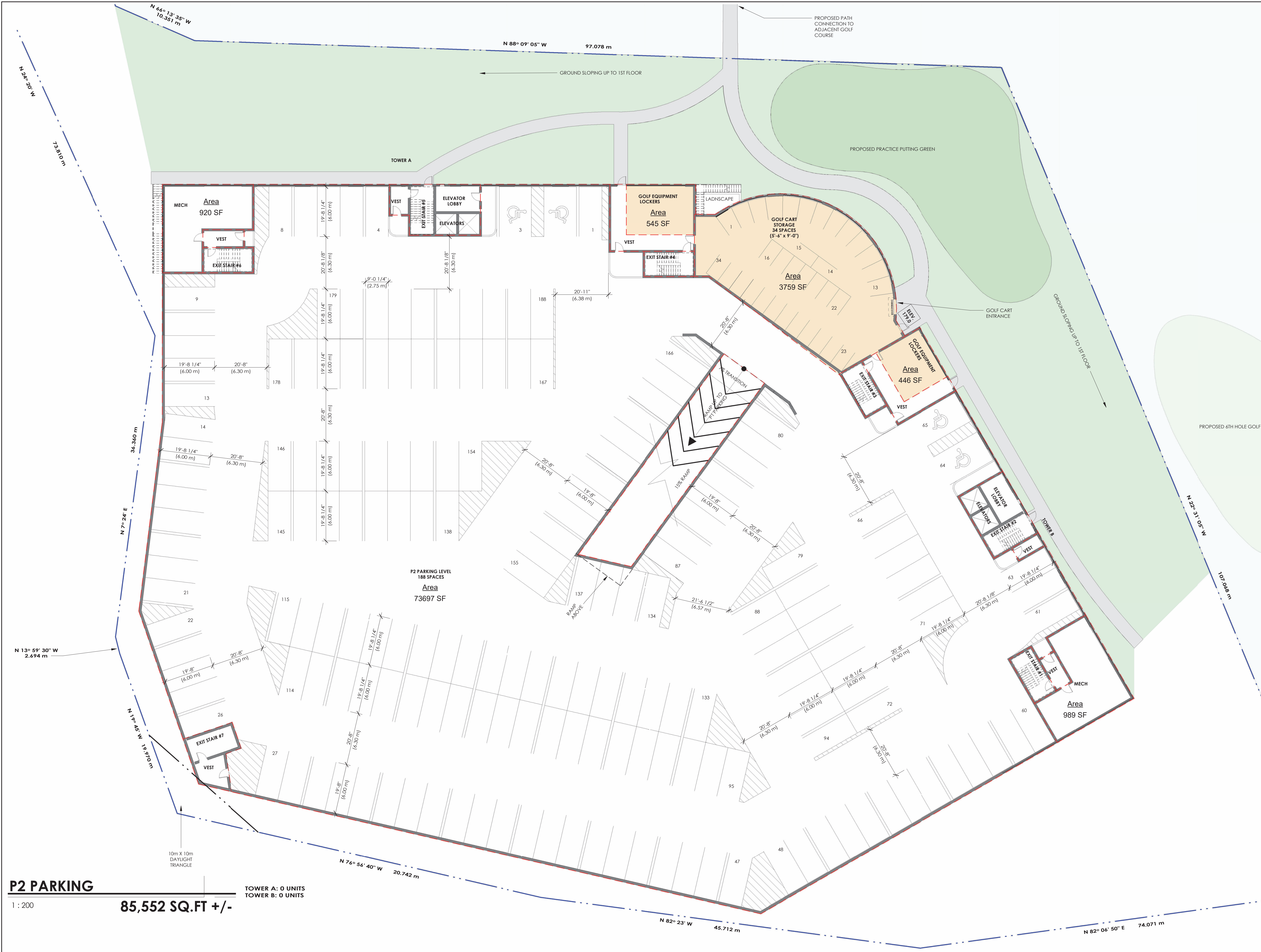

GENERAL NOTES

All contractors and/or trades shall verify all dimensions, notes, site and report any discrepancies prior to commencement of the work. This drawing not to be scaled, all drawings, prints and related documents are the property of the architect and must be returned upon request. Reproduction of drawings and related documents in part or in whole is strictly forbidden without written consent. Drawings to be for the purpose for which they are issued.

NO.	DATE	REVISION	BY:
0	02/01/2022	MASSING CONCEPT	JKC
1	03/03/2022	ALT. SITE PLAN / MASSING	JKC
2	11/08/2023	REV. CONCEPT	JKC
3	02/08/2024	SHADOW STUDY	DD
4	02/12/2024	REV. ARCH PACKAGE	JKC
5	03/14/2024	ZBA+OPA SUBMISSION 1	JKC

COMMISSION:

**ST PAUL DEVELOPMENT**

2430 ST PAUL AVE, NIAGARA FALLS, ON L2E 6S4

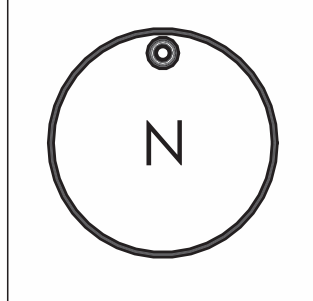

**A · C · K**  
architects  
STUDIO INC.

Architectural Office:  
290 Glendale Ave. St. Catharines, ON L2T 2L3  
905 984 5545

SHEET TITLE:

**P2 UNDERGROUND PARKING**

Issued for Re-Zoning	
Issued for Site Plan Agreement	
Issued for Permit	
Issued for Tender	
Issued for Construction	
DRAWN BY: JC	DWG. No.
CHECKED BY: MAJR	
DATE: NOV 30 2022	
SCALE: AS SHOWN	<b>.UG2</b>
PROJECT No.: 2022-187	

**P2 PARKING**

1 : 200

**85,552 SQ.FT +/-**

TOWER A: 0 UNITS  
TOWER B: 0 UNITS

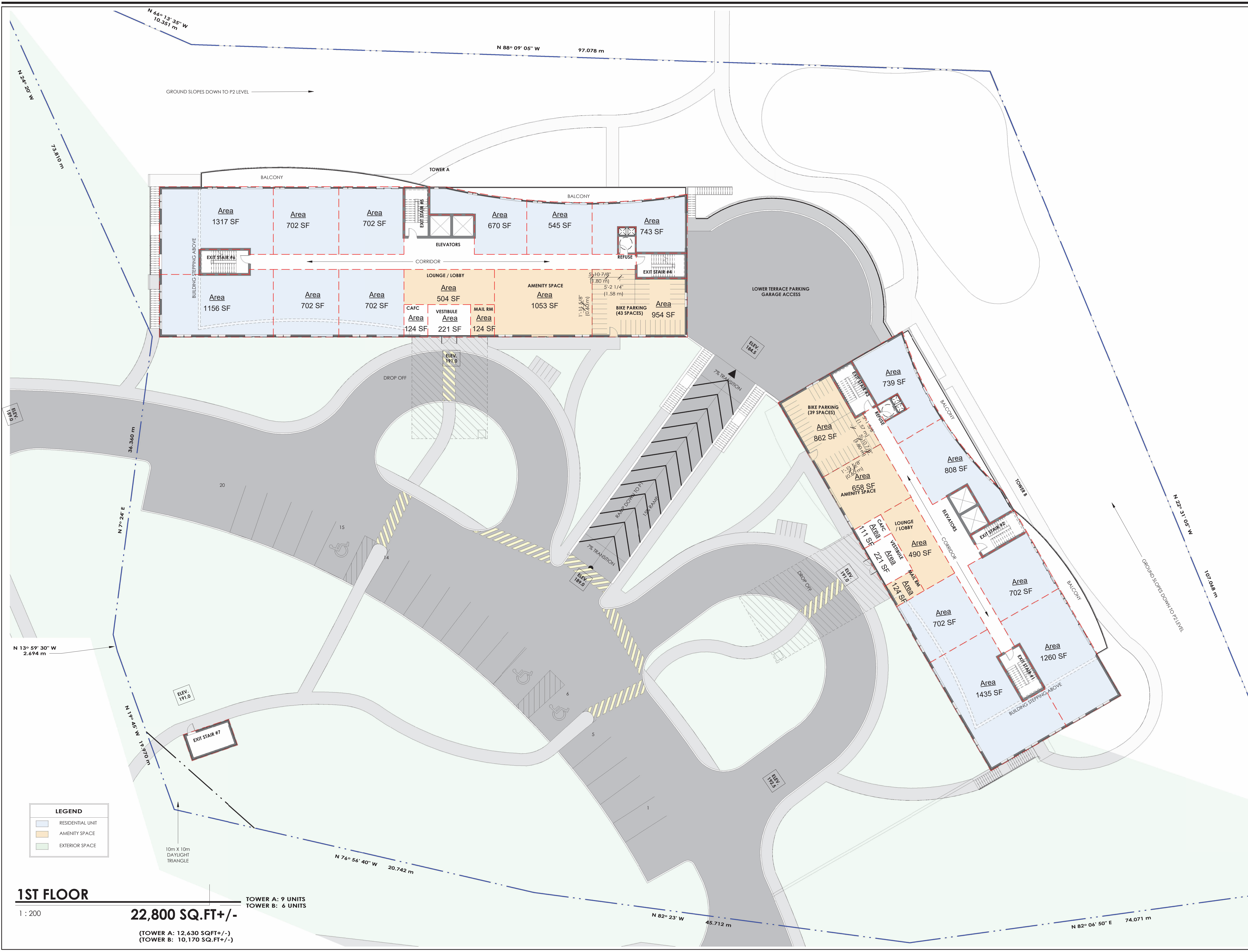

GENERAL NOTES

All contractors and/or trades shall verify all dimensions, notes, site and report any discrepancies prior to commencement of the work. This drawing not to be scaled, all drawings, prints and related documents are the property of the architect and must be returned upon request. Reproduction of drawings and related documents in part or in whole is strictly forbidden without written consent. Drawings to be for the purpose for which they are issued.

NO.	DATE	REVISION	BY:
0	02/01/2022	MASSING CONCEPT	JKC
1	03/03/2022	ALT. SITE PLAN / MASSING	JKC
2	11/08/2023	REV. CONCEPT	JKC
3	02/08/2024	SHADOW STUDY	DD
4	02/12/2024	REV. ARCH PACKAGE	JKC
5	03/14/2024	ZBA+OPA SUBMISSION 1	JKC

COMMISSION:

**ST PAUL DEVELOPMENT**  
 2430 ST PAUL AVE, NIAGARA FALLS, ON L2E 6S4

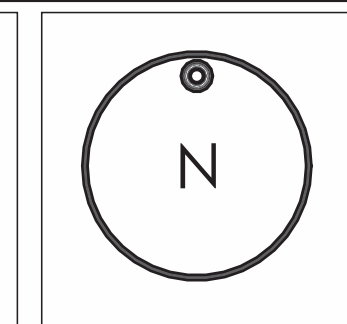

**A · C · K**  
 architects  
 STUDIO INC.

Architectural Office:  
 290 Glendale Ave. St. Catharines, ON, L2T 2L3  
 905 984 5545

SHEET TITLE:

**GROUND FLOOR PLATE**

Issued for Re-Zoning		
Issued for Site Plan Agreement		
Issued for Permit		
Issued for Tender		
Issued for Construction		
DRAWN BY:	JC	DWG. No.
CHECKED BY:	MAJR	<b>A1</b>
DATE:	NOV 30 2022	
SCALE:	AS SHOWN	
PROJECT No.:	2022-187	

**1ST FLOOR**  
 1 : 200  
**22,800 SQ.FT+/-**  
 (TOWER A: 12,630 SQFT+/-)  
 (TOWER B: 10,170 SQ.FT+/-)

TOWER A: 9 UNITS  
 TOWER B: 6 UNITS

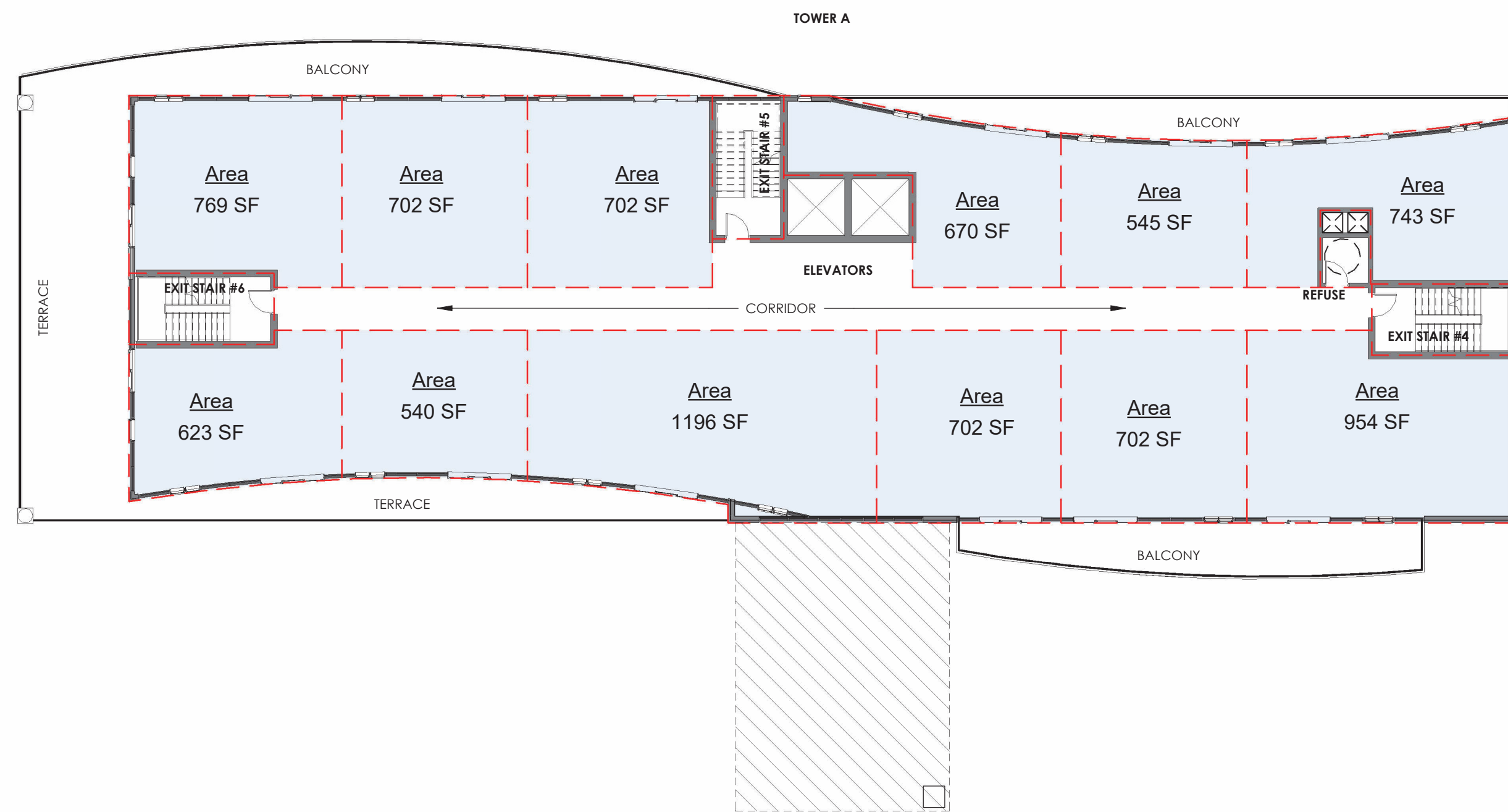

**LEGEND**

<span style="color: blue;">■</span>	RESIDENTIAL UNIT
<span style="color: orange;">■</span>	AMENITY SPACE
<span style="color: green;">■</span>	EXTERIOR SPACE

**2ND FLOOR PLATE**

1 : 200

**19,083 SQ.FT +/-**

(TOWER A: 10,797 SQFT+/-)  
(TOWER B: 8,286 SQ.FT+/-)

TOWER A: 12 UNITS  
TOWER B: 9 UNITS

GENERAL NOTES

NO.	DATE:	REVISION:	BY:
0	02/01/2022	MASSING CONCEPT	JKC
1	03/03/2022	ALT. SITE PLAN / MASSING	JKC
2	11/08/2023	REV. CONCEPT	JKC
3	02/08/2024	SHADOW STUDY	DD
4	02/12/2024	REV. ARCH PACKAGE	JKC
5	03/14/2024	ZBA+OPA SUBMISSION 1	JKC

COMMISSION:

**ST PAUL DEVELOPMENT**

2430 ST PAUL AVE, NIAGARA FALLS, ON L2E 6S4

**A · C · K**  
architects  
STUDIO INC.

Architectural Office:  
290 Glendale Ave. St. Catharines, ON, L2T 2L3  
905 984 5545

SHEET TITLE:

**2ND FLOOR PLATE**

Issued for Re-Zoning

Issued for Site Plan Agreement:

Issued for Permit:

Issued for Tender:

Issued for Construction:

DRAWN BY:	JC	DWG. No.
CHECKED BY:	MAJR	<b>A2</b>
DATE:	NOV 30 2022	
SCALE:	AS SHOWN	
PROJECT No.:	2022-187	



**LEGEND**

RESIDENTIAL UNIT
AMENITY SPACE
EXTERIOR SPACE

**3RD - 9TH FLOOR PLATE**

TOWER A: 13 UNITS  
TOWER B: 9 UNITS

**19,083 SQ.FT +/-**

(TOWER A: 10,797 SQFT+/-)  
(TOWER B: 8,286 SQ.FT+/-)

1 : 200

GENERAL NOTES

All contractors and/or trades shall verify all dimensions, notes, site and report any discrepancies prior to commencement of the work. This drawing not to be scaled, all drawings, prints and related documents are the property of the architect and must be returned upon request. Reproduction of drawings and related documents in part or in whole is strictly forbidden without written consent. Drawings to be for the purpose for which they are issued.

NO.	DATE:	REVISION:	BY:
0	02/01/2022	MASSING CONCEPT	JKC
1	03/03/2022	ALT. SITE PLAN / MASSING	JKC
2	11/08/2023	REV. CONCEPT	JKC
3	02/08/2024	SHADOW STUDY	DD
4	02/12/2024	REV. ARCH PACKAGE	JKC
5	03/14/2024	ZBA+OPA SUBMISSION 1	JKC

COMMISSION:

**ST PAUL DEVELOPMENT**

2430 ST PAUL AVE, NIAGARA FALLS, ON L2E 6S4

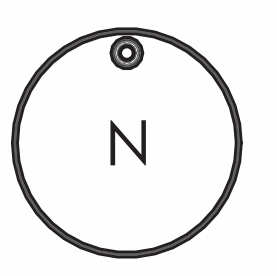

**A · C · K**  
architects  
STUDIO INC.

Architectural Office:  
290 Glendale Ave. St. Catharines, ON, L2T 2L3  
905 984 5545

SHEET TITLE:

**3RD - 9TH FLOOR PLATE**

Issued for Re-Zoning

Issued for Site Plan Agreement:

Issued for Permit:

Issued for Tender:

Issued for Construction:

DRAWN BY: JC DWG. No.

CHECKED BY: MAJR

DATE: NOV 30 2022

SCALE: AS SHOWN

PROJECT No.: 2022-187

**A3**

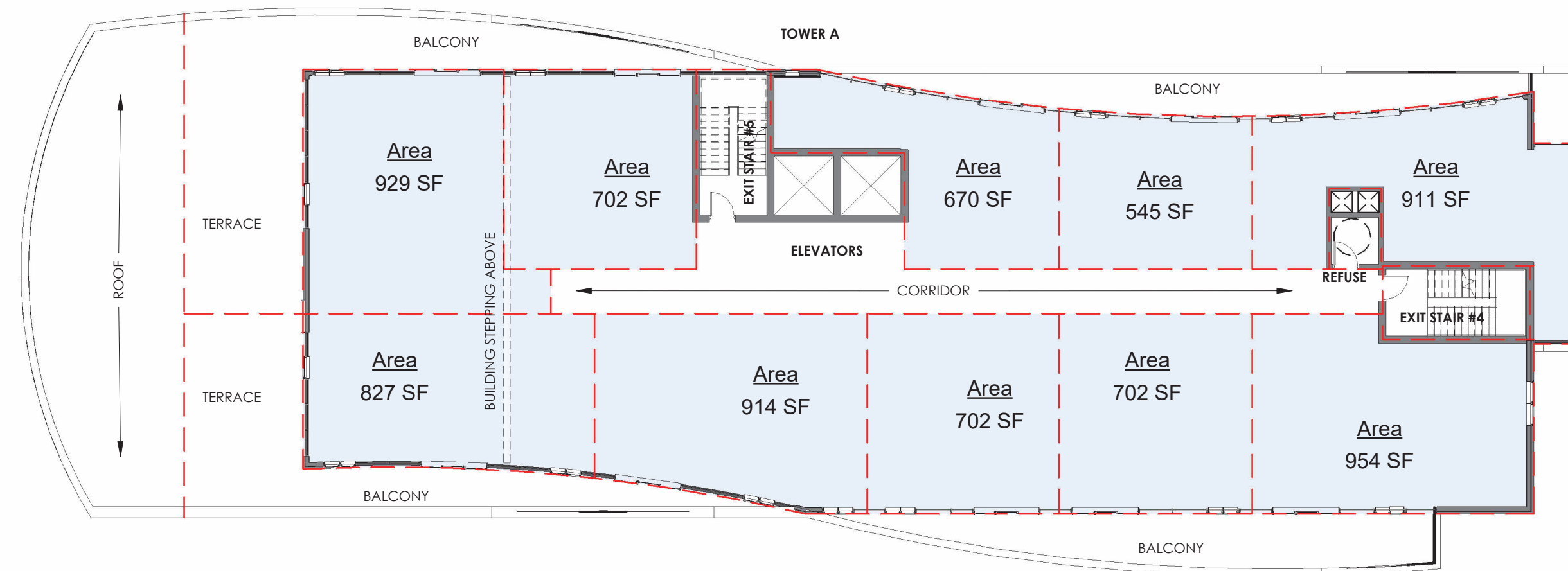

**LEGEND**

RESIDENTIAL UNIT
AMENITY SPACE
EXTERIOR SPACE

**10TH - 11TH FLOOR PLATE**

1 : 200

**17,764 SQ.FT**

(TOWER A: 9,359 SQ.FT+/-)  
(TOWER B: 8,405 SQ.FT+/-)

TOWER A: 10 UNITS  
TOWER B: 9 UNITS

GENERAL NOTES

All contractors and/or trades shall verify all dimensions, notes, site and report any discrepancies prior to commencement of the work. This drawing not to be scaled, all drawings, prints and related documents are the property of the architect and must be returned upon request. Reproduction of drawings and related documents in part or in whole is strictly forbidden without written consent. Drawings to be for the purpose for which they are issued.

NO.	DATE:	REVISION:	BY:
0	02/01/2022	MASSING CONCEPT	JKC
1	03/03/2022	ALT. SITE PLAN / MASSING	JKC
2	11/08/2023	REV. CONCEPT	JKC
3	02/08/2024	SHADOW STUDY	DD
4	02/12/2024	REV. ARCH PACKAGE	JKC
5	03/14/2024	ZBA+OPA SUBMISSION 1	JKC

COMMISSION:

**ST PAUL DEVELOPMENT**

2430 ST PAUL AVE, NIAGARA FALLS, ON L2E 6S4

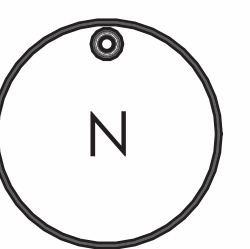

**A · C · K**  
architects  
STUDIO INC.

Architectural Office:  
290 Glendale Ave. St. Catharines, ON, L2T 2L3  
905 984 5545

SHEET TITLE:

**10TH - 11TH FLOOR PLATE**

Issued for Re-Zoning

Issued for Site Plan Agreement:

Issued for Permit:

Issued for Tender:

Issued for Construction:

DRAWN BY:	JC	DWG. No.	<b>A4</b>
CHECKED BY:	MAJR		
DATE:	NOV 30 2022		
SCALE:	AS SHOWN		
PROJECT No.:	2022-187		

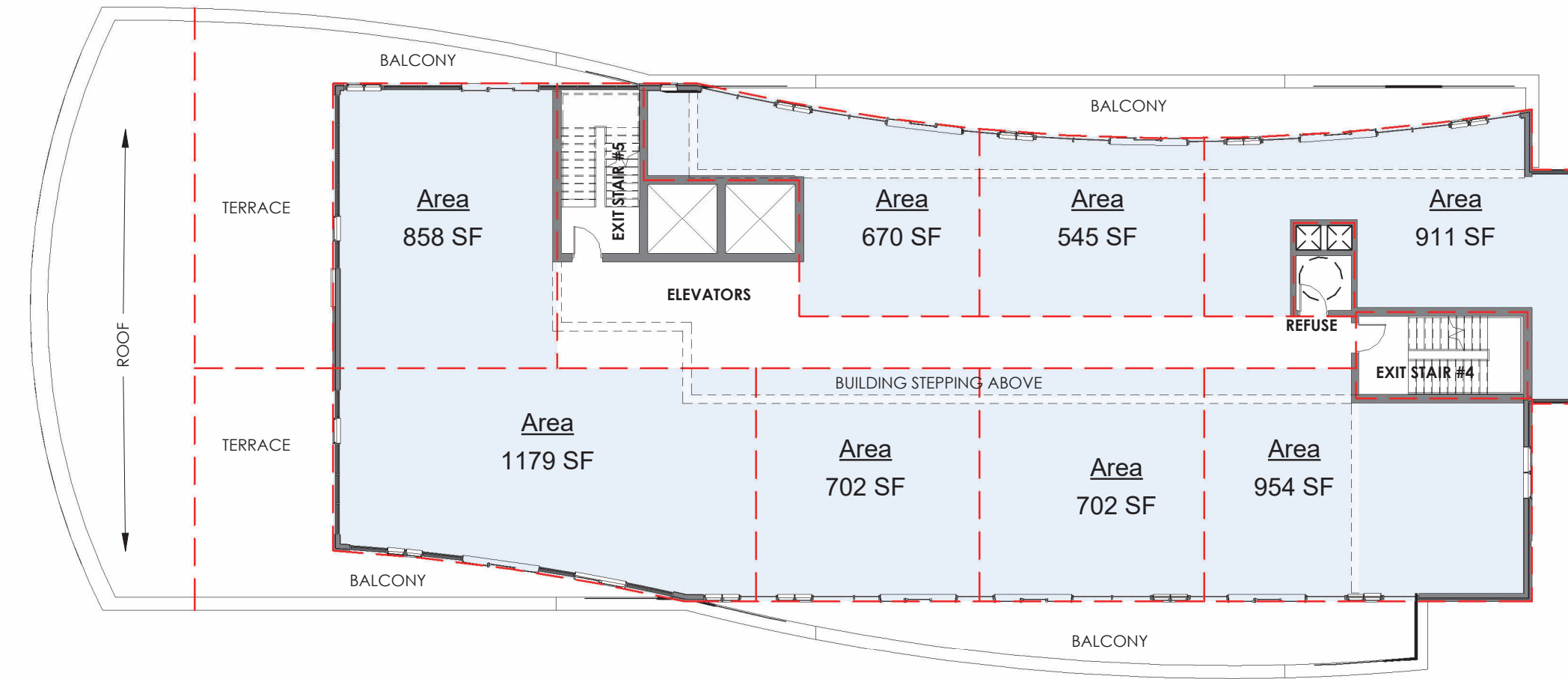

**LEGEND**

<span style="color: blue;">■</span>	RESIDENTIAL UNIT
<span style="color: orange;">■</span>	AMENITY SPACE
<span style="color: green;">■</span>	EXTERIOR SPACE

**12TH - 14TH FLOOR PLATES**

1 : 200

**14,730 SQ.FT**

(TOWER A: 7,907 SQ.FT+/-)  
(TOWER B: 6,823 SQ.FT+/-)

TOWER A: 8 UNITS  
TOWER B: 7 UNITS

GENERAL NOTES

All contractors and/or trades shall verify all dimensions, notes, site and report any discrepancies prior to commencement of the work. This drawing not to be scaled, all drawings, prints and related documents are the property of the architect and must be returned upon request. Reproduction of drawings and related documents in part or in whole is strictly forbidden without written consent. Drawings to be for the purpose for which they are issued.

NO.	DATE:	REVISION:	BY:
0	02/01/2022	MASSING CONCEPT	JKC
1	03/03/2022	ALT. SITE PLAN / MASSING	JKC
2	11/08/2023	REV. CONCEPT	JKC
3	02/08/2024	SHADOW STUDY	DD
4	02/12/2024	REV. ARCH PACKAGE	JKC
5	03/14/2024	ZBA+OPA SUBMISSION 1	JKC

COMMISSION:

**ST PAUL DEVELOPMENT**

2430 ST PAUL AVE, NIAGARA FALLS, ON L2E 6S4

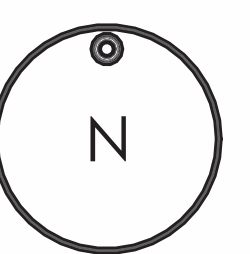

**A · C · K**  
architects  
STUDIO INC.

Architectural Office:  
290 Glendale Ave. St. Catharines, ON, L2T 2L3  
905 984 5545

SHEET TITLE:

**12TH - 14TH FLOOR PLATE**

Issued for Re-Zoning

Issued for Site Plan Agreement:

Issued for Permit:

Issued for Tender:

Issued for Construction:

DRAWN BY:	JC	DWG. No.
CHECKED BY:	MAJR	<b>A5</b>
DATE:	NOV 30 2022	
SCALE:	AS SHOWN	
PROJECT No.:	2022-187	

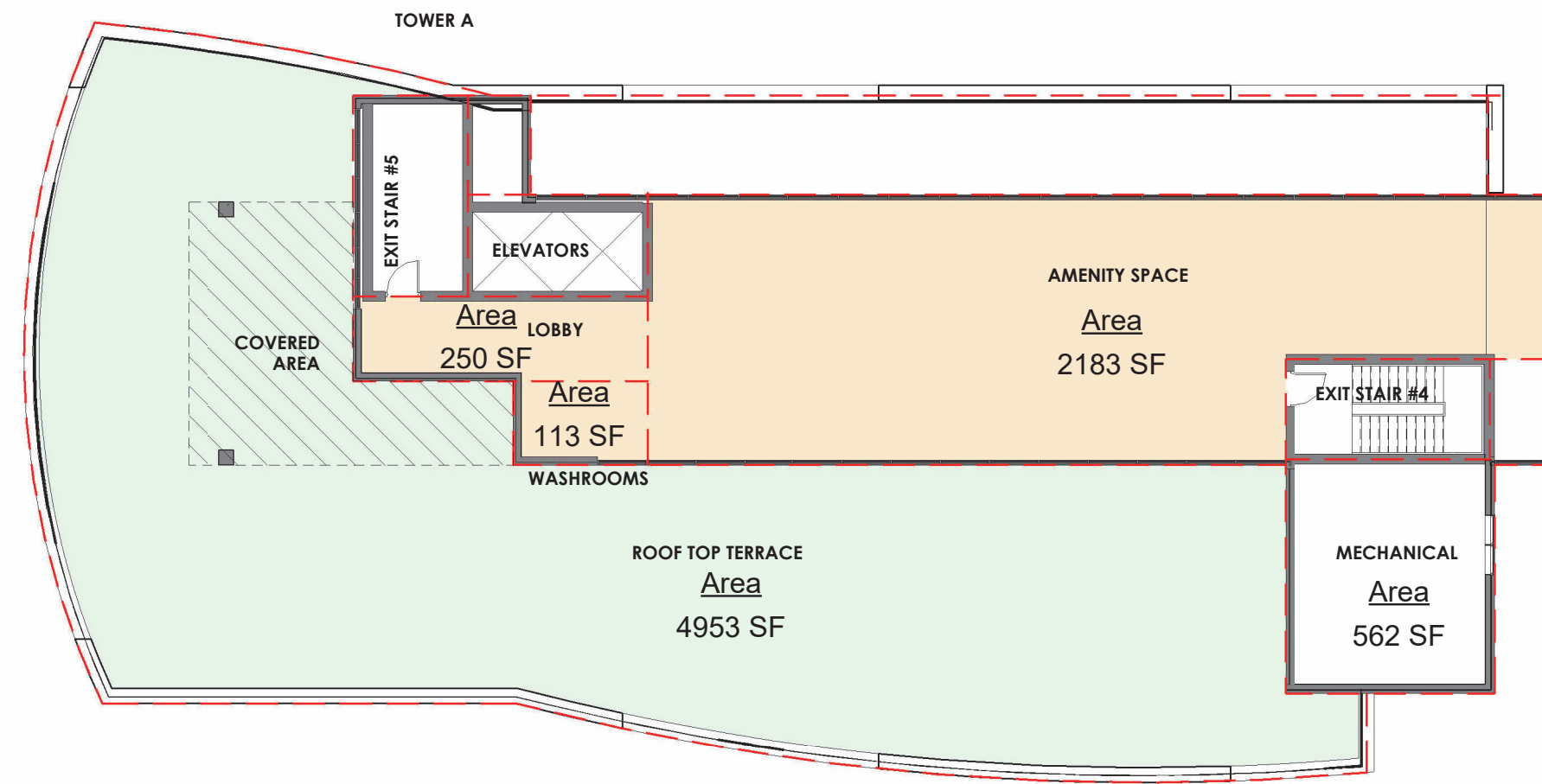

**LEGEND**

<span style="color: blue;">■</span>	RESIDENTIAL UNIT
<span style="color: orange;">■</span>	AMENITY SPACE
<span style="color: green;">■</span>	EXTERIOR SPACE

**15TH - 19TH FLOOR PLATE**

1 : 200

**7,850 SQ.FT +/-**

(TOWER A: 2,513 SQFT+/-)  
(TOWER B: 5,337 SQ.FT+/-)

TOWER A: 0 UNITS  
TOWER B: 5 UNITS

GENERAL NOTES

All contractors and/or trades shall verify all dimensions, notes, site and report any discrepancies prior to commencement of the work. This drawing not to be scaled, all drawings, prints and related documents are the property of the architect and must be returned upon request. Reproduction of drawings and related documents in part or in whole is strictly forbidden without written consent. Drawings to be for the purpose for which they are issued.

NO.	DATE:	REVISION:	BY:
0	02/01/2022	MASSING CONCEPT	JKC
1	03/03/2022	ALT. SITE PLAN / MASSING	JKC
2	11/08/2023	REV. CONCEPT	JKC
3	02/08/2024	SHADOW STUDY	DD
4	02/12/2024	REV. ARCH PACKAGE	JKC
5	03/14/2024	ZBA+OPA SUBMISSION 1	JKC

COMMISSION:

**ST PAUL DEVELOPMENT**

2430 ST PAUL AVE, NIAGARA FALLS, ON L2E 6S4



**A · C · K**  
architects  
STUDIO INC.

Architectural Office:  
290 Glendale Ave. St. Catharines, ON, L2T 2L3  
905 984 5545

SHEET TITLE:

**15TH - 19TH FLOOR PLATE**

Issued for Re-Zoning

Issued for Site Plan Agreement:

Issued for Permit:

Issued for Tender:

Issued for Construction:

DRAWN BY:	JC	DWG. No.
CHECKED BY:	MAJR	<b>A6</b>
DATE:	NOV 30 2022	
SCALE:	AS SHOWN	
PROJECT No.:	2022-187	



GENERAL NOTES

All contractors and/or trades shall verify all dimensions, notes, site and report any discrepancies prior to commencement of the work. This drawing not to be scaled, all drawings, prints and related documents are the property of the architect and must be returned upon request. Reproduction of drawings and related documents in part or in whole is strictly forbidden without written consent. Drawings to be for the purpose for which they are issued.

NO.	DATE:	REVISION:	BY:
0	02/01/2022	MASSING CONCEPT	JKC
1	03/03/2022	ALT. SITE PLAN / MASSING	JKC
2	11/08/2023	REV. CONCEPT	JKC
3	02/08/2024	SHADOW STUDY	DD
4	02/12/2024	REV. ARCH PACKAGE	JKC
5	03/14/2024	ZBA+OFA SUBMISSION 1	JKC

COMMISSION:

ST PAUL DEVELOPMENT

2430 ST PAUL AVE, NIAGARA FALLS, ON L2E 6S4

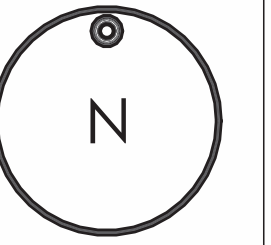

**A · C · K**  
architects  
STUDIO INC.

Architectural Office:  
290 Glendale Ave. St. Catharines, ON, L2T 2L3  
905 984 5545

SHEET TITLE:

ROOF TOP TERRACE

Issued for Re-Zoning

Issued for Site Plan Agreement:

Issued for Permit:

Issued for Tender:

Issued for Construction:

DRAWN BY:	JC	DWG. No.
CHECKED BY:	MAJR	<b>A7</b>
DATE:	NOV 30 2022	
SCALE:	AS SHOWN	
PROJECT No.:	2022-187	



**LEGEND**

<span style="display:inline-block; width:10px; height:10px; background-color:lightblue; border:1px solid black;"></span>	RESIDENTIAL UNIT
<span style="display:inline-block; width:10px; height:10px; background-color:orange; border:1px solid black;"></span>	AMENITY SPACE
<span style="display:inline-block; width:10px; height:10px; background-color:lightgreen; border:1px solid black;"></span>	EXTERIOR SPACE

**ROOF TOP TERRACE**

1 : 200

**2,097 SQ.FT +/-**