

LEGEND

- MINIMUM PROTECTION ZONE
- EX. DECIDUOUS TREE TO REMAIN
- EX. DECIDUOUS TREE TO BE REMOVED
- TREE PRESERVATION FENCING
SEE DETAIL 1, TPD-1
- TREE GROUP
- TREE TAG / IDENTIFICATION

FOR EXISTING TREE IDENTIFICATION TABLE AND TREE PRESERVATION DETAILS REFER TO TPD-1

CLIENT
GEMINI CORP
6729 MONTROSE ROAD NIAGARA FALLS, ONTARIO

COPYRIGHT
This drawing has been prepared solely for the intended use, thus any reproduction or distribution for any purpose other than authorized by Arcadis is forbidden. Written dimensions shall have precedence over scaled dimensions. Contractors shall verify and be responsible for all dimensions and conditions on the job, and Arcadis shall be informed of any variations from the dimensions and conditions shown on the drawing. Shop drawings shall be submitted to Arcadis for general conformance before proceeding with fabrication.

Arcadis Professional Services (Canada) Inc.
Formerly IBI Group Professional Services (Canada) Inc.

No.	DESCRIPTION	DATE
1	ISSUED FOR DP	2023-11-24

NOT FOR CONSTRUCTION

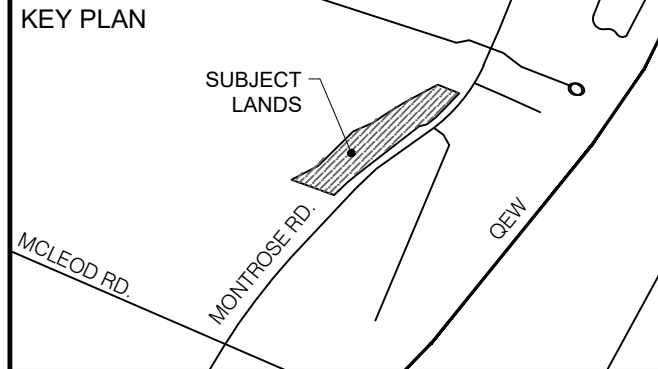

CONSULTANTS



PRIME CONSULTANT
ARCADIS
360 James Street North - Suite 200
Hamilton ON L8L 1H5 Canada
tel 905 546 1010
www.arcadis.com

PROJECT
MONTROSE DEVELOPMENT
6729 MONTROSE ROAD, NIAGARA FALLS, ON

PROJECT NO: 126319
DRAWN BY: TK
PROJECT MGR: CA
CHECKED BY: ZB
APPROVED BY: ZB

SHEET TITLE
TREE PROTECTION PLAN

SHEET NUMBER **ISSUE**
TPP-2 **1**

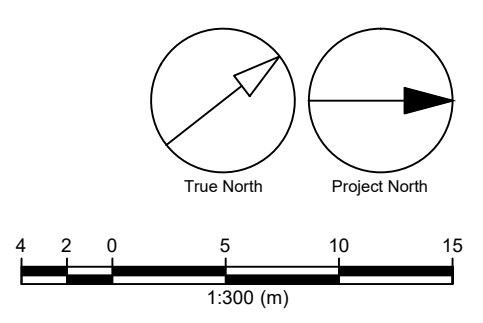

File Location: \\1128319_McLeod-Montrose\7_03_Design\05_Landscape\Content\126319-TPP1.dwg Last Saved: November 24, 2023, by Taylor Kemp Printed: Friday, November 24, 2023 3:24:20 PM by Taylor Kemp

EXISTING TREE IDENTIFICATION TABLE

TREE NO. OR GRP	BOTANICAL NAME	COMMON NAME	DBH (cm)	CONDITION ⁽²⁾	MINIMUM TREE PROTECTION ZONE (MTPZ) (m)	OWNERSHIP ⁽³⁾	IMPACTS OF DEVELOPMENT ⁽⁴⁾	RECOMMENDATION ⁽⁵⁾	COMMENTS ⁽⁶⁾
1	ROBINIA PSEUDOACACIA	BLACKLOCUST	15.0	F	2.4	S	IMPACTED: ROADWAY, SNOW STORAGE AREA	R	
2	JUGLANS NIGRA	EASTERN BLACK WALNUT	26.8	G	2.4	S	IMPACTED: DRIVEWAY, ROADWAY, CURB	R	
3	ROBINIA PSEUDOACACIA	BLACKLOCUST	12.0	F	2.4	S	IMPACTED: ROADWAY	R	
4	ROBINIA PSEUDOACACIA	BLACKLOCUST	14.5	F	2.4	S	IMPACTED: ROADWAY	R	
5	ROBINIA PSEUDOACACIA	BLACKLOCUST	10.0	G	1.8	S	IMPACTED: PROPOSED DRIVEWAY	R	
6	ROBINIA PSEUDOACACIA	BLACKLOCUST	12.0	F	2.4	S	IMPACTED: ROADWAY, DRIVEWAY	R	
7	JUGLANS NIGRA	EASTERN BLACK WALNUT	17.3	F	2.4	S	IMPACTED: SIDEWALK	R	
8	POPULUS DELTOIDES	EASTERN COTTONWOOD	16.5	F	2.4	S	IMPACTED: PROPOSED BUILDING, DRIVEWAY	R	
9	POPULUS DELTOIDES	EASTERN COTTONWOOD	15.5	G	2.4	S	IMPACTED: PROPOSED BUILDING	R	
10	SALIX SP.	WILLOW TREE	22.0	F	2.4	S	IMPACTED: PROPOSED BUILDING, DRIVEWAY	R	
11	ACER NEGUNDO	BOXELDER MAPLE	12.5	F	2.4	S	IMPACTED: PROPOSED BUILDING, DRIVEWAY	R	
12	POPULUS TREMULOIDES	QUAKING ASPEN	10.0	F	1.8	S	IMPACTED: ROADWAY, BUILDING, DRIVEWAY	R	
13	POPULUS TREMULOIDES	QUAKING ASPEN	15.5	G	2.4	S	IMPACTED: BUILDING	R	
14	POPULUS TREMULOIDES	QUAKING ASPEN	15.5	G	2.4	S	IMPACTED: PROPOSED GRADING	R	
1000	ACER SACCHARUM	SUGAR MAPLE	10.0	F	1.8	M	LIMITED: PROPOSED GRADING	P	
1001	ACER SACCHARUM	SUGAR MAPLE	10.0	G	1.8	M	LIMITED: PROPOSED GRADING	P	
1002	ROBINIA PSEUDOACACIA	BLACKLOCUST	26.5	F	2.4	M	IMPACTED: PROPOSED GRADING	R	
1003	ACER SACCHARUM	SUGAR MAPLE	9.0	F	1.8	M	LIMITED: PROPOSED GRADING	P	
1004	TILIA AMERICANA	BASSWOOD	11.5	F	2.4	M	IMPACTED: SITE ENTRANCE	R	
1005	(DEAD)		14.5	D		M	IMPACTED: 1.5m SIDEWALK	R	
1006	(DEAD)		35.0	D		M	IMPACTED: ENTRANCE DRIVEWAY, CURB	R	
1007	TILIA AMERICANA	BASSWOOD	10.0	G	1.8	M	LIMITED: PROPOSED GRADING	P	
1008	TILIA AMERICANA	BASSWOOD	10.0	F	1.8	M	LIMITED: PROPOSED GRADING	P	
1009	QUERCUS RUBRA	RED OAK	12.0	G	2.4	M	LIMITED: PROPOSED GRADING	P	
1010	ULMUS PUMILA	SIBERIAN ELM	13.0	F	2.4	M	IMPACTED: 1.5m SIDEWALK, GRADING	R	
1011	TILIA AMERICANA	BASSWOOD	8.0	F	1.8	M	LIMITED: PROPOSED GRADING	P	
1012	TILIA AMERICANA	BASSWOOD	6.5	G	1.8	M	LIMITED: PROPOSED GRADING	P	
1013	TILIA AMERICANA	BASSWOOD	5.5	F	1.8	M	LIMITED: PROPOSED GRADING	P	
1014	ACER SACCHARUM	SUGAR MAPLE	7.0	F	1.8	M	LIMITED: PROPOSED GRADING	P	
1015	ACER SACCHARUM	SUGAR MAPLE	5.0	G	1.8	M	LIMITED: PROPOSED GRADING	P	
1016	ACER SACCHARUM	SUGAR MAPLE	7.5	F	1.8	M	LIMITED: PROPOSED GRADING	P	
1017	MALUS SP.	APPLE TREE	22.5	F	2.4	M	IMPACTED: 1.5m SIDEWALK, GRADING	R	
1018	JUGLANS NIGRA	EASTERN BLACK WALNUT	35.0	F	2.4	M	IMPACTED: 1.5m SIDEWALK, GRADING	R	
1019	ROBINIA PSEUDOACACIA	BLACKLOCUST	15.5	F	2.4	M	IMPACTED: 1.5m SIDEWALK, GRADING	R	
1020	PYRUS SP.	PEAR TREE	14.0	G	2.4	M	IMPACTED: 1.5m SIDEWALK, GRADING	R	
1021	ACER SACCHARUM	SUGAR MAPLE	6.0	F	1.8	M	IMPACTED: PROPOSED SITE ACCESS	R	
1022	ACER SACCHARUM	SUGAR MAPLE	4.0	G	1.8	M	LIMITED: PROPOSED GRADING	P	
1023	ACER SACCHARUM	SUGAR MAPLE	6.5	F	1.8	M	LIMITED: PROPOSED GRADING	P	
1024	ACER SACCHARUM	SUGAR MAPLE	3.5	F	1.8	M	LIMITED: PROPOSED GRADING	P	
1025	(DEAD)		3.5	D		M	LIMITED: PROPOSED GRADING	P	
1026	(DEAD)		3.5	D		M	LIMITED: PROPOSED GRADING	P	
1027	ACER SACCHARUM	SUGAR MAPLE	4.0	F	1.8	M	LIMITED: PROPOSED GRADING	P	
1028	QUERCUS RUBRA	RED OAK	4.5	F	1.8	M	LIMITED: PROPOSED GRADING	P	
1029	QUERCUS RUBRA	RED OAK	7.5	F	1.8	M	LIMITED: PROPOSED GRADING	P	
1030	QUERCUS RUBRA	RED OAK	5.0	F	1.8	M	LIMITED: PROPOSED GRADING	P	
1031	QUERCUS RUBRA	RED OAK	8.5	F	1.8	M	LIMITED: PROPOSED GRADING	P	
1032	QUERCUS RUBRA	RED OAK	3.5	F	1.8	M	NONE	P	
1033	JUGLANS NIGRA	EASTERN BLACK WALNUT	31.0	F	2.4	A	NONE	P	
1034	RHAMNUS CATHARTICA	BUCKTHORN	17.5	F	2.4	A	IMPACTED: GRADING EASEMENT	R	
1035	ACER NEGUNDO	BOXELDER MAPLE	22.7	F	2.4	A	NONE	P	
1036	ACER NEGUNDO	BOXELDER MAPLE	12.5	F	2.4	A	IMPACTED: GRADING EASEMENT	R	
1037	ACER NEGUNDO	BOXELDER MAPLE	14.5	F	2.4	A	IMPACTED: GRADING EASEMENT	R	
1038	SALIX SP.	WILLOW TREE	19.5	G	2.4	A	IMPACTED: GRADING EASEMENT	R	
G1 a	ROBINIA PSEUDOACACIA	BLACKLOCUST	16.5	G	2.4	S	IMPACTED: PROPOSED SIDEWALK, ROADWAY	R	
b	ROBINIA PSEUDOACACIA	BLACKLOCUST	10.0	F	1.8	S	IMPACTED: PROPOSED SIDEWALK, ROADWAY	R	
c	ROBINIA PSEUDOACACIA	BLACKLOCUST	12.5	F	2.4	S	IMPACTED: PROPOSED SIDEWALK, ROADWAY	R	
G2 a	POPULUS DELTOIDES	EASTERN COTTONWOOD	18.0	F	2.4	S	NONE	P	
b	POPULUS DELTOIDES	EASTERN COTTONWOOD	26.5	G	2.4	S	LIMITED: GRADING EASEMENT	P	
c	POPULUS DELTOIDES	EASTERN COTTONWOOD	15.0	G	2.4	S	NONE	P	
d	POPULUS DELTOIDES	EASTERN COTTONWOOD	17.5	F	2.4	S	NONE	P	
e	POPULUS DELTOIDES	EASTERN COTTONWOOD	18.0	F	2.4	S	LIMITED: GRADING EASEMENT	P	
G3 a	ROBINIA PSEUDOACACIA	BLACKLOCUST	27.5	F	2.4	S	IMPACTED: GRADING EASEMENT	R	
b	ROBINIA PSEUDOACACIA	BLACKLOCUST	23.5	F	2.4	S	IMPACTED: GRADING EASEMENT	R	
G4 a	SALIX SP.	WILLOW TREE	14.0	F	2.4	S	IMPACTED: GRADING EASEMENT	R	
b	SALIX SP.	WILLOW TREE	19.5	F	2.4	S	IMPACTED: GRADING EASEMENT	R	
c	SALIX SP.	WILLOW TREE	21.5	F	2.4	S	IMPACTED: GRADING EASEMENT	R	
d	SALIX SP.	WILLOW TREE	31.0	F	2.4	S	IMPACTED: GRADING EASEMENT	R	
e	SALIX SP.	WILLOW TREE	14.5	F	2.4	S	IMPACTED: GRADING EASEMENT	R	
G5 a	SALIX SP.	WILLOW TREE	12.0	F	2.4	S	IMPACTED: GRADING EASEMENT	R	
b	SALIX SP.	WILLOW TREE	10.0	F	1.8	S	IMPACTED: GRADING EASEMENT	R	
c	SALIX SP.	WILLOW TREE	12.5	F	2.4	S	IMPACTED: GRADING EASEMENT	R	
G6 a	POPULUS DELTOIDES	EASTERN COTTONWOOD	15.0	G	2.4	S	IMPACTED: ROADWAY, CURB	R	
b	POPULUS DELTOIDES	EASTERN COTTONWOOD	12.0	G	2.4	S	IMPACTED: ROADWAY, DRIVEWAY, CURB	R	
G7 a	POPULUS TREMULOIDES	EASTERN COTTONWOOD	12.5	G	2.4	S	IMPACTED: ROADWAY, CURB	R	
b	POPULUS TREMULOIDES	EASTERN COTTONWOOD	15.5	G	2.4	S	IMPACTED: ROADWAY, CURB	R	

EXISTING TREE IDENTIFICATION TABLE

TREE NO. OR GRP	BOTANICAL NAME	COMMON NAME	DBH (cm)	CONDITION ⁽²⁾	MINIMUM TREE PROTECTION ZONE (MTPZ) (m)	OWNERSHIP ⁽³⁾	IMPACTS OF DEVELOPMENT ⁽⁴⁾	RECOMMENDATION ⁽⁵⁾	COMMENTS ⁽⁶⁾
G100 a	ROBINIA PSEUDOACACIA	BLACKLOCUST	11.0	F	2.4	M	IMPACTED: 1.5m SIDEWALK, GRADING	R	
b	ROBINIA PSEUDOACACIA	BLACKLOCUST	12.0	F	2.4	M	IMPACTED: 1.5m SIDEWALK, GRADING	R	
c	ROBINIA PSEUDOACACIA	BLACKLOCUST	10.0	F	1.8	M	IMPACTED: 1.5m SIDEWALK, GRADING	R	
d	ROBINIA PSEUDOACACIA	BLACKLOCUST	11.4	F	2.4	M	IMPACTED: GRADING	R	
e	ROBINIA PSEUDOACACIA	BLACKLOCUST	19.0	F	2.4	M	IMPACTED: 1.5m SIDEWALK, GRADING	R	
G101 a	QUERCUS RUBRA	RED OAK	11.0	G	2.4	M	LIMITED: PROPOSED GRADING	P	
b	QUERCUS RUBRA	RED OAK	10.0	F	1.8	M	LIMITED: PROPOSED GRADING	P	
c	QUERCUS RUBRA	RED OAK	6.5	F	1.8	M	LIMITED: PROPOSED GRADING	P	
d	QUERCUS RUBRA	RED OAK	7.5	F	1.8	M	LIMITED: PROPOSED GRADING	P	
G102 a	ROBINIA PSEUDOACACIA	BLACKLOCUST	19.0	F	2.4	M	IMPACTED: 1.5m SIDEWALK, GRADING	R	
b	ROBINIA PSEUDOACACIA	BLACKLOCUST	21.0	G	2.4	M	IMPACTED: 1.5m SIDEWALK, GRADING	R	
c	ROBINIA PSEUDOACACIA	BLACKLOCUST	13.5	F	2.4	M	IMPACTED: 1.5m SIDEWALK, GRADING	R	
d	ROBINIA PSEUDOACACIA	BLACKLOCUST	11.5	F	2.4	M	IMPACTED: 1.5m SIDEWALK, GRADING	R	
e	ROBINIA PSEUDOACACIA	BLACKLOCUST	22.0	F	2.4	M	IMPACTED: 1.5m SIDEWALK, GRADING	R	
f	ROBINIA PSEUDOACACIA	BLACKLOCUST	19.0	F	2.4	M	IMPACTED: 1.5m SIDEWALK, GRADING	R	
g	ROBINIA PSEUDOACACIA	BLACKLOCUST	22.0	F	2.4	M	IMPACTED: 1.5m SIDEWALK, GRADING	R	
h	ROBINIA PSEUDOACACIA	BLACKLOCUST	13.0	G	2.4	M	IMPACTED: 1.5m SIDEWALK, GRADING	R	
i	ROBINIA PSEUDOACACIA	BLACKLOCUST	22.0	G	2.4	M	IMPACTED: 1.5m SIDEWALK, GRADING	R	
j	ROBINIA PSEUDOACACIA	BLACKLOCUST	10.0	F	1.8	M	IMPACTED: 1.5m SIDEWALK, GRADING	R	
k	ROBINIA PSEUDOACACIA	BLACKLOCUST	14.0	F	2.4	M	IMPACTED: 1.5m SIDEWALK, GRADING	R	
l	ROBINIA PSEUDOACACIA	BLACKLOCUST	15.5	G	2.4	M	IMPACTED: GRADING	R	
m	ROBINIA PSEUDOACACIA	BLACKLOCUST	15.5	F	2.4	M	IMPACTED: 1.5m SIDEWALK, GRADING	R	
n	ROBINIA PSEUDOACACIA	BLACKLOCUST	14.5	G	2.4	M	IMPACTED: 1.5m SIDEWALK, GRADING	R	
o	ROBINIA PSEUDOACACIA	BLACKLOCUST	12.5	F	2.4	M	IMPACTED: 1.5m SIDEWALK, GRADING	R	
p	ROBINIA PSEUDOACACIA	BLACKLOCUST	13.5	G	2.4	M	IMPACTED: GRADING	R	
q	ROBINIA PSEUDOACACIA	BLACKLOCUST	12.0	G	2.4	M	IMPACTED: GRADING	R	
r	ROBINIA PSEUDOACACIA	BLACKLOCUST	12.5	F	2.4	M	IMPACTED: GRADING	R	
s	ROBINIA PSEUDOACACIA	BLACKLOCUST	19.5	F	2.4	M	IMPACTED: 1.5m SIDEWALK, GRADING	R	
t	ROBINIA PSEUDOACACIA	BLACKLOCUST	14.5	F	2.4	M	IMPACTED: 1.5m SIDEWALK, GRADING	R	
u	ROBINIA PSEUDOACACIA	BLACKLOCUST	13.5	F	2.4	M	IMPACTED: 1.5m SIDEWALK, GRADING	R	
v	ROBINIA PSEUDOACACIA	BLACKLOCUST	13.5	F	2.4	M	IMPACTED: 1.5m SIDEWALK, GRADING	R	
w	ROBINIA PSEUDOACACIA	BLACKLOCUST	16.3	G	2.4	M	IMPACTED: 1.5m SIDEWALK, GRADING	R	
x	ROBINIA PSEUDOACACIA	BLACKLOCUST	14.0	G	2.4	M	IMPACTED: 1.5m SIDEWALK, GRADING	R	
y	ROBINIA PSEUDOACACIA	BLACKLOCUST	16.9	G	2.4	M	IMPACTED: 1.5m SIDEWALK, GRADING	R	
z	ROBINIA PSEUDOACACIA	BLACKLOCUST	15.5	F	2.4	M	IMPACTED: 1.5m SIDEWALK, GRADING	R	
G103 a	ROBINIA PSEUDOACACIA	BLACKLOCUST	13.0	F	2.4	M	IMPACTED: 1.5m SIDEWALK, GRADING	R	
b	ROBINIA PSEUDOACACIA	BLACKLOCUST	18.5	F	2.4	M	IMPACTED: 1.5m SIDEWALK, GRADING	R	
c	ROBINIA PSEUDOACACIA	BLACKLOCUST	20.0	F	2.4	M	IMPACTED: 1.5m SIDEWALK, GRADING	R	
d	ROBINIA PSEUDOACACIA	BLACKLOCUST	15.0	G	2.4	M	IMPACTED: 1.5m SIDEWALK, GRADING	R	
e	ROBINIA PSEUDOACACIA	BLACKLOCUST	14.0	G	2.4	M	IMPACTED: 1.5m SIDEWALK, GRADING	R	
f	ROBINIA PSEUDOACACIA	BLACKLOCUST	16.5	F	2.4	M	IMPACTED: 1.5m SIDEWALK, GRADING	R	
g	ROBINIA PSEUDOACACIA	BLACKLOCUST	13.5	G	2.4	M	IMPACTED: 1.5m SIDEWALK, GRADING	R	
h	ROBINIA PSEUDOACACIA	BLACKLOCUST	18.0	F	2.4	M	IMPACTED: 1.5m SIDEWALK, GRADING	R	
i	ROBINIA PSEUDOACACIA	BLACKLOCUST	25.5	G	2.4	M	IMPACTED: 1.5m SIDEWALK, GRADING	R	

- (1) Trees recommended to be PRESERVED in SHADED BOXES
 (2) Condition: Good (G) - dead branches less than 10%; signs of good compartmentalization on any wounds; no structural defects
 Fair (F) - 10-30% dead branches; size or occurrence of wounds present some concerns; minor structural defects
 Poor (P) - more than 30% dead branches; weak compartmentalization; early leaf drop; presence of insects or disease; major structural defects
 Dead (D) - tree shows no signs of life
 (3) Comments based on tree health, condition, structure and existing physical constraints; recommendations for pruning or decomposition.
 (4) Ownership: S - Subject Property
 A - Adjacent Property
 M - Municipal Property
 (5) Recommendation: Preserve, Remove, Transplant
 (6) Rationale: - Reason(s) for removal based on impact of construction
 NONE - no construction activity occurs at or within the dripline of a tree, but is not likely to lead to tree death in the short term (5-10 years) if precautionary measures are taken; this may require root pruning.
 LIMITED: XXX - construction activity (XXX = structures, fencing, trenching, grading, etc) which requires the direct removal of a tree or occurs within a significant portion of the canopy/foot zone, such that the activity will significantly affect tree health leading to death in the short term

1 EXISTING TREE IDENTIFICATION TABLE
 TPD-1 N.T.S

CLIENT
GEMINI CORP

6729 MONTROSE ROAD NIAGARA FALLS,
 ONTARIO

COPYRIGHT
 This drawing has been prepared solely for the intended use, thus any reproduction or distribution for any purpose other than authorized by Arcadis is forbidden. Written dimensions shall have precedence over scaled dimensions. Contractors shall verify and be responsible for all dimensions and conditions on the job, and Arcadis shall be informed of any variations from the dimensions and conditions shown on the drawing. Shop drawings shall be submitted to Arcadis for general conformance before proceeding with fabrication.

Arcadis Professional Services (Canada) Inc.
 Formerly B Group Professional Services (Canada) Inc.

No.	DESCRIPTION	DATE
1	ISSUED FOR DP	2023-11-24

NOT FOR CONSTRUCTION

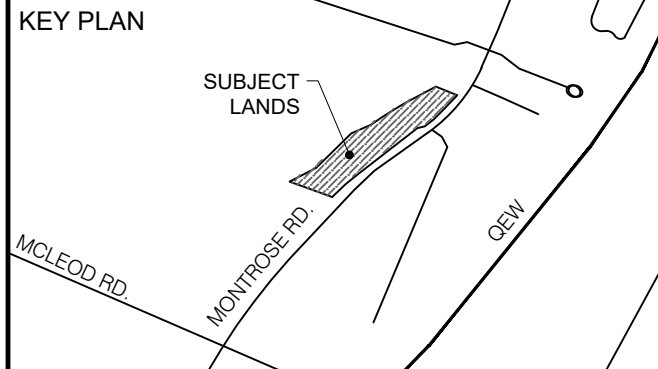

CONSULTANTS

SEAL



PRIME CONSULTANT
ARCADIS
 360 James Street North - Suite 200
 Hamilton ON L8L 1H5 Canada
 tel 905 546 1010
 www.arcadis.com

PROJECT
MONTROSE DEVELOPMENT
 6729 MONTROSE ROAD, NIAGARA FALLS,
 ON

PROJECT NO:
 126319
DRAWN BY: TK
CHECKED BY: ZB
PROJECT MGR: CA
APPROVED BY: ZB

SHEET TITLE
TREE PROTECTION PLAN

SHEET NUMBER TPD-1 **ISSUE** 1

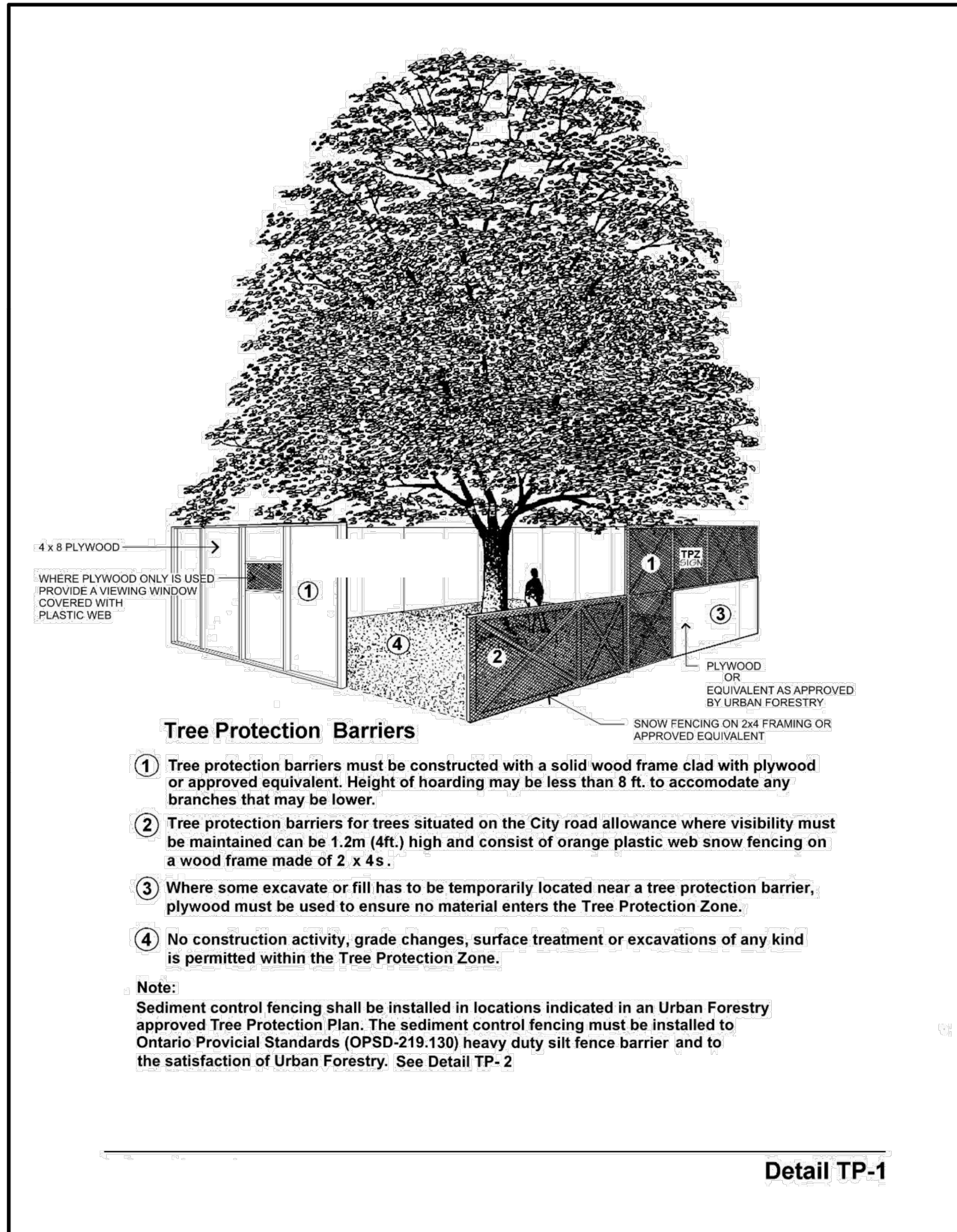

Tree Protection Barriers

- ① Tree protection barriers must be constructed with a solid wood frame clad with plywood or approved equivalent. Height of hoarding may be less than 8 ft. to accommodate any branches that may be lower.
- ② Tree protection barriers for trees situated on the City road allowance where visibility must be maintained can be 1.2m (4ft.) high and consist of orange plastic web snow fencing on a wood frame made of 2 x 4s.
- ③ Where some excavate or fill has to be temporarily located near a tree protection barrier, plywood must be used to ensure no material enters the Tree Protection Zone.
- ④ No construction activity, grade changes, surface treatment or excavations of any kind is permitted within the Tree Protection Zone.

Note:
Sediment control fencing shall be installed in locations indicated in an Urban Forestry approved Tree Protection Plan. The sediment control fencing must be installed to Ontario Provincial Standards (OPSD-219.130) heavy duty silt fence barrier and to the satisfaction of Urban Forestry. See Detail TP-2

Detail TP-1

Figure 4: Detail TP-1

1 TREE PRESERVATION FENCING
TPD-2 N.T.S

CLIENT
GEMINI CORP

6729 MONTROSE ROAD NIAGARA FALLS,
ONTARIO

COPYRIGHT
This drawing has been prepared solely for the intended use, thus any reproduction or distribution for any purpose other than authorized by Arcadis is forbidden. Written dimensions shall have precedence over scaled dimensions. Contractors shall verify and be responsible for all dimensions and conditions on the job, and Arcadis shall be informed of any variations from the dimensions and conditions shown on the drawing. Shop drawings shall be submitted to Arcadis for general conformance before proceeding with fabrication.

Arcadis Professional Services (Canada) Inc.
Formerly BI Group Professional Services (Canada) Inc.

No.	DESCRIPTION	DATE
1	ISSUED FOR DP	2023-11-24

NOT FOR CONSTRUCTION

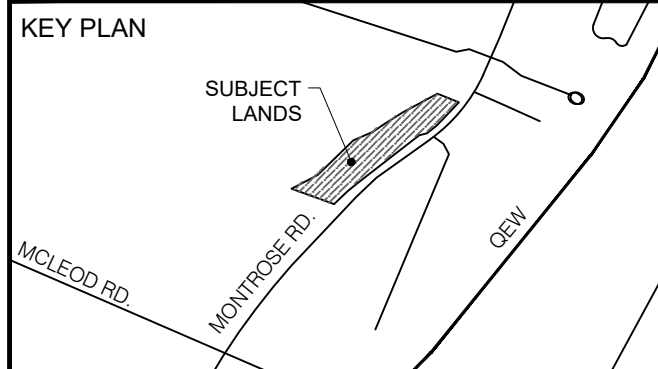

CONSULTANTS

SEAL

PRIME CONSULTANT
ARCADIS
360 James Street North - Suite 200
Hamilton ON L8L 1H5 Canada
tel 905 546 1010
www.arcadis.com

PROJECT
MONTROSE DEVELOPMENT

6729 MONTROSE ROAD, NIAGARA FALLS,
ON

PROJECT NO:
126319
DRAWN BY: TK
PROJECT MGR: CA
CHECKED BY: ZB
APPROVED BY: ZB

SHEET TITLE
TREE PROTECTION PLAN

SHEET NUMBER
TPD-2
ISSUE
1

File Location: J:\126319_McLeod-Montrose\0_Design\05_Landscape\Content\126319-TPP1.dwg | Last Saved: November 24, 2023, by Taylor Kemp | Plotted: Friday, November 24, 2023 2:49:21 PM by Taylor Kemp | 1/1