

PROPOSED MASTER PLAN PLANTING SCHEDULE

KEY	BOTANICAL NAME	COMMON NAME	CAL.	COND.	MATURE HEIGHT (m)	MATURE SPREAD (m)	O.C. SPACING (m)	QNTY.	
DECIDUOUS TREES									
AF	Acer x freemanii 'Armstrong'	Armstrong Freeman Maple	60 mm	W.B.	16.0	6.0	6.0	3	
AH	Aesculus hippocastanum	Horsechestnut	60 mm	W.B.	18.0	15.0	10.0	7	
CC	Cercis canadensis	Eastern Redbud	60 mm	W.B.	10.0	7.0	6.0	8	
CJ	Cercidiphyllum japonicum	Katsura	60 mm	W.B.	15.0	5.0	5.0	3	
GB	Ginkgo biloba 'Princeton Sentry'	Princeton Sentry Ginkgo	60 mm	W.B.	15.0	6.0	6.0	2	
GD	Gymnocladus dioica	Kentucky Coffee Tree	60 mm	W.B.	17.0	13.0	10.0	9	
GT	Gleditsia tracanthos var. inermis	Thornless Honey Locust	60 mm	W.B.	17.0	12.0	10.0	11	
CV	Ostrya virginiana	Ironwood	60 mm	W.B.	10.0	7.0	6.0	8	
PA	Platanus occidentalis	Sycamore	60 mm	W.B.	30.0	25.0	10.0	5	
QF	Quercus robur 'Fastigata'	English Columnar Oak	60 mm	W.B.	16.0	6.0	6.0	10	
OM	Quercus macrocarpa	Bur Oak	60 mm	W.B.	20.0	13.0	10.0	9	
TC	Tilia cordata	Littleleaf Linden	60 mm	W.B.	21.0	12.0	10.0	8	
TOTAL								83	
CONIFEROUS TREES									
JV	Juniperus virginiana	Eastern Red Cedar	250cm	W.B.	6.0	2.0	1.5	20	
PP	Picea pungens	Blue Spruce	250cm	W.B.	18.0	6.0	6.0	9	
PS	Pinus strobus	Eastern White Pine	250cm	W.B.	20.0	8.0	7.0	4	
TOTAL								33	
ORNAMENTAL TREES									
AG	Acer Griseum	Paperbark Maple	Clump	175 cm	W.B.	6.0	5.0	6.0	4
CK	Cornus kousa 'Milky Way'	Milky Way Dogwood	Clump	175 cm	W.B.	6.0	6.0	6.0	6
PC	Pyrus calleryana 'Chanticleer'	Callery Pear	60 mm	W.B.	10.0	4.0	4.0	6	
TOTAL								16	
SHRUBS									
Bg	Buxus x Green Velvet	Green Velvet Boxwood	50 cm	3 gal	0.8	0.8	0.7	88	
Cs	Cornus sericea	Red Osier Dogwood	50 cm	3 gal	1.75	2.0	1.2	18	
Ha	Hydrangia arborescens 'Annabelle'	Annabelle Smooth Hydrangea	50 cm	3 gal	1.5	1.5	1.2	26	
Po	Physocarpus opulifolius 'Diabolo'	Diabolo Ninebark	50 cm	3 gal	1.75	1.5	1.2	19	
Tcn	Taxus canadensis	Canadian Yew	50 cm	3 gal	0.6	0.8	0.7	80	
TOTAL								231	
PERENNIALS									
as	Andropogon scoparius/Schizachyrium scoparium	Little Bluestem	1 gal	0.9	1.0	1.0	122		
ca	Calamagrostis x acutifolia 'Karl Foerster'	Feather Reed Grass	1 gal	1.2	1.0	1.0	71		
la	Lavandula angustifolia 'Buena Vista'	English Lavender	1 gal	0.5	0.5	0.5	211		
lm	Liriope muscari 'Variegata'	Variegated Lily Turf	1 gal	0.5	0.3	0.2	700		
TOTAL								1104	

LANDSCAPE NOTES:

- ALL WORK TO BE CARRIED OUT IN ACCORDANCE WITH BY-LAWS AND CODES HAVING JURISDICTION OVER SITE LOCATION.
- COMPLETE ALL WORK TO THE SATISFACTION OF THE LANDSCAPE ARCHITECT.
- REPORT ANY CHANGES, DISCREPANCIES OR SUBSTITUTIONS TO THE LANDSCAPE ARCHITECT FOR REVIEW. OBTAIN APPROVAL FROM THE LANDSCAPE ARCHITECT BEFORE PROCEEDING.
- IT IS THE CONTRACTOR'S RESPONSIBILITY TO DETERMINE EXISTING SERVICE LOCATIONS.
- EXACT LOCATIONS OF PLANT MATERIAL WILL BE DETERMINED BY PLACEMENT OF SITE SERVICES SUCH AS HYDRO VAULTS, METERS, UTILITIES ROOF RAIN WATER LEADERS, DRIVEWAYS, LIGHT STANDARDS, ETC.
- ALL PLANT MATERIAL LOCATIONS TO BE STAKED OR MARKED OUT AND APPROVED BY LANDSCAPE ARCHITECT PRIOR TO INSTALLATION.
- SUPPLY ALL PLANT MATERIAL IN ACCORDANCE WITH THE CANADIAN STANDARDS FOR NURSERY STOCK (8th Ed.).
- INSTALL PLANT MATERIAL ACCORDING TO DETAILS SHOWN.
- DISTURBED SOIL AREAS AROUND TREES AND SHRUBS ARE TO BE COVERED WITH SHREDDED CONIFER BARK MULCH SUCH AS 'CANADA RED' OR 'GRO-BARK' 3PM MULCH, OR APPROVED EQUIVALENT. ALTERNATIVE MULCHES MUST BE APPROVED BY THE LANDSCAPE ARCHITECT.
- CONTRACTOR TO UTILIZE LAYOUT DIMENSIONS WHERE PROVIDED.
- PROVIDE PLANTING BED AREA AS NOTED ON THE DRAWING OR TO ACCOMMODATE MATURE SIZE OF PLANT MATERIAL.
- ALL SUPPORT SYSTEMS MUST BE REMOVED BY THE CONTRACTOR AT TIME OF FINAL ACCEPTANCE. NO EXTRAS WILL BE PAID TO COMPLETE THIS WORK.
- SUPPLY AND PLACE TOPSOIL IN ACCORDANCE WITH OPSS 802 TO A MINIMUM DEPTH OF 150mm UNLESS OTHERWISE SPECIFIED.
- SUPPLY AND PLACE SOD IN ACCORDANCE WITH OPSS 803 UNLESS OTHERWISE SPECIFIED.
- SUPPLY AND PLACE SEED IN ACCORDANCE WITH OPSS 804 UNLESS OTHERWISE SPECIFIED. ALL 5:1 OR GREATER SLOPES TO BE SEEDED WITH TACIFIER. CONTRACTOR TO PROVIDE NECESSARY EROSION CONTROL PROTECTION AS REQUIRED TO ENSURE SOIL STABILIZATION AND PROPER SEED GERMINATION.
- ALL DIMENSIONS IN METRES UNLESS OTHERWISE NOTED.
- IF DISCREPANCIES ARISE BETWEEN PLANT MATERIAL COUNT SHOWN ON DRAWING AND PLANT LIST, THE DRAWING SHALL BE CONSIDERED CORRECT.
- CONTRACTOR TO PROVIDE MINIMUM TWO (2) YEAR WARRANTY FROM DATE ACCEPTED ON ALL WORK UNLESS OTHERWISE SPECIFIED.
- ANY SITE PLAN OR GRADING AND SERVICING SHOWN IS FOR INFORMATION ONLY. REFER TO APPROVED DRAWINGS.
- NOT FOR CONSTRUCTION UNLESS STAMPED, SIGNED AND DATED BY LANDSCAPE ARCHITECT.
- DRAWINGS NOT TO BE REPRODUCED WITHOUT WRITTEN CONSENT FROM LANDSCAPE ARCHITECT.
- APPROVAL OF LANDSCAPE PLAN TO BE OBTAINED FROM MUNICIPALITY.
- FOR GRADING AND SERVICING INFORMATION REFER TO THE ENGINEERS DRAWINGS.
- FOR LIGHTING INFORMATION AND POWER DISTRIBUTION REFER TO THE ELECTRICAL DRAWINGS.

SEED MIX:

CONTRACTOR TO SOW NURSE CROP AVENA SATIVA OVER ENTIRE AREA TO BE SEEDED AT A RATE OF 25KG/ HECTARE.
8145 - RURAL ONTARIO ROADSIDE MIXTURE BY OSC SEEDS. TO BE SEEDED AT A RATE OF 25KG PER HA. SEED MIX TO INCLUDE:

Black Eyed Susan (Rutbeckia hirta)	2%
Blue Vervain (Verbena hastata)	2%
Bonset (Eupatorium perfoliatum)	1%
Canada Wild Rye (Elymus canadensis)	24%
Dense Blazing Star (Liatris spicata)	1%
Foxglove/Beard Tongue (Penstemon digitalis)	2%
Indian grass (Sorghastrum nutans)	20%
Little Blue Stem (Schizachyrium scoparium)	30%
New England Aster (Aster novae-angliae)	2%
Showy Tick Trefoil (Desmodium canadense)	3%
Virginia Wild Rye (Elymus virginicus)	22%
Wild Bergamot (Monarda fistulosa)	1%

LEGEND

	TOPSOIL AND SOD AS SPECIFIED MINIMUM 150mm TOPSOIL DEPTH		PROPOSED DECIDUOUS ORNAMENTAL TREE
	TOPSOIL AND SEED AS SPECIFIED MINIMUM 150mm TOPSOIL DEPTH		PROPOSED DECIDUOUS SHRUBS
	CONCRETE PAVING		PROPOSED BROAD-LEAF EVERGREEN SHRUBS
	EXISTING DECIDUOUS TREE TO REMAIN		PROPOSED PERENNIALS
	PROPOSED DECIDUOUS SHADE TREE		PROPOSED ORNAMENTAL GRASSES
	PROPOSED CONIFEROUS TREE		1.8M NOISE BARRIER FENCE. SEE DETAIL 6/D/1
			PLANT SPECIES QUANTITY
			DETAIL NUMBER SHEET NUMBER

CLIENT
GEMINI CORP

6729 MONTROSE ROAD
NIAGARA FALLS, ONTARIO

COPYRIGHT
This drawing has been prepared solely for the intended use, thus any reproduction or distribution for any purpose other than authorized by IBI Group is forbidden. Written dimensions shall have precedence over scaled dimensions. Contractors shall verify and be responsible for all dimensions and conditions on the job, and IBI Group shall be informed of any variations from the dimensions and conditions shown on the drawing. Shop drawings shall be submitted to IBI Group for general concurrence before proceeding with fabrication.
IBI Group Professional Services (Canada) Inc.
is a member of the IBI Group of companies.

ISSUES

No.	DESCRIPTION	DATE
1	ISSUED FOR SPA	2023-04-04

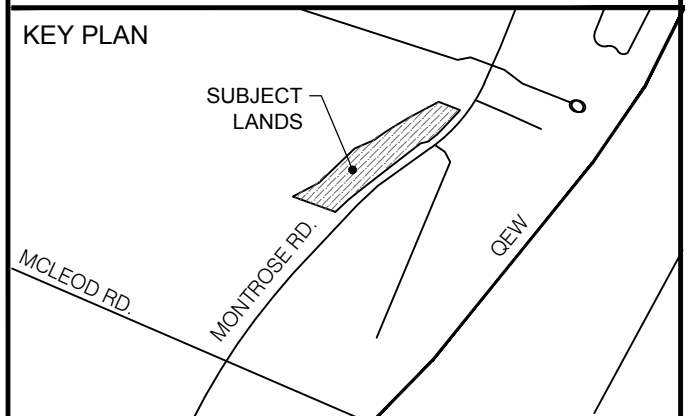

CONSULTANTS

NOT FOR CONSTRUCTION



PRIME CONSULTANT
IBI GROUP
Suite 200 - 360 James Street North
Hamilton ON L8L 1H8 Canada
tel: 905 546 1010 fax: 905 546 1011
ibigroup.com

PROJECT
MONTROSE DEVELOPMENT

6729 MONTROSE ROAD,
NIAGARA FALLS, ON

PROJECT NO:
126319
DRAWN BY:
LG
PROJECT MGR:
CA
CHECKED BY:
TO
APPROVED BY:
TO

SHEET TITLE
LANDSCAPE PLAN

SHEET NUMBER
L1.0
ISSUE
1

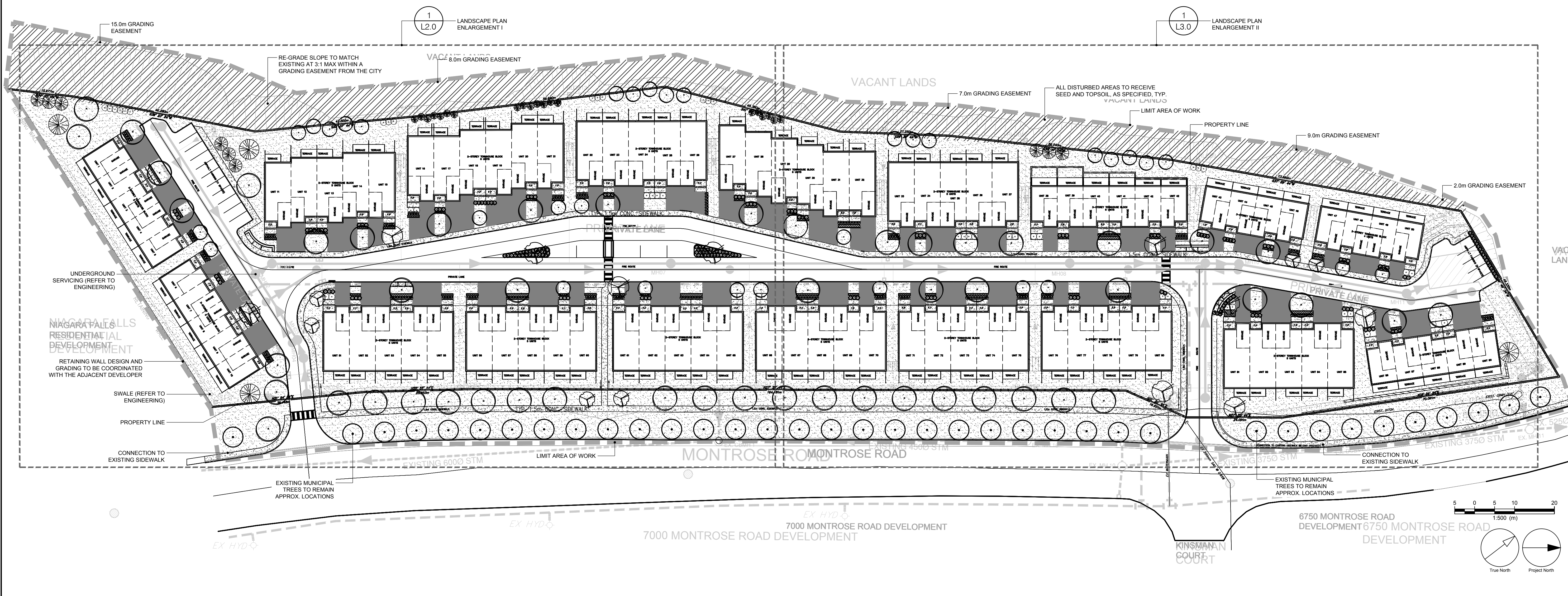

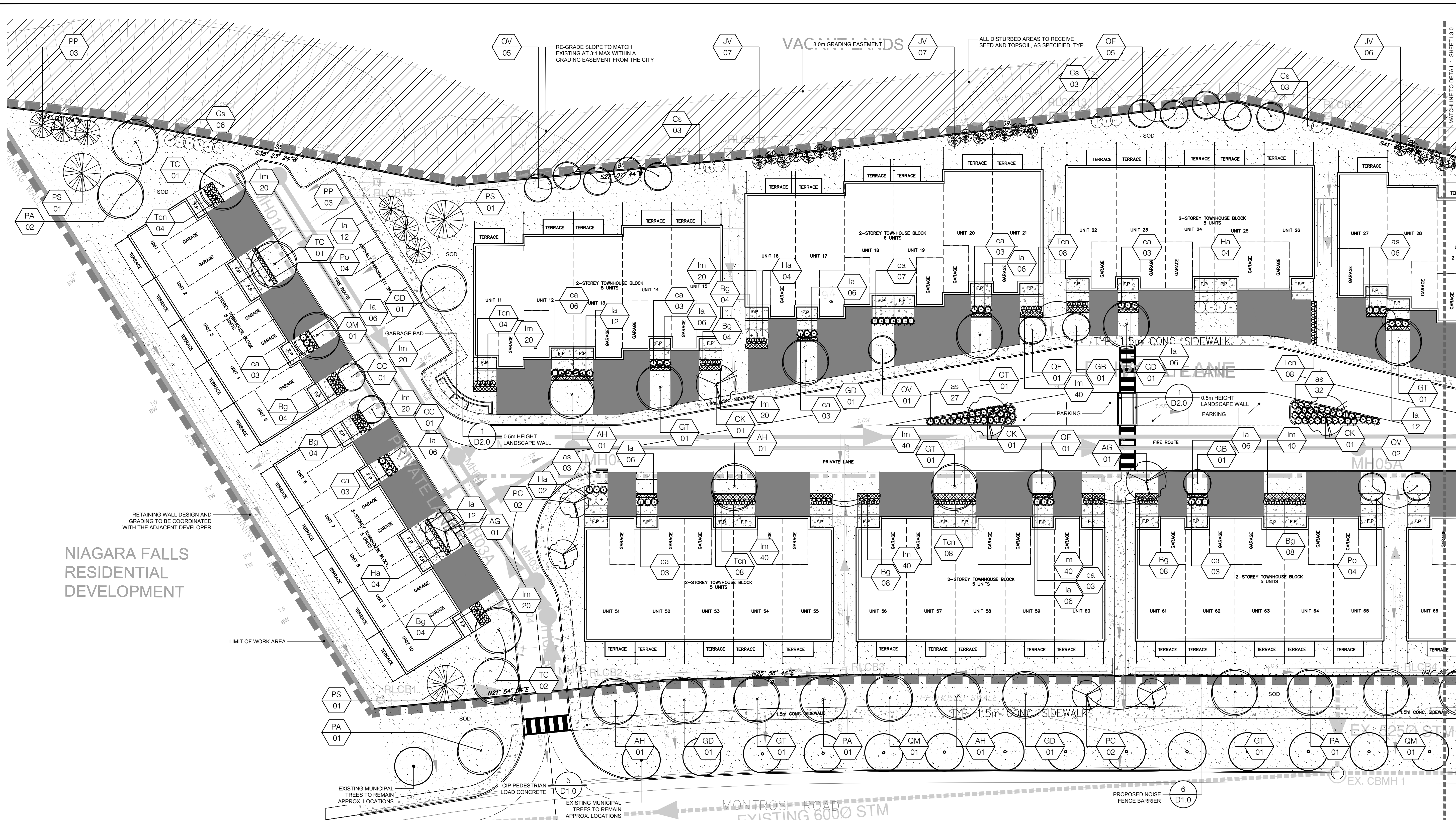

NIAGARA FALLS RESIDENTIAL DEVELOPMENT

LEGEND

- TOPSOIL AND SOD AS SPECIFIED MINIMUM 150mm TOPSOIL DEPTH
- TOPSOIL AND SEED AS SPECIFIED MINIMUM 150mm TOPSOIL DEPTH
- CONCRETE PAVING
- EXISTING DECIDUOUS TREE TO REMAIN
- PROPOSED DECIDUOUS SHADE TREE
- PROPOSED CONIFEROUS TREE
- PROPOSED DECIDUOUS ORNAMENTAL TREE
- PROPOSED DECIDUOUS SHRUBS
- PROPOSED BROAD-LEAF EVERGREEN SHRUBS
- PROPOSED PERENNIALS
- PROPOSED ORNAMENTAL GRASSES
- 1.8M NOISE BARRIER FENCE. SEE DETAIL 6/D1.0
- PLANT SPECIES QUANTITY
- DETAIL NUMBER SHEET NUMBER

PROPOSED PLANTING SCHEDULE - L2.0

KEY	BOTANICAL NAME	COMMON NAME	CAL.	COND.	MATURE HEIGHT (m)	MATURE SPREAD (m)	O.C. SPACING (m)	QNTY.	
DECIDUOUS TREES									
AH	Aesculus hippocastanum	Horsechestnut	60 mm	W.B.	18.0	15.0	10.0	3	
CC	Cercis canadensis	Eastern Redbud	60 mm	W.B.	10.0	7.0	6.0	2	
GB	Ginkgo biloba Princeton Sentry	Princeton Sentry Ginkgo	60 mm	W.B.	15.0	6.0	6.0	2	
GD	Gymnocladus dioica	Kentucky Coffee Tree	60 mm	W.B.	17.0	13.0	10.0	5	
GT	Gleditsia triacanthos var. inermis	Thornless Honey Locust	60 mm	W.B.	17.0	12.0	10.0	5	
OV	Ostrya virginiana	Ironwood	60 mm	W.B.	10.0	7.0	6.0	8	
PA	Platanus occidentalis	Sycamore	60 mm	W.B.	30.0	25.0	10.0	5	
QF	Quercus robur 'Fastigiat'	English Columnar Oak	60 mm	W.B.	16.0	6.0	6.0	7	
QM	Quercus macrocarpa	Bur Oak	60 mm	W.B.	20.0	13.0	10.0	3	
TC	Tilia cordata	Littleleaf Linden	60 mm	W.B.	21.0	12.0	10.0	4	
								TOTAL	44
CONIFEROUS TREES									
JV	Juniperus virginiana	Eastern Red Cedar	250cm	W.B.	6.0	2.0	1.5	20	
PP	Picea pungens	Blue Spruce	250cm	W.B.	18.0	6.0	6.0	6	
PS	Pinus strobus	Eastern White Pine	250cm	W.B.	20.0	8.0	7.0	3	
								TOTAL	29

KEY	BOTANICAL NAME	COMMON NAME	CAL.	COND.	MATURE HEIGHT (m)	MATURE SPREAD (m)	O.C. SPACING (m)	QNTY.	
ORNAMENTAL TREES									
AG	Acer Griseum	Paperbark Maple	Clump	175 cm	W.B.	6.0	5.0	6.0	2
CK	Cornus kousa 'Milky Way'	Milky Way Dogwood	Clump	175 cm	W.B.	6.0	6.0	6.0	3
PC	Pyrus calleryana 'Chanticleer'	Galleary Pear	Clump	60 mm	W.B.	10.0	4.0	4.0	4
								TOTAL	9
SHRUBS									
Bg	Buxus x Green Velvet	Green Velvet Boxwood	3 gal	50 cm	0.8	0.8	0.7	44	
Cs	Cornus sericea	Red Osier Dogwood	3 gal	50 cm	1.75	2.0	1.2	15	
Ha	Hydrangea arborescens 'Annabelle'	Annabelle Smooth Hydrangea	3 gal	50 cm	1.5	1.5	1.2	14	
Po	Physocarpus opulifolius 'Diabolo'	Diabolo Ninebark	3 gal	50 cm	1.75	1.5	1.2	8	
Tcn	Taxus canadensis	Canadian Yew	3 gal	50 cm	0.6	0.8	0.7	40	
								TOTAL	121
PERENNIALS									
as	Andropogon scoparius/Schizachyrium scoparium	Little Bluestem	1 gal	0.9	1.0	1.0	1.0	68	
ca	Calamagrostis x acutifolia 'Karl Foerster'	Feather Reed Grass	1 gal	1.2	1.0	1.0	40		
la	Lavandula angustifolia 'Buena Vista'	English lavender	1 gal	0.5	0.5	0.5	102		
lm	Liriope muscari 'Variegata'	Variegated Lily Turf	1 gal	0.5	0.3	0.2	380		
								TOTAL	590

SEED MIX:
 CONTRACTOR TO SOW NURSE CROP AVENA SATIVA OVER ENTIRE AREA TO BE SEED AT A RATE OF 20kg/HECTARE
 8145 - RURAL ONTARIO ROADSIDE MIXTURE BY OSC SEEDS TO BE SEED AT A RATE OF 25KG PER HA. SEED MIX TO INCLUDE:

- Black Eyed Susan (Rudbeckia hirta) 2%
- Blue Vervain (Verbena hastata) 2%
- Bonset (Equisetum perfoliatum) 1%
- Canada Wild Rye (Elymus canadensis) 24%
- Dense Blazing Star (Liatris spicata) 1%
- Foxglove/Beard Tongue (Penstemon digitalis) 2%
- Indian grass (Sorghastrum nutans) 20%
- Little Blue Stem (Schizachyrium scoparium) 20%
- New England Aster (Aster novae-angliae) 2%
- Showy Tick Trefoil (Desmodium canadense) 3%
- Virginia Wild Rye (Elymus virgatum) 22%
- Wild Bergamot (Monarda fistulosa) 1%

CLIENT
GEMINI CORP

**6729 MONTROSE ROAD
NIAGARA FALLS, ONTARIO**

COPYRIGHT
This drawing has been prepared solely for the intended use. Any reproduction or distribution for any purpose other than authorized by IBI Group is forbidden. Written dimensions shall have precedence over scaled dimensions. Contractors shall verify and be responsible for all dimensions and conditions on the job, and IBI Group shall be informed of any variations from the dimensions and conditions shown on the drawing. Shop drawings shall be submitted to IBI Group for general concurrence before proceeding with fabrication.

IBI Group Professional Services (Canada) Inc.
is a member of the IBI Group of companies.

ISSUES

No.	DESCRIPTION	DATE
1	ISSUED FOR SPA	2023-04-04

KEY PLAN
SUBJECT LANDS

CONSULTANTS

NOT FOR CONSTRUCTION

SEAL

ASSOCIATION OF LANDSCAPE ARCHITECTS
TIM O'BRIEN
MEMBER

PRIME CONSULTANT
IBI GROUP
Suite 200 - 360 James Street North
Hamilton ON L8L 1H5 Canada
tel: 905 546 1010 fax: 905 546 1011
ibigroup.com

PROJECT
MONTROSE DEVELOPMENT

**6729 MONTROSE ROAD,
NIAGARA FALLS, ON**

PROJECT NO:
126319

DRAWN BY: LG
CHECKED BY: TO

PROJECT MGR: CA
APPROVED BY: TO

SHEET TITLE
LANDSCAPE PLAN
ENLARGEMENT I

SHEET NUMBER L2.0 **ISSUE** 1

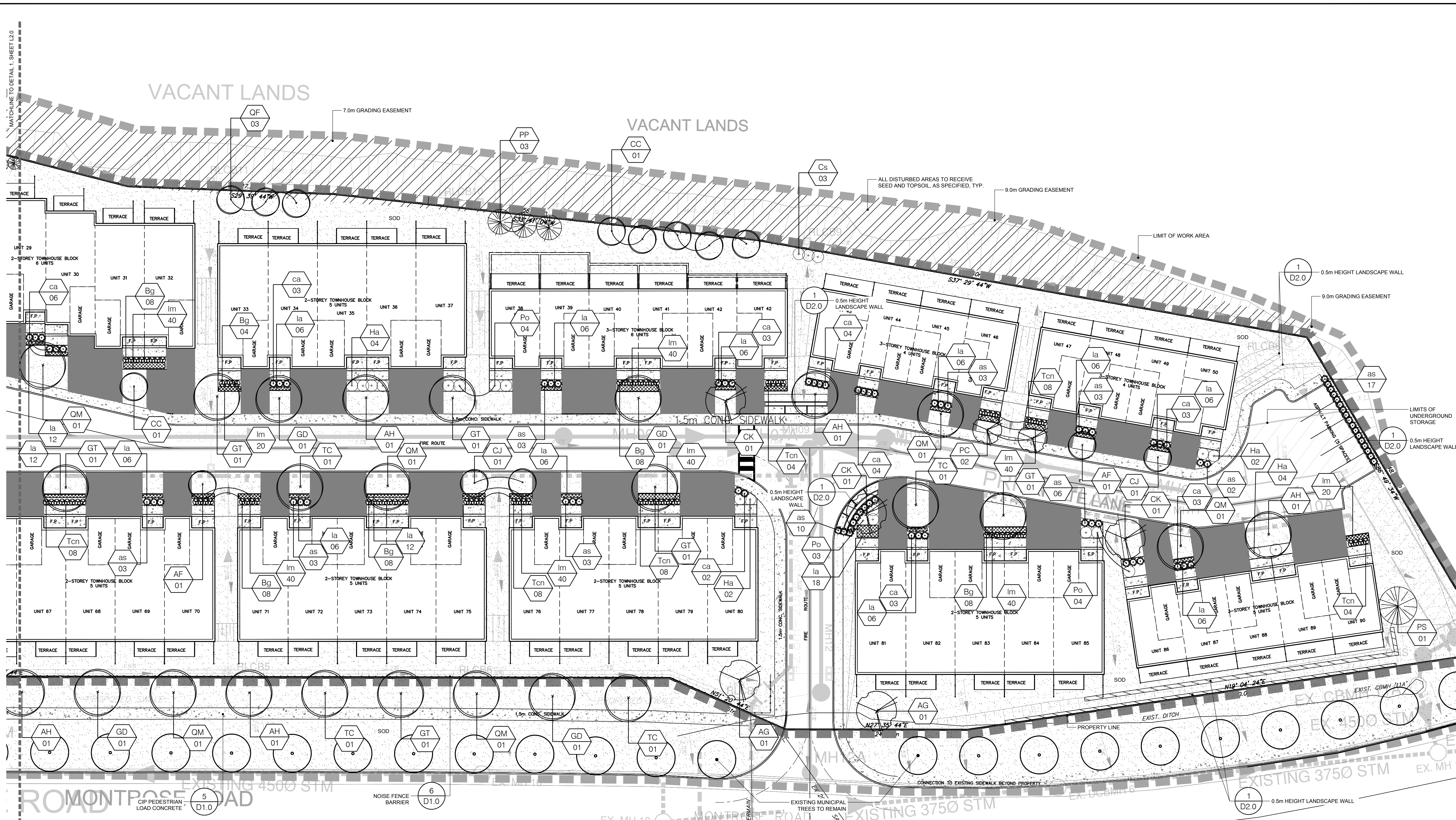

CLIENT
GEMINI CORP

6729 MONTROSE ROAD
 NIAGARA FALLS, ONTARIO

COPYRIGHT
 This drawing has been prepared solely for the intended use. Any reproduction or distribution for any purpose other than that authorized by IBI Group is forbidden. Written dimensions shall have precedence over scaled dimensions. Contractors shall verify and be responsible for all dimensions and conditions on the job, and IBI Group shall be informed of any variations from the dimensions and conditions shown on the drawing. Shop drawings shall be submitted to IBI Group for general conformance before proceeding with fabrication.

IBI Group Professional Services (Canada) Inc.
 is a member of the IBI Group of companies.

ISSUES

No.	DESCRIPTION	DATE
1	ISSUED FOR SPA	2023-04-04

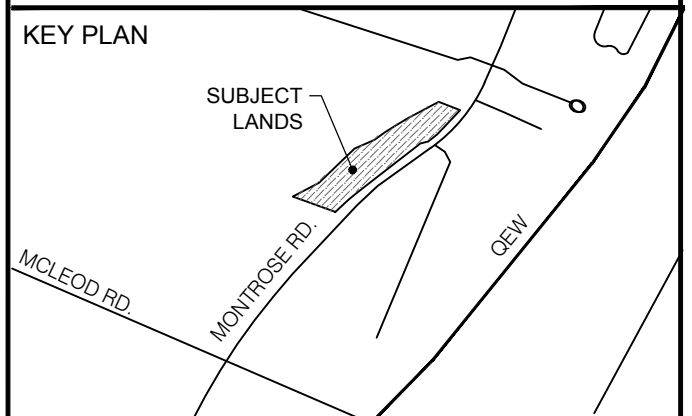

CONSULTANTS

NOT FOR CONSTRUCTION

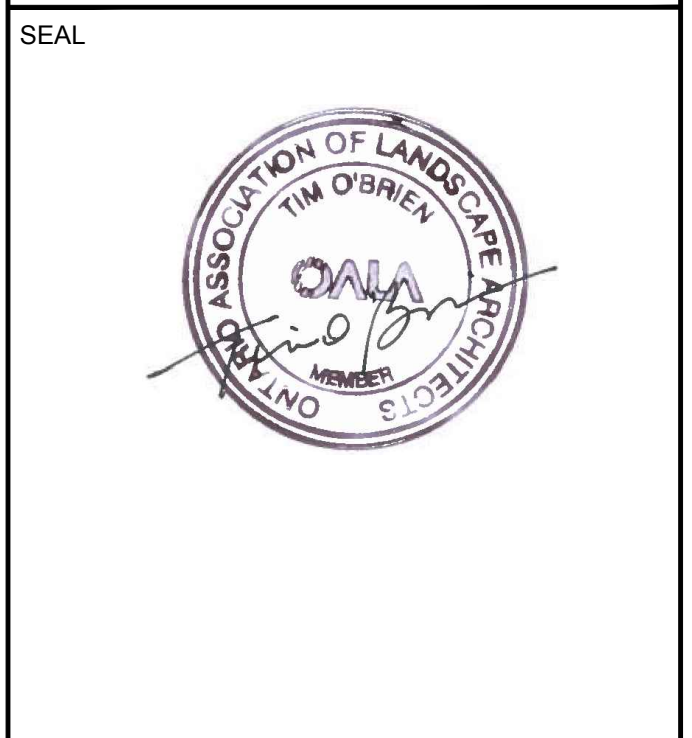

PRIME CONSULTANT

IBI GROUP
 Suite 200 - 360 James Street North
 Hamilton ON L8L 1H5 Canada
 tel: 905 546 1010 fax: 905 546 1011
 ibigroup.com

PROJECT
MONTROSE DEVELOPMENT

6729 MONTROSE ROAD,
 NIAGARA FALLS, ON

PROJECT NO:
126319

DRAWN BY:
LG

CHECKED BY:
TO

PROJECT MGR:
CA

APPROVED BY:
TO

SHEET TITLE
**LANDSCAPE PLAN
 ENLARGEMENT II**

SHEET NUMBER
L3.0

ISSUE
1

LEGEND

	TOPSOIL AND SOD AS SPECIFIED MINIMUM 150mm TOPSOIL DEPTH		PROPOSED DECIDUOUS ORNAMENTAL TREE
	TOPSOIL AND SEED AS SPECIFIED MINIMUM 150mm TOPSOIL DEPTH		PROPOSED DECIDUOUS SHRUBS
	CONCRETE PAVING		PROPOSED BROAD-LEAF EVERGREEN SHRUBS
	EXISTING DECIDUOUS TREE TO REMAIN		PROPOSED PERENNIALS
	PROPOSED DECIDUOUS SHADE TREE		PROPOSED ORNAMENTAL GRASSES
	PROPOSED CONIFEROUS TREE		1.8M NOISE BARRIER FENCE. SEE DETAIL 6/D1.0
			PLANT SPECIES QUANTITY
			DETAIL NUMBER SHEET NUMBER

PROPOSED PLANTING SCHEDULE - L3.0

KEY	BOTANICAL NAME	COMMON NAME	CAL.	COND.	MATURE HEIGHT (m)	MATURE SPREAD (m)	O.C. SPACING (m)	QNTY.
DECIDUOUS TREES								
AF	<i>Acer x freemanii</i> 'Armstrong'	Armstrong Freeman Maple	60 mm	W.B.	16.0	6.0	6.0	3
AH	<i>Aesculus hippocastanum</i>	Horsechestnut	60 mm	W.B.	18.0	15.0	10.0	4
CC	<i>Cercis canadensis</i>	Eastern Redbud	60 mm	W.B.	10.0	7.0	6.0	6
CJ	<i>Cercidiphyllum japonicum</i>	Katsura	60 mm	W.B.	15.0	5.0	5.0	3
GD	<i>Gymnocladus dioica</i>	Kentucky Coffee Tree	60 mm	W.B.	17.0	13.0	10.0	4
GT	<i>Gleditsia triacanthos</i> var. <i>inermis</i>	Thornless Honey Locust	60 mm	W.B.	17.0	12.0	10.0	6
QF	<i>Quercus robur</i> 'Fastigiata'	English Columnar Oak	60 mm	W.B.	16.0	6.0	6.0	3
QM	<i>Quercus macrocarpa</i>	Bur Oak	60 mm	W.B.	20.0	13.0	10.0	6
TC	<i>Tilia cordata</i>	Littleleaf Linden	60 mm	W.B.	21.0	12.0	10.0	4
								TOTAL 39
CONIFEROUS TREES								
PP	<i>Picea pungens</i>	Blue Spruce	250cm	W.B.	18.0	6.0	6.0	3
PS	<i>Pinus strobus</i>	Eastern White Pine	250cm	W.B.	20.0	8.0	7.0	1
								TOTAL 4

KEY	BOTANICAL NAME	COMMON NAME	CAL.	COND.	MATURE HEIGHT (m)	MATURE SPREAD (m)	O.C. SPACING (m)	QNTY.
ORNAMENTAL TREES								
AG	<i>Acer griseum</i>	Paperbark Maple	Clump	175 cm	W.B.	6.0	5.0	6.0
CK	<i>Cornus kousa</i> 'Milky Way'	Milky Way Dogwood	Clump	175 cm	W.B.	6.0	6.0	3
PC	<i>Pyrus calleryana</i> 'Chanticleer'	Callery Pear	60 mm	W.B.	10.0	4.0	4.0	2
								TOTAL 7
SHRUBS								
Bg	<i>Buxus x Green Velvet</i>	Green Velvet Boxwood	50 cm	3 gal	0.8	0.8	0.7	44
Cs	<i>Cornus sericea</i>	Red Osier Dogwood	50 cm	3 gal	1.75	2.0	1.2	3
Ha	<i>Hydrangea arborescens</i> 'Annabelle'	Annabelle Smooth Hydrangea	50 cm	3 gal	1.5	1.5	1.2	12
Po	<i>Physocarpus opulifolius</i> 'Diabolo'	Diabolo Ninebark	50 cm	3 gal	1.75	1.5	1.2	11
Tcn	<i>Taxus canadensis</i>	Canadian Yew	50 cm	3 gal	0.6	0.8	0.7	40
								TOTAL 110
PERENNIALS								
as	<i>Andropogon scoparius</i> /Schizachyrium scoparium	Little Bluestem	1 gal	0.9	1.0	1.0	53	
ca	<i>Calamagrostis x acutifolia</i> 'Karl Foerster'	Feather Reed Grass	1 gal	1.2	1.0	1.0	31	
la	<i>Lavandula angustifolia</i> 'Buena Vista'	English lavender	1 gal	0.5	0.5	0.5	109	
lm	<i>Liriope muscari</i> 'Variegata'	Variegated Lily Turf	1 gal	0.5	0.3	0.2	320	
								TOTAL 513

SEED MIX:
 CONTRACTOR TO SOW NURSE CROP AVENA SATIVA OVER ENTIRE AREA.
 TO BE SEED AT A RATE OF 25kg/HECTARE
 8145 - RURAL ONTARIO ROADSIDE MIXTURE BY OSC SEEDS. TO BE SEED AT A RATE OF 25KG PER HA. SEED MIX TO INCLUDE:

Black Eyed Susan (<i>Rudbeckia hirta</i>)	2%
Blue Vervain (<i>Verbena hastata</i>)	2%
Bonset (<i>Eupatorium perfoliatum</i>)	1%
Canada Wild Rye (<i>Elymus canadensis</i>)	24%
Dense Blazing Star (<i>Liatris spicata</i>)	1%
Foxglove/Beard Tongue (<i>Penstemon digitalis</i>)	2%
Indian grass (<i>Sorghastrum nutans</i>)	20%
Little Blue Stem (<i>Schizachyrium scoparium</i>)	20%
New England Aster (<i>Aster novae-angliae</i>)	2%
Showy Tick Trefoil (<i>Desmodium canadense</i>)	3%
Virginia Wild Rye (<i>Elymus virgatum</i>)	22%
Wild Bergamot (<i>Monarda fistulosa</i>)	1%

True North
 Project North

SCALE CHECK

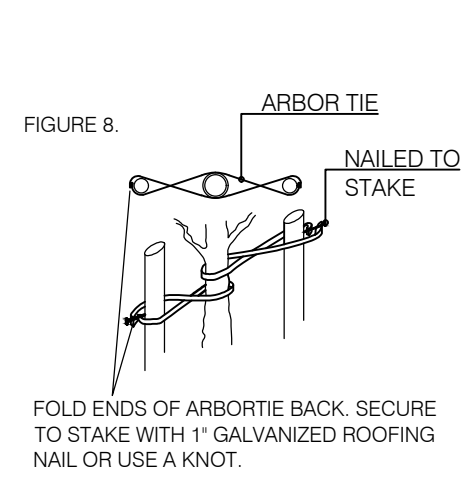

- NOTES:**
- OBTAIN WRITTEN CONFIRMATION OF UTILITY LOCATES PRIOR TO COMMENCEMENT OF DIGGING
 - DIG ALL HOLES BY HAND WHEN CLOSER THAN 1.0M TO UNDERGROUND POWER, TELEPHONE AND GAS ALIGNMENTS
 - USE ROOT DEFLECTOR ON THE UTILITY SIDE OF REQUIRED
 - ENSURE BASE OF TREE PIT IS STABLE IN ORDER TO MAINTAIN THE DESIRED TREE LEVEL AND GRADE
 - TREES TO BE SPRAYED WITH APPROVED ANTI-DESSICANT PRIOR TO TRANSPORTING UNLESS PLANTED WITHIN 48 HOURS OF DIGGING (IF PLANTED IN FULL LEAF)
 - SET TREE 50mm HIGHER THAN SURROUNDING GRADE TO ALLOW FOR SETTLEMENT
 - SCARIFY COMPACTED SUBGRADE TO 500MM DEEP IN AREA 5 X ROOTBALL DIAMETER
 - DIG PIT 300MM WIDER THAN ROOTBALL PERIMETER
 - MULCH WITH SHREDDED BARK OR COMPOSTED HARDWOOD CHIPS
 - TRUNK PROTECTION:
 - MECHANICAL INJURY: USE PLASTIC TREE COLLAR
 - ANIMAL INJURY: USE SPIRAL TREE GUARDS OR SCREEN COLLARS
 - SUNSCALD INJURY: PAINT TRUNK WITH WHITE LATEX OR WHITE WASH, OR WRAP WITH BURLAP, KRAFT WRAP INSTALLED FROM THE GROUND UP TO ABOVE LOWEST BRANCHES
 - LAWN MOWER INJURY: USE SPLIT CORRUGATED BRAIN COLLARS
 - REMOVE TREE STAKES AND TREE WRAP AFTER ONE SEASON

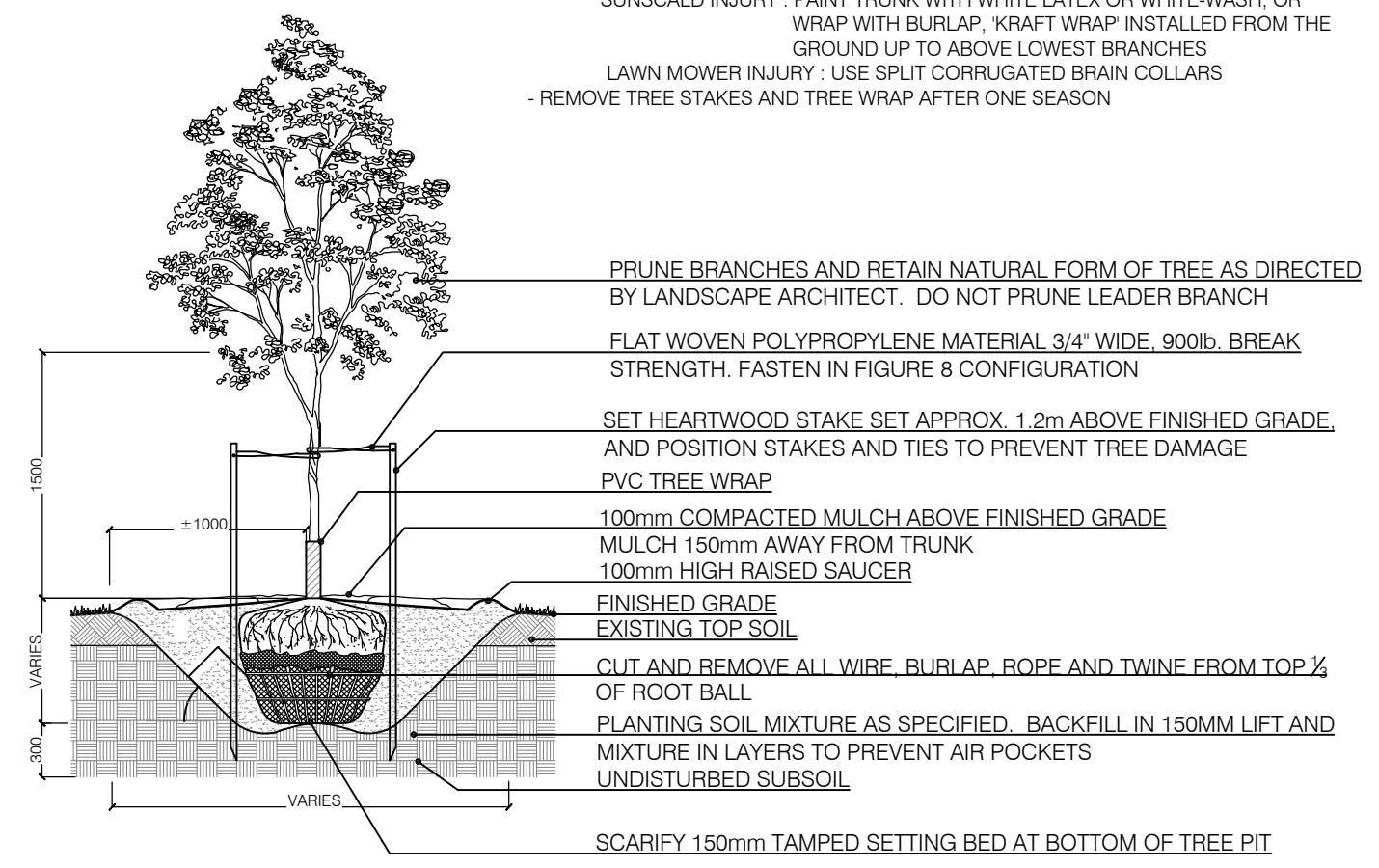

1 BALLED & BURLAPPED/WIRE BASKET DECIDUOUS TREE
D1.0 N.T.S.

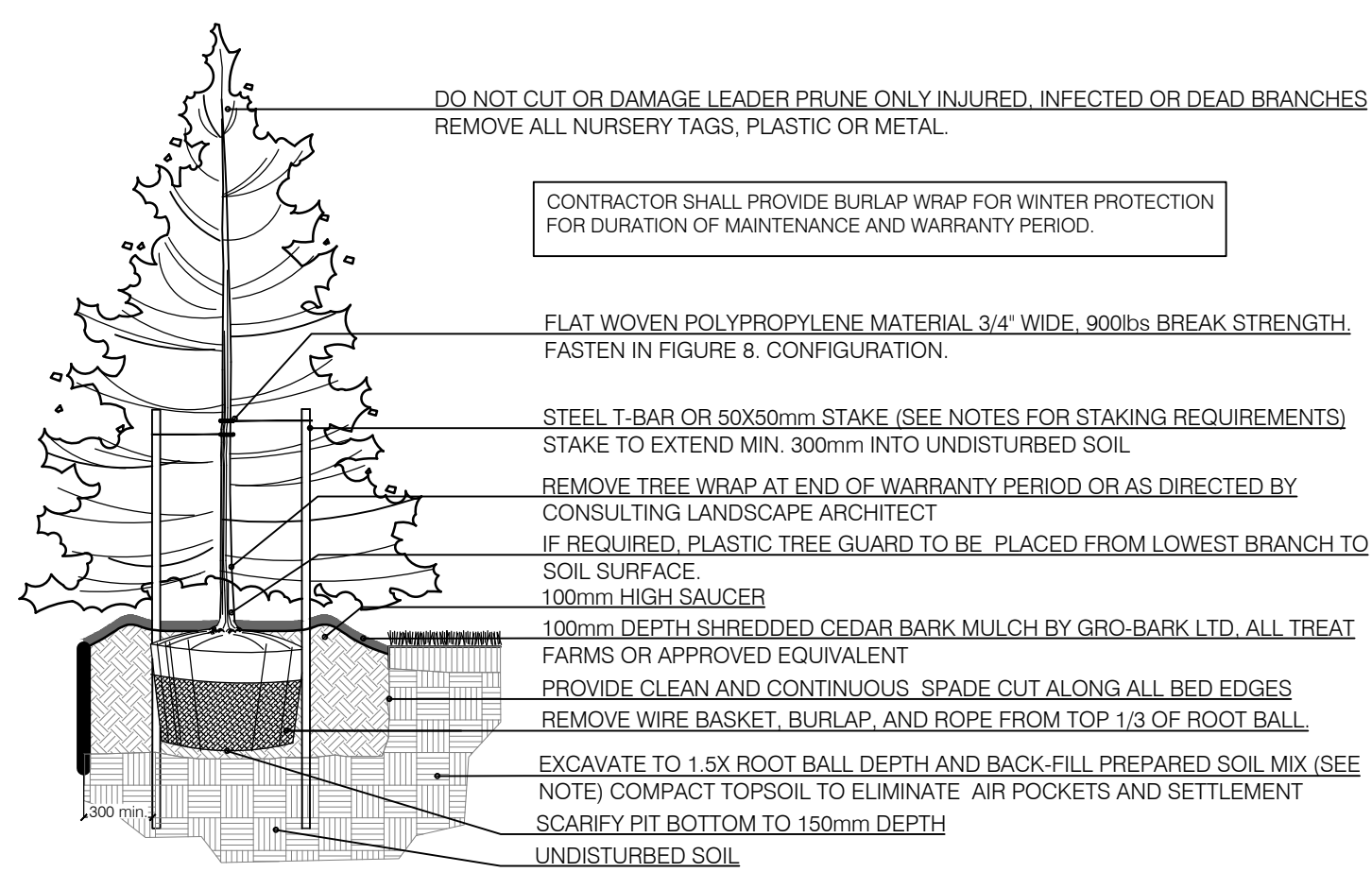

- NOTES:**
- SOIL MIXTURE: FOUR (4) PARTS NATIVE SOIL, ONE (1) PART WELL ROTTED COMPOST.
 - SAUCER SHALL BE SOAKED WITH WATER AND MULCHED IMMEDIATELY FOLLOWING PLANTING
 - ALL DIMENSIONS ARE IN mm.
 - STAKING SCHEDULE:
 - < 2500mm HT - ONE STAKE
 - > 2500mm HT - TWO STAKES
 - SPADED TREES: THREE STAKES OR GUY WIRES
 - ALL SUPPORT SYSTEMS MUST BE REMOVED ONCE TREE IS ESTABLISHED.
 - ALL TREES TO BE STRAIGHT AND PLANTED VERTICALLY REGARDLESS OF SLOPE.
 - TOP OF ROOT FLARE SHALL BE POSITIONED 50mm ABOVE GRADE.

2 BALLED & BURLAPPED/WIRE BASKET CONIFEROUS TREE
D1.0 N.T.S.

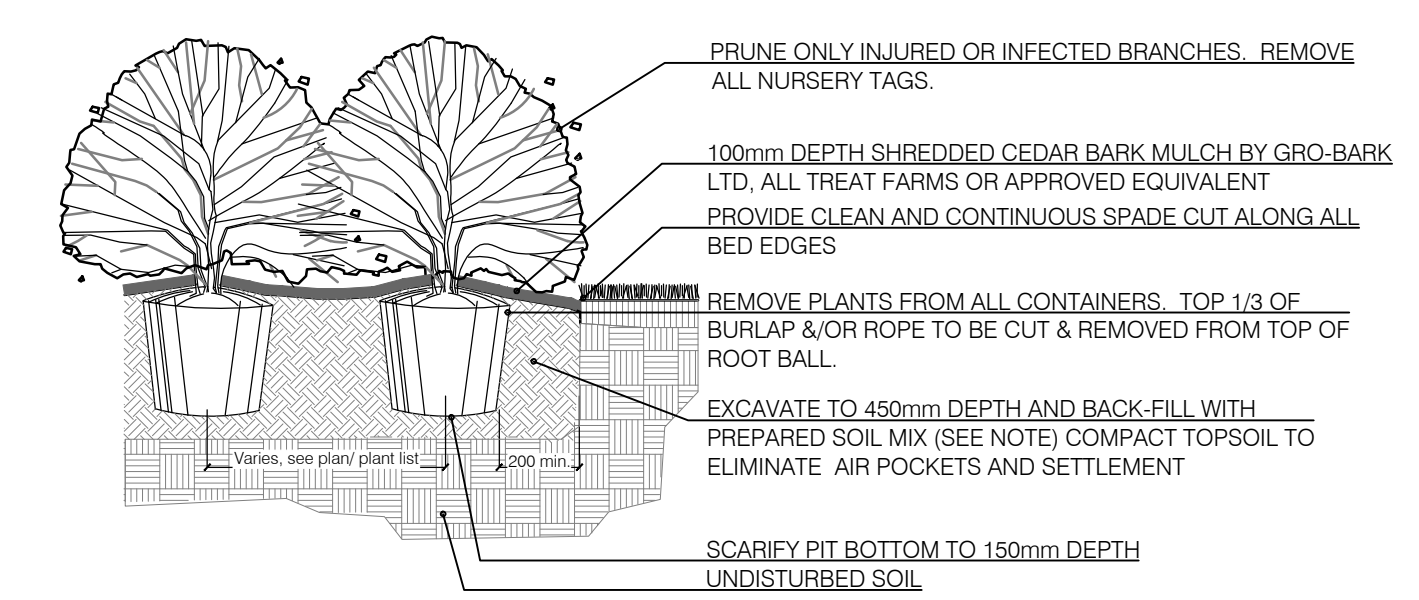

- NOTES:**
- SOIL MIXTURE: FOUR (4) PARTS NATIVE SOIL, ONE (1) PART WELL ROTTED COMPOST.
 - SAUCER SHALL BE SOAKED WITH WATER AND MULCHED IMMEDIATELY FOLLOWING PLANTING.
 - ALL DIMENSIONS ARE IN mm.
 - IN POORLY DRAINED SOILS PLANT SHRUB SLIGHTLY HIGHER THAN ADJACENT GRADE.
 - ALL PLANTS TO BE STRAIGHT AND PLANTED VERTICALLY REGARDLESS OF SLOPE.

3 BALLED AND BURLAPPED/POTTED SHRUB
D1.0 N.T.S.

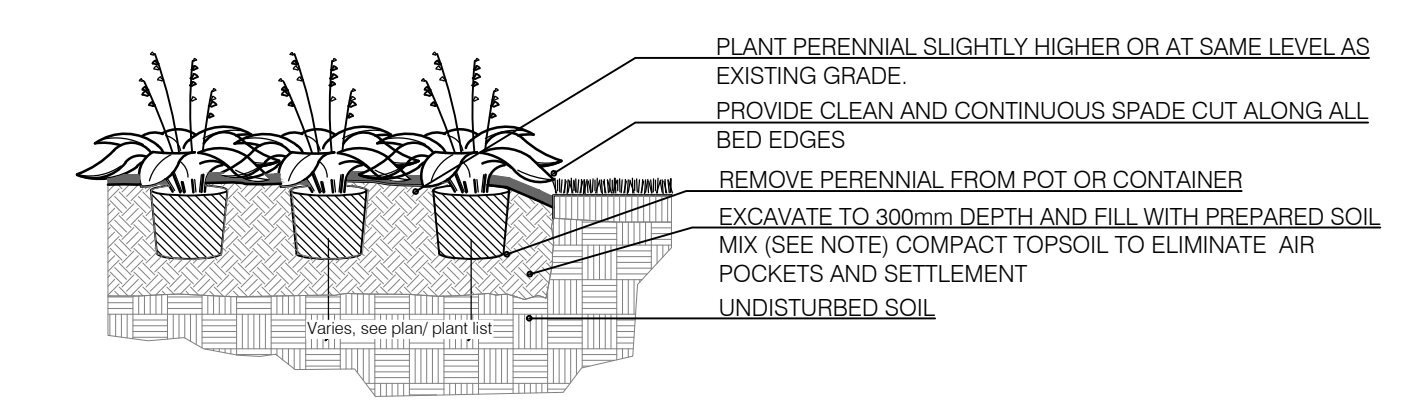

- NOTES:**
- SOIL MIXTURE: FOUR (4) PARTS NATIVE SOIL, ONE (1) PART WELL ROTTED COMPOST
 - SAUCER SHALL BE SOAKED WITH WATER AND MULCHED IMMEDIATELY FOLLOWING PLANTING.
 - ALL DIMENSIONS ARE IN mm
 - CUT AND REMOVE CONTAINER. SCARIFY ROOTBALL SIDES.
 - ALL PLANTS TO BE STRAIGHT AND PLANTED VERTICALLY REGARDLESS OF SLOPE.
- CONTRACTOR SHALL PROVIDE 75mm MULCH FOR ALL PERENNIALS EXCEPT GROUNDCOVERS UNLESS SPECIFIED OTHERWISE.

4 CONTAINER GROWN PERENNIAL/GRASS
D1.0 N.T.S.

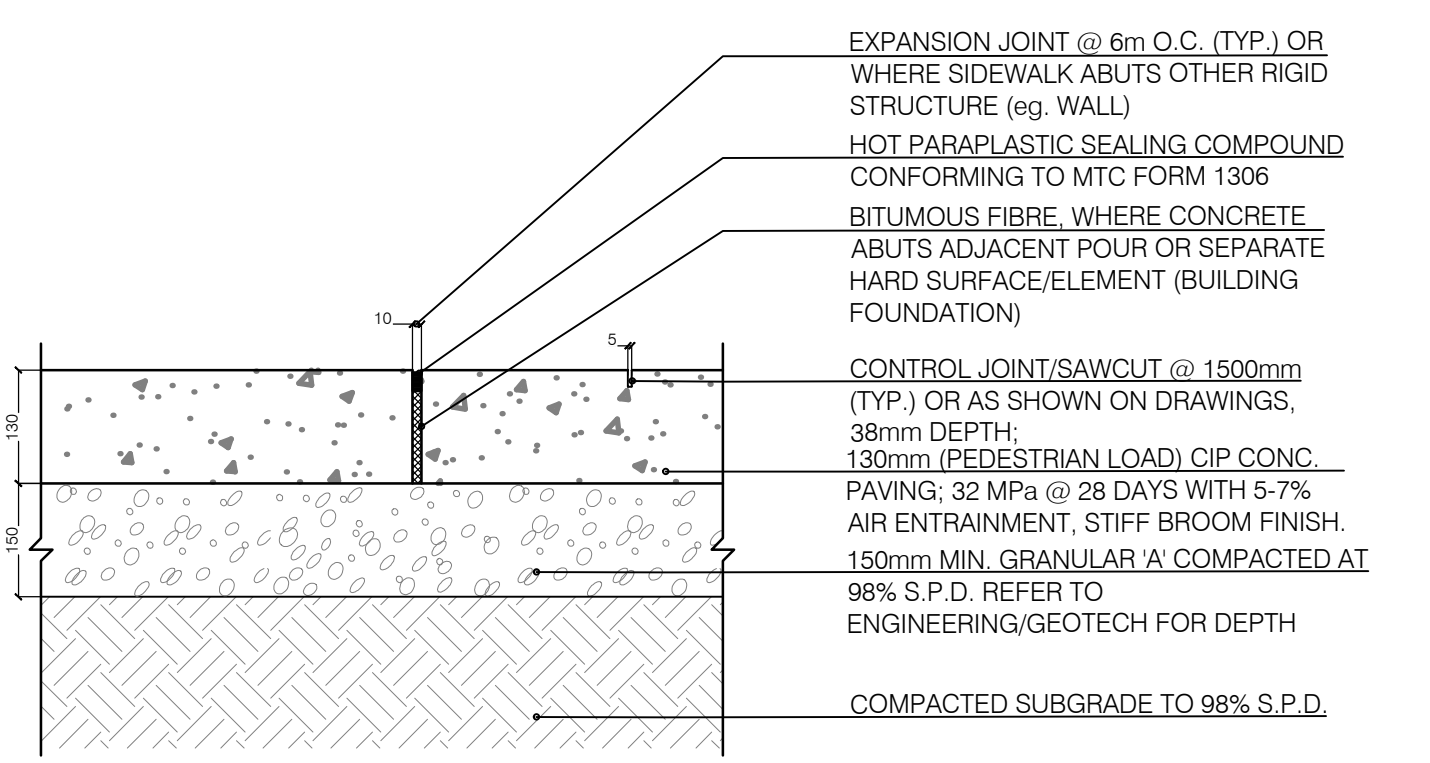

5 CIP PEDESTRIAN LOAD CONCRETE
D1.0 N.T.S.

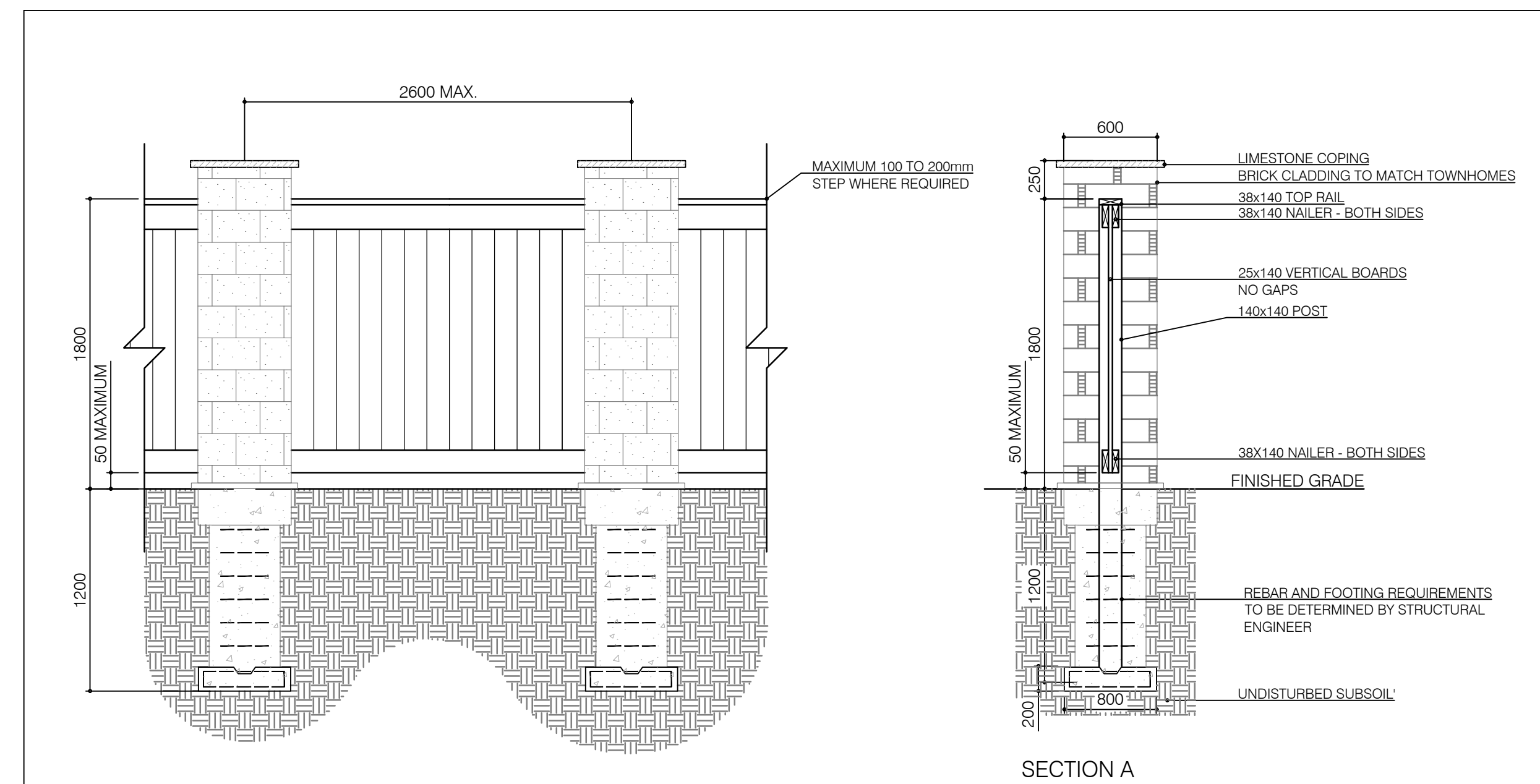

- NOTES:**
- CONTRACTOR TO SUBMIT STAMPED SHOP DRAWINGS FOR APPROVAL BY LANDSCAPE ARCHITECT & OWNER
 - ALL MATERIALS, COMPONENTS AND WORKMANSHIP TO CONFORM TO BUILDING AND LOCAL BY-LAWS
 - FENCING CONSTRUCTED ON BERMS:
 - A) EXTEND FOOTINGS 1500MM INTO UNDISTURBED SUB-GRADE.
 - ALL WOOD TO BE PRESSURE TREATED SELECTED MAINLY FOR GOOD APPEARANCE ALL MEMBERS SHALL BE FREE OF WANE AND BARK POCKETS. ALL TORN GRAIN SHALL BE ELIMINATED BY SANDING AND PLANNING. MEMBERS EXHIBITING MODERATE TO HEAVY KNOTS SHALL BE WELL DISTRIBUTED THROUGHOUT THE SITE
 - ALL WOOD TO BEAR LUMBER GRADING STAMP.
 - FASTENERS SHALL HAVE EXTERIOR GRADE FINISHES.
 - ALL GALVANIZING TO BE HOT DIPPED IN CONFORMANCE TO CSA STANDARD C164
 - DRIVE ALL FASTENER HEADS BELOW SURFACE OF WOOD. USE SUFFICIENT SIZE AND QUANTITY OF FASTENERS TO ENSURE A STABLE, SECURE STRUCTURE.
 - ALL LUMBER SIZES ARE ACTUAL SIZES RATHER THAN NOMINAL SIZES.
 - CONCRETE TO HAVE MINIMUM COMPRESSIVE STRENGTH OF 20 MPA @ 20 DAYS WITH 5-7% AIR ENTERTAINMENT.
 - SEE LANDSCAPE PLAN FOR NOISE BARRIER FENCE LOCATION.
 - ENSURE NO GAPS BETWEEN VERTICAL FENCE BOARDS.

NOTE: CONTRACTOR TO SUBMIT STAMPED SHOP DRAWINGS FOR APPROVAL BY LANDSCAPE ARCHITECT & OWNER

6 NOISE FENCE BARRIER
D1.0 N.T.S.

CLIENT
GEMINI CORP

6729 MONTROSE ROAD
NIAGARA FALLS, ONTARIO

COPYRIGHT
This drawing has been prepared solely for the intended use. Any reproduction or distribution for any purpose other than authorized by IBI Group is forbidden. Written dimensions shall have precedence over scaled dimensions. Contractors shall verify and be responsible for all dimensions and conditions on the job, and IBI Group shall be informed of any variations from the dimensions and conditions shown on the drawing. Shop drawings shall be submitted to IBI Group for general concurrence before proceeding with fabrication.

IBI Group Professional Services (Canada) Inc.
is a member of the IBI Group of companies.

ISSUES		
No.	DESCRIPTION	DATE
1	ISSUED FOR SPA	2023-04-04

CONSULTANTS

SEAL

PRIME CONSULTANT
IBI GROUP
Suite 200 - 360 James Street North
Hamilton ON L8L 1H5 Canada
tel: 905 546 1010 fax: 905 546 1011
ibigroup.com

PROJECT
MONTROSE DEVELOPMENT

6729 MONTROSE ROAD,
NIAGARA FALLS, ON

PROJECT NO:
126319

DRAWN BY: LG	CHECKED BY: TO
PROJECT MGR: CA	APPROVED BY: TO

SHEET TITLE
LANDSCAPE DETAILS

SHEET NUMBER D1.0	ISSUE 1
-----------------------------	-------------------

SCALE CHECK

NOT FOR CONSTRUCTION

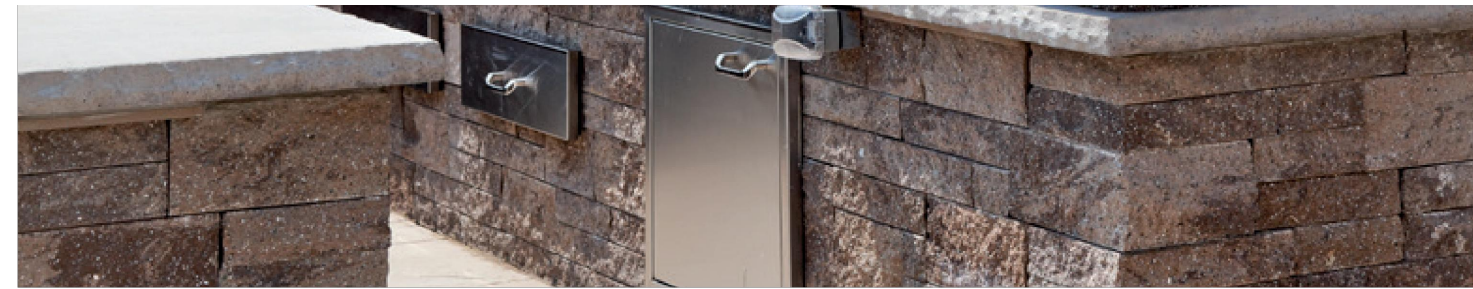

MINI-CRETA 3" ARCHITECTURAL

DESCRIPTION: Wall double-sided TEXTURE: Split face with straight edged corners

PALLET OVERVIEW

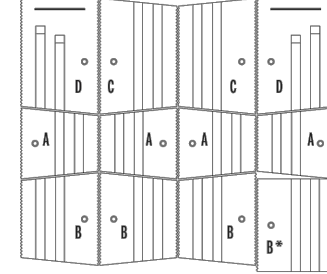

T **P** PATENT
 CN# 2,114,677
 US 5,529,873

COMPATIBLE CAPS

See page 140 for product compatibility.

NOTES

When building a double-sided wall one pallet will cover an average of 21.76 ft².

Unit can be used as a regular or vertical unit.

See page 135 to 156 for more technical information.

Specifications per pallet	Imperial	Metric
Cubing	24 ft ²	2.23 m ²
Approx. Weight	95.01 lin. ft	28.96 lin. m
Minimum radius	2 465 lbs	1 118 kg
Number of rows	7 ft	2.1 m
Coverage per row	8	
Linear coverage per row	3 ft ²	0.28 m ²
	11.88 lin. ft	3.62 lin. m

Unit dimensions	in	mm	Units/pallet
Height	2 15/16	75	32 units
Depth	9 13/16	250	
Length 1	9 1/16	230	24 units
Length 2	7 1/16	180	
Height	2 15/16	75	8 units
Depth	9 13/16	250	
Length 1	11 13/16	300	16 units
Length 2	11 13/16	300	
Height	2 15/16	75	16 units
Depth	9 13/16	250	
Length 1	14 3/4	375	8 right corners
Length 2	13 3/4	350	8 left corners



1 0.5m HEIGHT LANDSCAPE WALL
 D2.0 N.T.S.

INSTALLATION GUIDE

FREESTANDING WALLS - MINI-CRETA 3" AND 6"

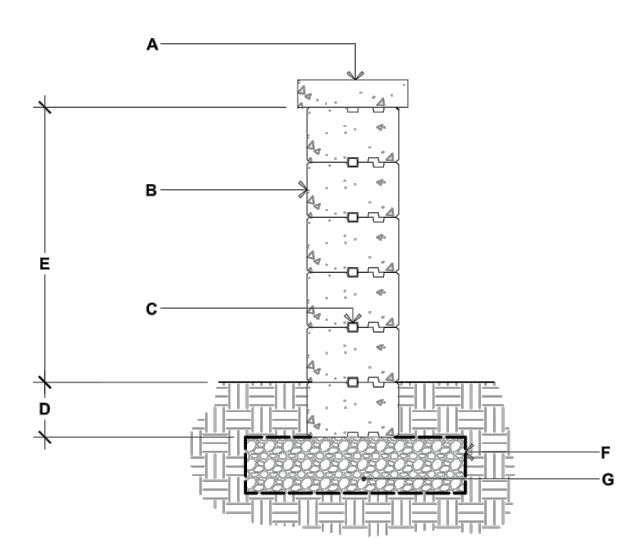

MINI-CRETA 3" & 6"

- TECHO-BLOC CAP UNIT SECURED TO UNIT BELOW WITH FLEXLOCK ADHESIVE
- MINI-CRETA 3" AND 6" DOUBLE-SIDED WALL UNITS SECURE EACH ROW WITH FLEXLOCK ADHESIVE
- CONNECTOR
- EMBEDMENT DEPTH, 6" (150 mm) MIN.
- 29 3/4" (750 mm) MAX.
- GEOTEXTILE
- COMPACTED GRANULAR LEVELING PAD, 6" (150 mm) THICK MIN. THICKNESS ACCORDING TO PROJECT SPECIFIC CONDITIONS

90° CORNER OF A DOUBLE-SIDED WALL

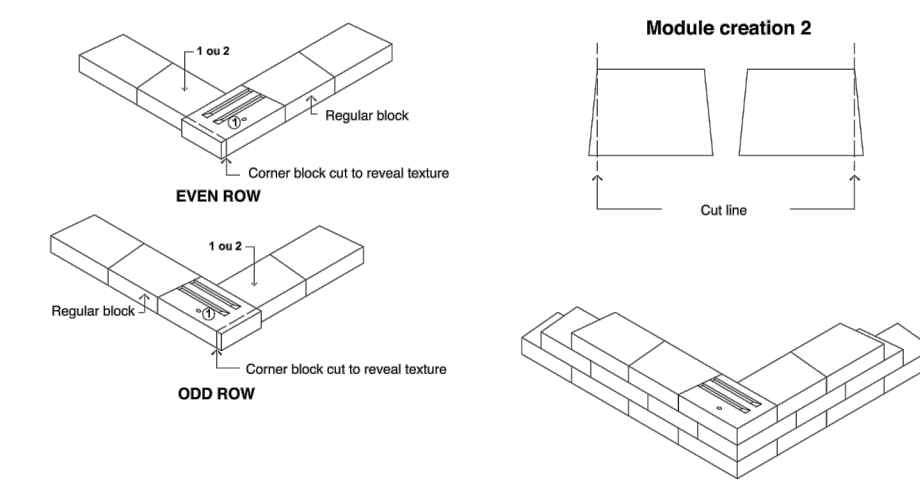

The corner block must be cut to reveal the texture

- Alternate odd and even rows.
- Stagger joints from one row to the next.
- Glue all modules at each row with Flexlock adhesive.
- Cavities, grooves and connectors are not illustrated to avoid overloading the image.
- It is possible to alternate the blocks (A, B or C) in the same row to create different patterns. However, a corner block must always be present at the end of a row and must be alternated for each subsequent row.

DOUBLE-SIDED WALL - END OF A STRAIGHT WALL

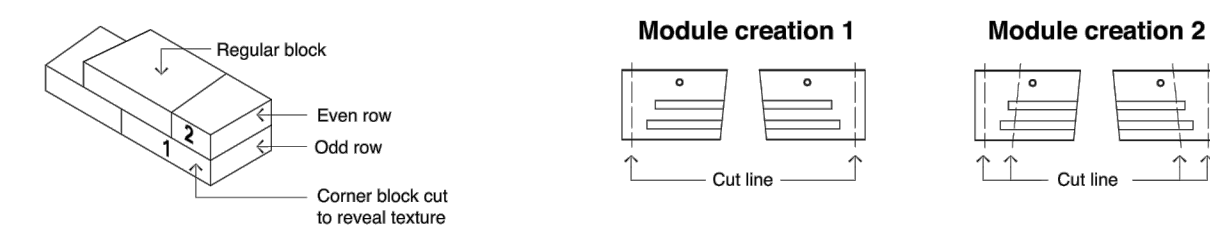

* It is possible to alternate the blocks (A, B or C) in the same row to create different patterns. However, a corner block must always be present at the end of a row and must be alternated for each subsequent row.

INSTALLATION GUIDE

DOUBLE-SIDED WALL RADIUS - MINI-CRETA 3" AND 6"

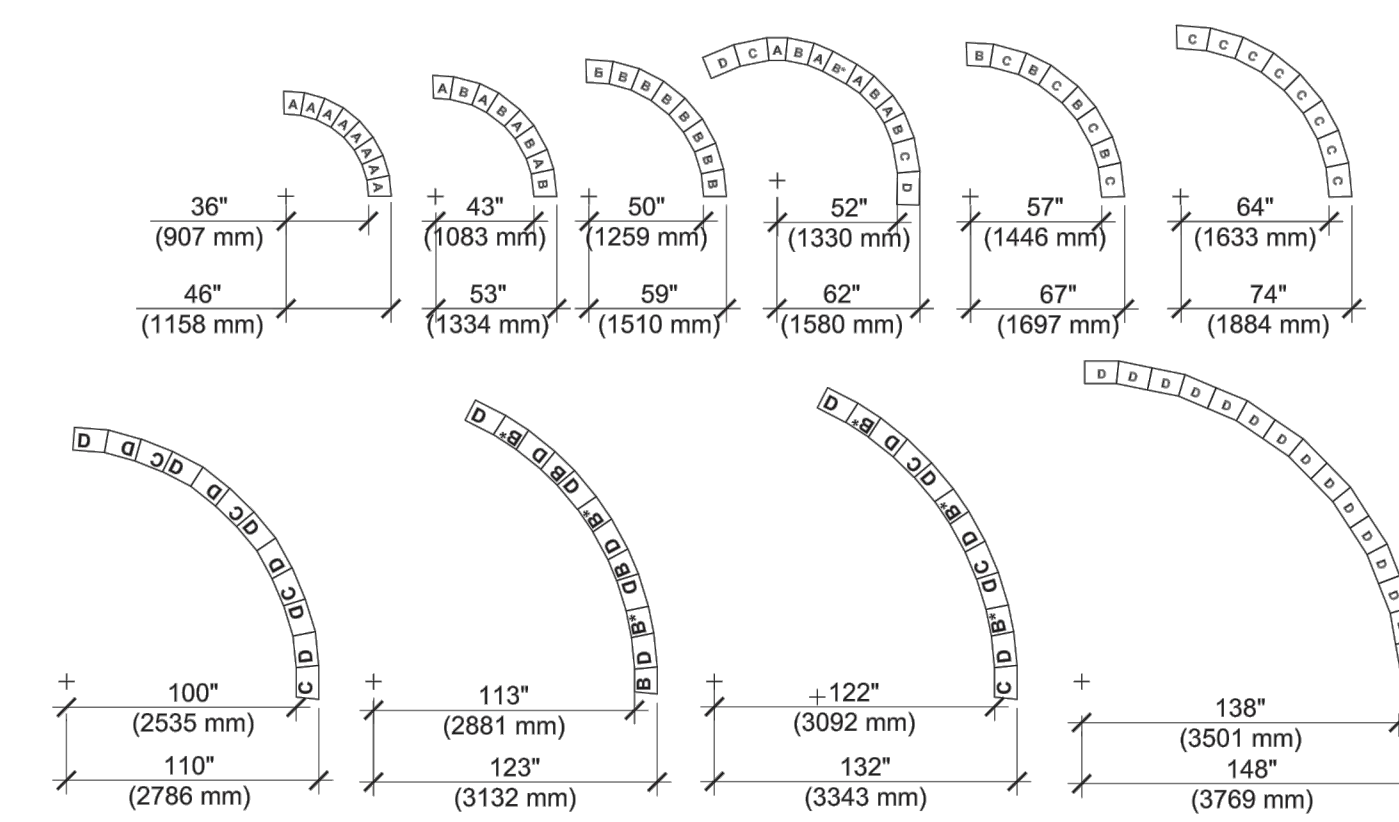

It is the user's responsibility to verify for the quantity of materials required.

WALL TO BE DESIGNED AS PER MANUFACTURER'S SPECIFICATIONS. STAMPED SHOP DRAWINGS TO BE SUBMITTED FOR REVIEW BY CIVIL & LANDSCAPE ARCHITECTS.

CLIENT
GEMINI CORP

6729 MONTROSE ROAD
 NIAGARA FALLS, ONTARIO

COPYRIGHT
 This drawing has been prepared solely for the intended use. This any reproduction or distribution for any purpose other than authorized by IBI Group is forbidden. Written dimensions shall have precedence over scaled dimensions. Contractors shall verify and be responsible for all dimensions and conditions on the job, and IBI Group shall be informed of any variations from the dimensions and conditions shown on the drawing. Shop drawings shall be submitted to IBI Group for general confirmation before proceeding with fabrication.
IBI Group Professional Services (Canada) Inc.
 is a member of the IBI Group of companies.

ISSUES	No.	DESCRIPTION	DATE
	1	ISSUED FOR SPA	2023-04-04

CONSULTANTS

NOT FOR CONSTRUCTION

SEAL

PRIME CONSULTANT
IBI GROUP
 Suite 200 - 360 James Street North
 Hamilton ON L8L 1H5 Canada
 tel 905 546 1010 fax 905 546 1011
 ibigroup.com

PROJECT
MONTROSE DEVELOPMENT
 6729 MONTROSE ROAD,
 NIAGARA FALLS, ON

PROJECT NO:
126319
 DRAWN BY: **LG** CHECKED BY: **TO**
 PROJECT MGR: **CA** APPROVED BY: **TO**

SHEET TITLE
LANDSCAPE DETAILS

SHEET NUMBER
D2.0 ISSUE
1