

**Legend**

- Limbs of the tree will be trimmed to allow for passage
- Possibility to relocate with a tree spade
- Resident may move tree, shrub or garden, otherwise it will be removed by the city
- Hard surface to be relocated by owner, if not city staff will relocate onto owners property

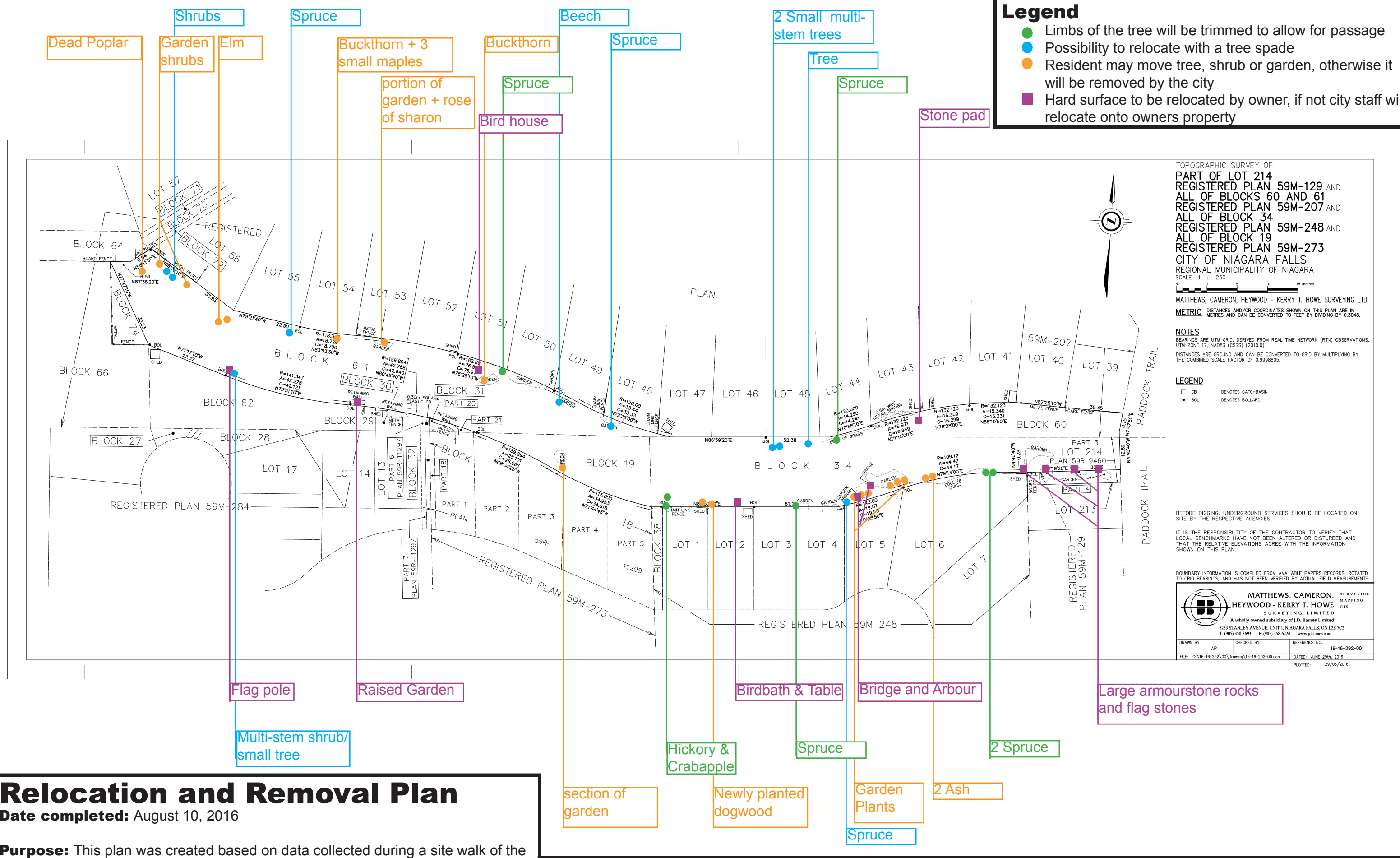

TOPOGRAPHIC SURVEY OF  
**PART OF LOT 214**  
**REGISTERED PLAN 59M-129 AND**  
**ALL OF BLOCKS 60 AND 61**  
**REGISTERED PLAN 59M-207 AND**  
**ALL OF BLOCK 34**  
**REGISTERED PLAN 59M-248 AND**  
**ALL OF BLOCK 19**  
**REGISTERED PLAN 59M-273**  
 CITY OF NIAGARA FALLS  
 REGIONAL MUNICIPALITY OF NIAGARA  
 SCALE 1 : 250

MATTHEWS, CAMERON, HEYWOOD - KERRY T. HOWE SURVEYING LTD.  
 METRIC DISTANCES AND/OR COORDINATES SHOWN ON THIS PLAN ARE IN METRES AND CAN BE CONVERTED TO FEET BY DIVIDING BY 0.3048.

**NOTES**  
 BEARINGS ARE UTM GRID, DERIVED FROM REAL TIME NETWORK (RTN) OBSERVATIONS, UTM ZONE 17, NAD83 (CSRS) (2010.0).  
 DISTANCES ARE GROUND AND CAN BE CONVERTED TO GRID BY MULTIPLYING BY THE COMBINED SCALE FACTOR OF 0.9998605.

**LEGEND**  
 □ CB DENOTES CATCHBASIN  
 ● BOL DENOTES BOLLARD

BEFORE DIGGING, UNDERGROUND SERVICES SHOULD BE LOCATED ON SITE BY THE RESPECTIVE AGENCIES.  
 IT IS THE RESPONSIBILITY OF THE CONTRACTOR TO VERIFY THAT LOCAL BENCHMARKS HAVE NOT BEEN ALTERED OR DISTURBED AND THAT THE RELATIVE ELEVATIONS AGREE WITH THE INFORMATION SHOWN ON THIS PLAN.

BOUNDARY INFORMATION IS COMPILED FROM AVAILABLE PAPERS RECORDS, ROTATED TO GRID BEARINGS, AND HAS NOT BEEN VERIFIED BY ACTUAL FIELD MEASUREMENTS.

**MATTHEWS, CAMERON, HEYWOOD - KERRY T. HOWE SURVEYING LTD.**  
 A wholly owned subsidiary of J.D. Bames Limited  
 5233 STANLEY AVENUE, UNIT 1, NIAGARA FALLS, ON L2E 7C2  
 T: (905) 358-3693 F: (905) 358-6224 www.jdbames.com

DRAWN BY: AP	CHECKED BY:	REFERENCE NO.: 16-16-292-00
FILE: G:\16-16-292\00\Drawing\16-16-292-00.dgn	DATED: JUNE 29th, 2016	PLOTTED: 29/06/2016

**Relocation and Removal Plan**

**Date completed:** August 10, 2016

**Purpose:** This plan was created based on data collected during a site walk of the maintenance buffer. Its purpose is to inventory any and all trees and hard surfaces that encroach on the marked maintenance buffer and propose solutions to each case as highlighted in the legend.

**Additional Notes:**

- Not all buckthorn is marked on this map; all buckthorn will be removed as it is an invasive species that will crowd out native trees that are to be planted on October 22nd on TD Tree Days