

FRONT YARD

- Means the yard between the front lotline and the nearest wall of the building

REAR YARD

- For the purpose of this By-law, means the remainder of the lot

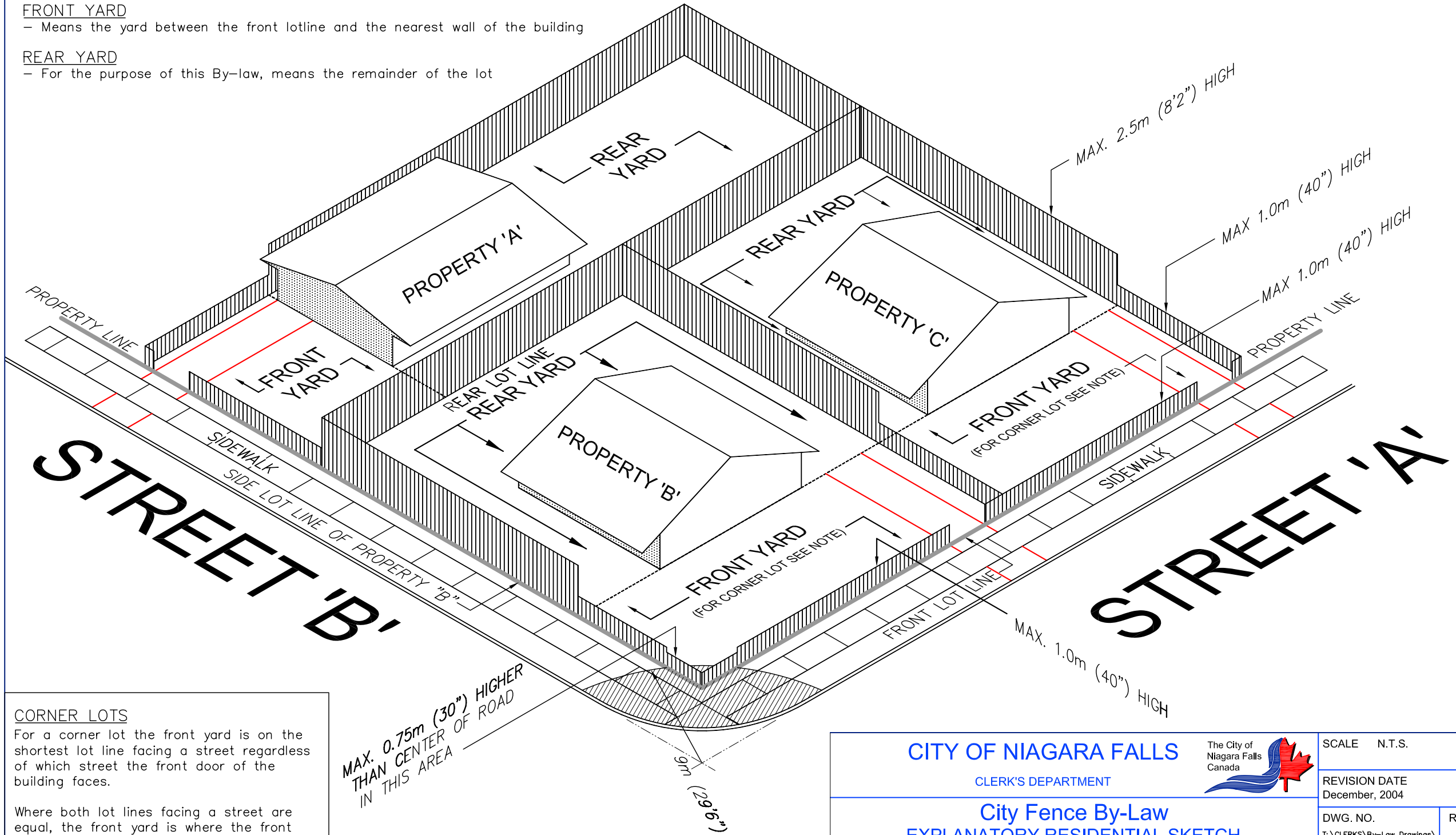

CORNER LOTS

For a corner lot the front yard is on the shortest lot line facing a street regardless of which street the front door of the building faces.

Where both lot lines facing a street are equal, the front yard is where the front door of the building faces.

MAX. 0.75m (30") HIGHER THAN CENTER OF ROAD IN THIS AREA

91m (296")

CITY OF NIAGARA FALLS

CLERK'S DEPARTMENT



SCALE N.T.S.

REVISION DATE
December, 2004

City Fence By-Law
EXPLANATORY RESIDENTIAL SKETCH

(NOTE: SKETCH APPLIES TO NEW RESIDENTIAL FENCES ONLY)

DWG. NO.

T:\CLERKS\By-Law Drawings\
fence detail.dwg

REV.

1